



Q3 / 2018

Product Information and Technical Drawings

Product range enlargement



Madrid

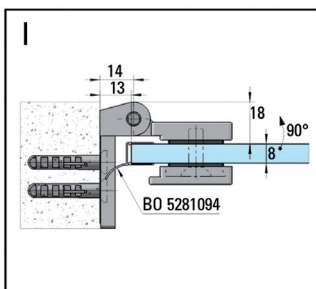

From page 2

Olis

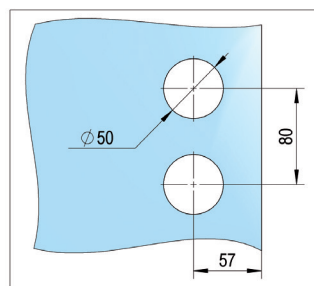

From page 6

Alea

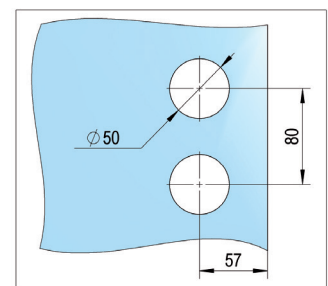

From page 12



Madrid

The Madrid series has been developed by Bohle and offers a visually appealing yet functional solution for any shower door. Conceived as a hinge for one-side opening doors, it enables use of a continuous sealing strip which can be fed through the fitting. No glass cutouts, only drill holes, are required in the glass for installation. Suitable for 8 mm to 10 mm tempered glass.



Madrid Shower Door Hinge glass/wall 90° opens outwards



FINISH

shiny chrome-plated

ART. NO.

BO 5215430

i Glass thickness 8, 10 mm · Elongated hole for wall mounting · No glass cut-outs - only drill holes are required · Continuous sealing strips can be used through the hinge · Max. door weight per pair 40 kg · Max. door height 2000 mm · Max. door width 1000 mm · Material brass

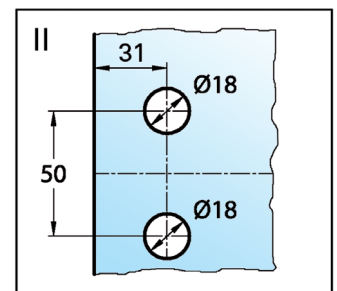
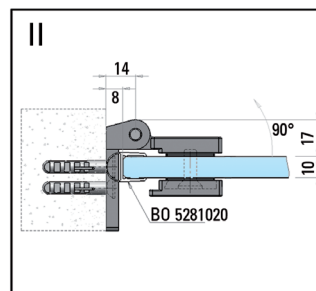
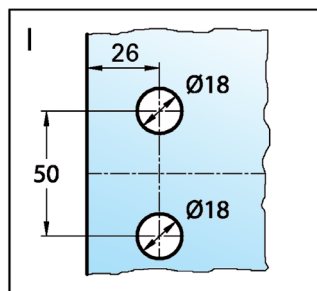
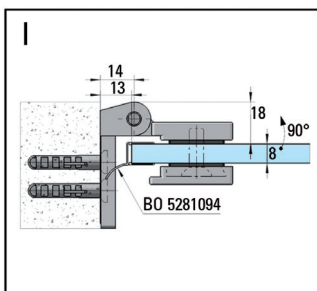
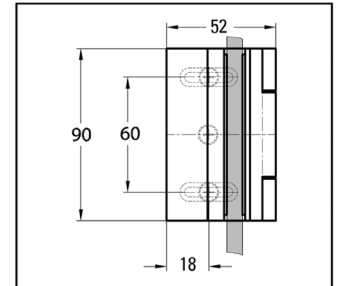
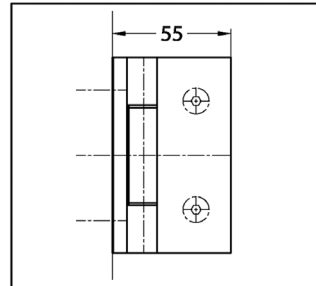

Madrid Shower Door Hinge glass/wall 90° opens outwards, with chamfer



FINISH

shiny chrome-plated

ART. NO.

BO 5215430H

i Glass thickness 8, 10 mm · With chamfer · Elongated hole for wall mounting · No glass cut-outs - only drill holes are required · Max. door weight per pair 40 kg · Max. door height 2000 mm · Max. door width 1000 mm · Material brass

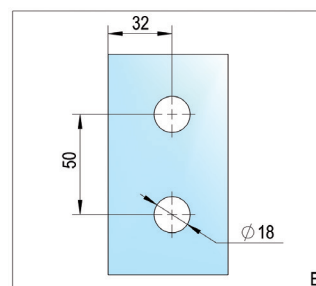
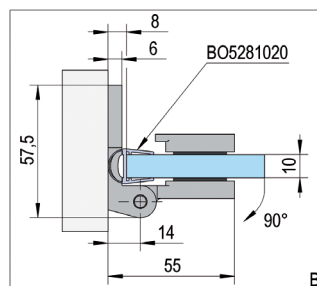
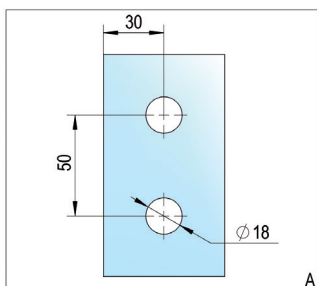
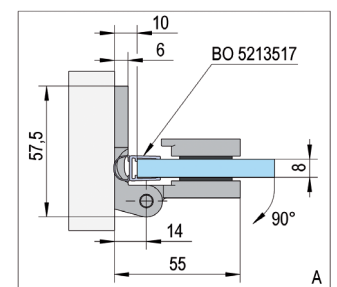
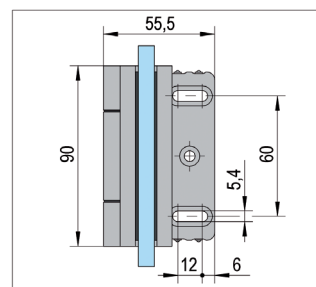

Madrid Shower Door Hinge glass/wall 90° opens inwards



FINISH

ART. NO.

shiny chrome-plated

BO 5215431

i Glass thickness 8, 10 mm · Elongated hole for wall mounting · No glass cut-outs - only drill holes are required · Max. door weight per pair 40 kg · Max. door height 2000 mm · Max. door width 1000 mm · Material brass

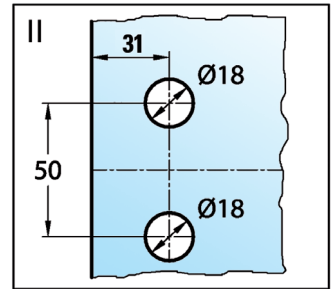
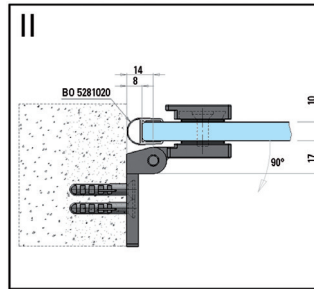
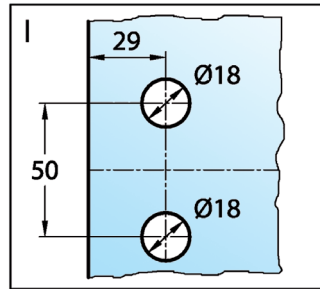
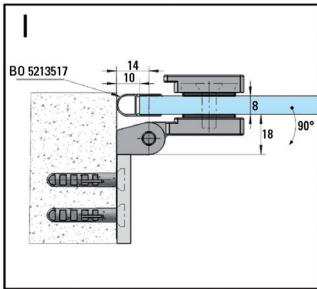
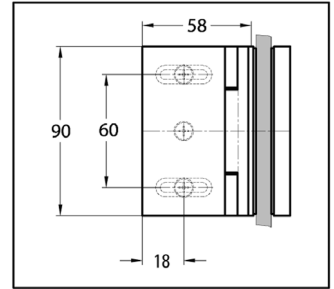
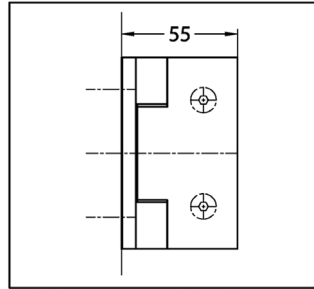

Madrid Shower Door Hinge glass/glass 180°



FINISH

ART. NO.

shiny chrome-plated

BO 5215432

i Glass thickness 8, 10 mm · No glass cut-outs - only drill holes are required · Max. door weight per pair 40 kg · Max. door height 2000 mm · Max. door width 1000 mm · Material brass

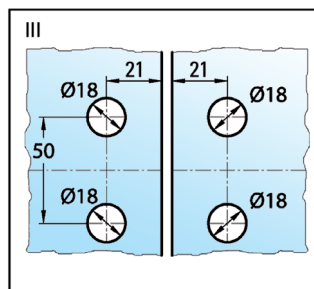
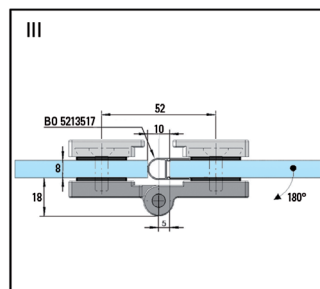
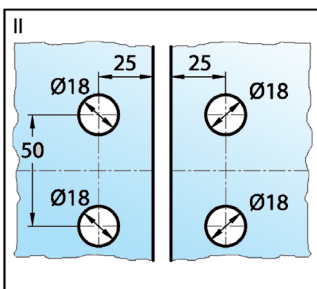
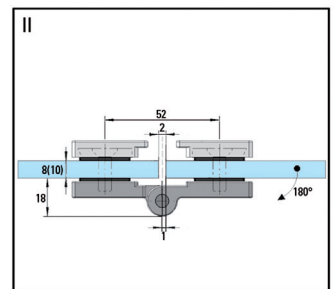
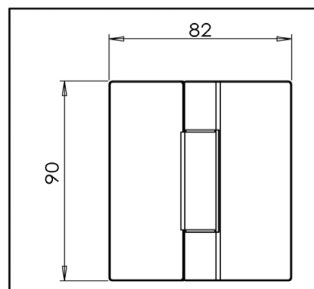

Madrid Corner Clamp glass/wall 90°

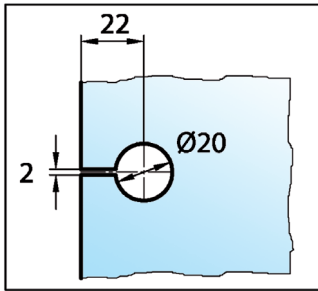

FINISH

shiny chrome-plated

ART. NO.

BO 5215433

① Glass thickness 8, 10 mm · Elongated hole for wall mounting · Material brass

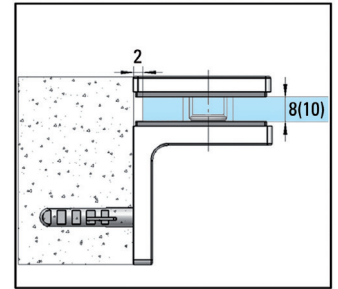
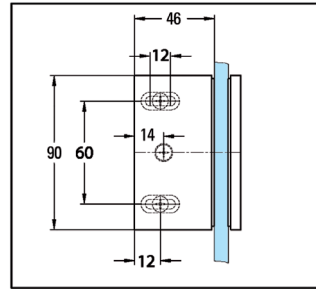

Madrid Corner Clamp glass/glass 90°

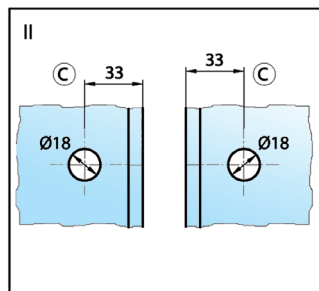
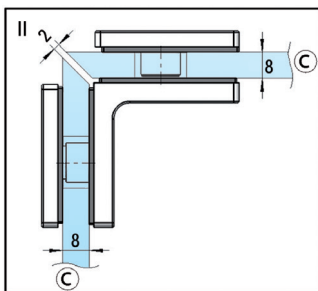

FINISH

shiny chrome-plated

ART. NO.

BO 5215434

① Glass thickness 8, 10 mm · Material brass

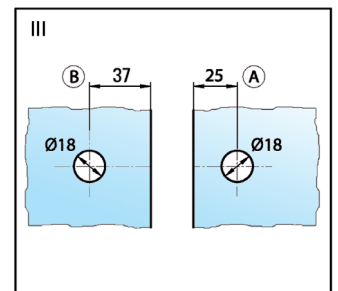
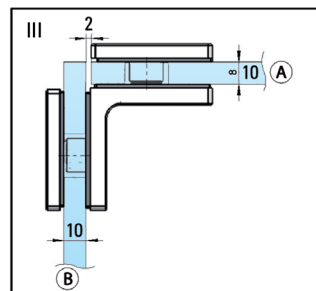
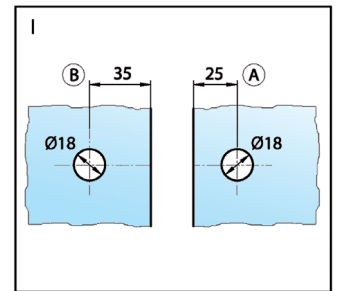
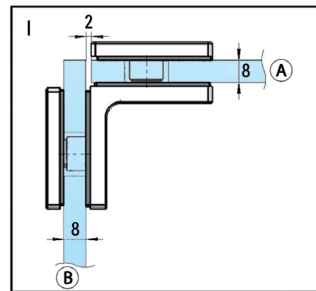



Olis and Alea

Thanks to their reliable and sturdy quality, the locks and door hinges of the Olis and Alea ranges are the ideal fit for project applications with high frequency use doors. They have been tested according to DIN EN 12209 and DIN EN 1670 and are equipped with a noise absorbing whisper latch. Suitable for 8 mm to 10 mm tempered glass and 8.76 to 10.76 mm laminated safety glass.

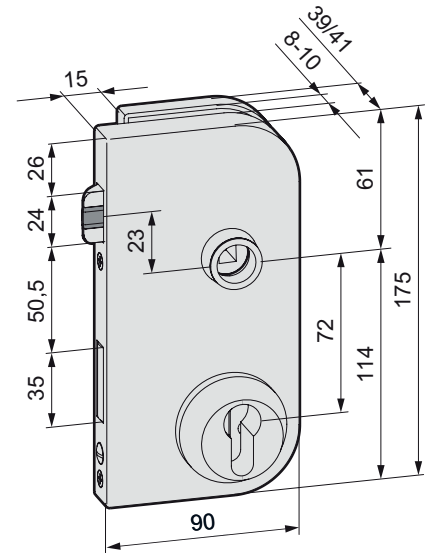

Dimensions of Olis glass door locks and keeps

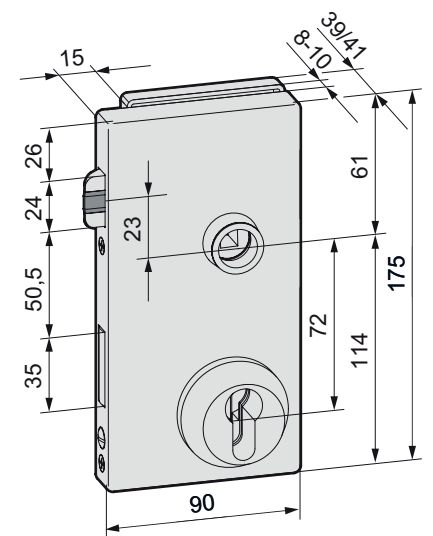

Dimensions of Alea glass door locks and keeps



Olis Glass Door Latch DIN left Non locking



FINISH	ART. NO.
aluminium-coloured E4/EV1	BO 5206860
stainless steel look E4/C31	BO 5206826

i Glass thickness tempered glass 8 - 10 mm, laminated glass 8.76 - 10.76 mm · Latch, non locking · Tested according to DIN EN 12209 (latch permanent test 500,000 cycles, bolt closing test 100,000 cycles) · Tested according to DIN EN 1670 (corrosion class 3) · For project applications with high frequency use doors · Rebate depth 24 mm (for 8 mm) / 26 mm (for 10 mm) · With noise absorbing whisper latch

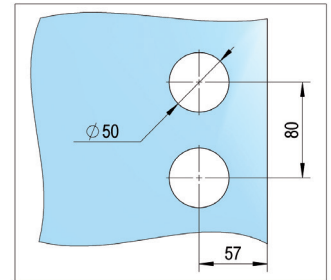

Olis Glass Door Latch DIN right Non locking



FINISH	ART. NO.
aluminium-coloured E4/EV1	BO 5206861
stainless steel look E4/C31	BO 5206828

i Glass thickness tempered glass 8 - 10 mm, laminated glass 8.76 - 10.76 mm · Latch, non locking · Tested according to DIN EN 12209 (latch permanent test 500,000 cycles, bolt closing test 100,000 cycles) · Tested according to DIN EN 1670 (corrosion class 3) · For project applications with high frequency use doors · Rebate depth 24 mm (for 8 mm) / 26 mm (for 10 mm) · With noise absorbing whisper latch

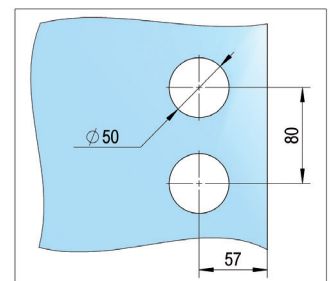

Olis Glass Door Lock DIN left Profile cylinder with rosette



FINISH	ART. NO.
aluminium-coloured E4/EV1	BO 5206857
stainless steel look E4/C31	BO 5206834

❗ Glass thickness tempered glass 8 - 10 mm, laminated glass 8.76 - 10.76 mm · Lock prepared for profile cylinder · Profile cylinder, 63 mm, for flush closure according to DIN 18257 · Tested according to DIN EN 12209 (latch permanent test 500,000 cycles, bolt closing test 100,000 cycles) · Tested according to DIN EN 1670 (corrosion class 3) · For project applications with high frequency use doors · Rebate depth 24 mm (for 8 mm) / 26 mm (for 10 mm) · Lock with noise absorbing whisper latch

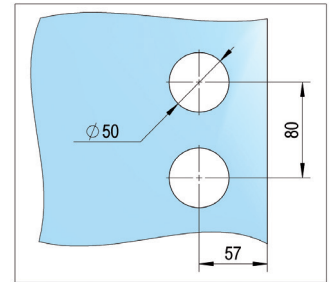

Olis Glass Door Lock DIN right Profile cylinder with rosette



FINISH	ART. NO.
aluminium-coloured E4/EV1	BO 5206856
stainless steel look E4/C31	BO 5206836

❗ Glass thickness tempered glass 8 - 10 mm, laminated glass 8.76 - 10.76 mm · Lock prepared for profile cylinder · Profile cylinder, 63 mm, for flush closure according to DIN 18257 · Tested according to DIN EN 12209 (latch permanent test 500,000 cycles, bolt closing test 100,000 cycles) · Tested according to DIN EN 1670 (corrosion class 3) · For project applications with high frequency use doors · Rebate depth 24 mm (for 8 mm) / 26 mm (for 10 mm) · Lock with noise absorbing whisper latch

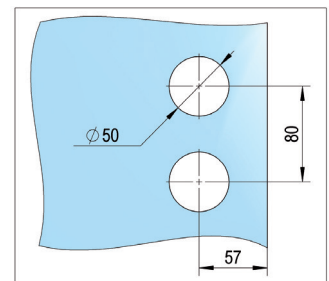

Olis Glass Door Lock DIN left Profile Cylinder



FINISH	ART. NO.
aluminium-coloured E4/EV1	BO 5206864
stainless steel look E4/C31	BO 5206868

❗ Glass thickness tempered glass 8 - 10 mm, laminated glass 8.76 - 10.76 mm · Lock prepared for profile cylinder · Tested according to DIN EN 12209 (latch permanent test 500,000 cycles, bolt closing test 100,000 cycles) · Tested according to DIN EN 1670 (corrosion class 3) · For project applications with high frequency use doors · Rebate depth 24 mm (for 8 mm) / 26 mm (for 10 mm) · Lock with noise absorbing whisper latch

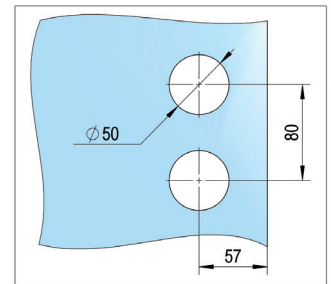

Olis Glass Door Lock DIN right Profile Cylinder



FINISH	ART. NO.
aluminium-coloured E4/EV1	BO 5206865
stainless steel look E4/C31	BO 5206869

❗ Glass thickness tempered glass 8 - 10 mm, laminated glass 8.76 - 10.76 mm · Lock prepared for profile cylinder · Tested according to DIN EN 12209 (latch permanent test 500,000 cycles, bolt closing test 100,000 cycles) · Tested according to DIN EN 1670 (corrosion class 3) · For project applications with high frequency use doors · Rebate depth 24 mm (for 8 mm) / 26 mm (for 10 mm) · Lock with noise absorbing whisper latch

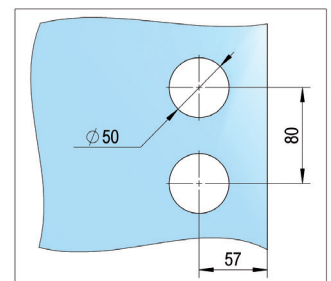

Olis Glass Door Thumb-turn Lock DIN left



FINISH	ART. NO.
aluminium-coloured E4/EV1	BO 5206866
stainless steel look E4/C31	BO 5206870

i Glass thickness tempered glass 8 - 10 mm, laminated glass 8.76 - 10.76 mm · Lock with control knob and “red/white” indicator · Tested according to DIN EN 12209 (latch permanent test 500,000 cycles, bolt closing test 100,000 cycles) · Tested according to DIN EN 1670 (corrosion class 3) · For project applications with high frequency use doors · Rebate depth 24 mm (for 8 mm) / 26 mm (for 10 mm) · Lock with noise absorbing whisper latch

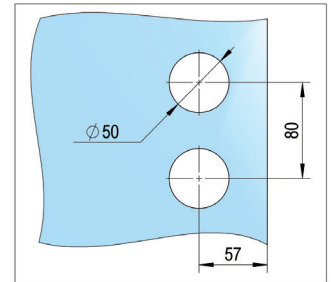

Olis Glass Door Thumb-turn Lock DIN right



FINISH	ART. NO.
aluminium-coloured E4/EV1	BO 5206867
stainless steel look E4/C31	BO 5206871

i Glass thickness tempered glass 8 - 10 mm, laminated glass 8.76 - 10.76 mm · Lock with control knob and “red/white” indicator · Tested according to DIN EN 12209 (latch permanent test 500,000 cycles, bolt closing test 100,000 cycles) · Tested according to DIN EN 1670 (corrosion class 3) · For project applications with high frequency use doors · Rebate depth 24 mm (for 8 mm) / 26 mm (for 10 mm) · Lock with noise absorbing whisper latch

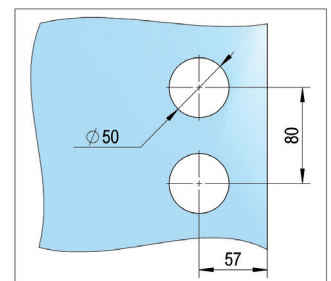

Olis Keep DIN left



FINISH

ART. NO.

aluminium-coloured E4/EV1

BO 5206837

stainless steel look E4/C31

BO 5206838

① Glass thickness tempered glass 8 - 10 mm, laminated glass 8.76 - 10.76 mm · Keep for double doors and fixed glazing · Rebate depth 24 mm (for 8 mm) / 26 mm (for 10 mm)

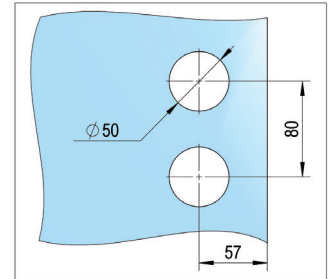

Olis Keep DIN right

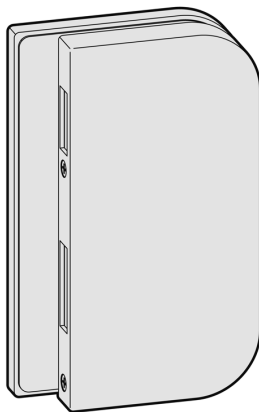

FINISH

ART. NO.

aluminium-coloured E4/EV1

BO 5206839

stainless steel look E4/C31

BO 5206840

① Glass thickness tempered glass 8 - 10 mm, laminated glass 8.76 - 10.76 mm · Keep for double doors and fixed glazing · Rebate depth 24 mm (for 8 mm) / 26 mm (for 10 mm)

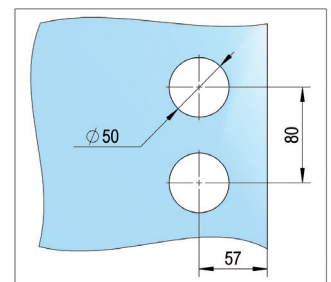

Olis Glass Door Hinge 3-part with sleeve

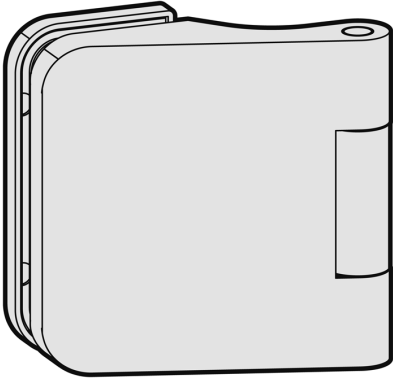

FINISH	ART. NO.
aluminium-coloured E4/EV1	BO 5206848
stainless steel look E4/C31	BO 5206850

❗ Glass door hinge with sleeve · Installation in frames according to DIN 18101 / 18111 · Rebate depth 24 mm (for 8 mm) / 26 mm (for 10 mm) · Max. door width 1000 mm · Self-closing function no · Max. door weight per pair 42 kg

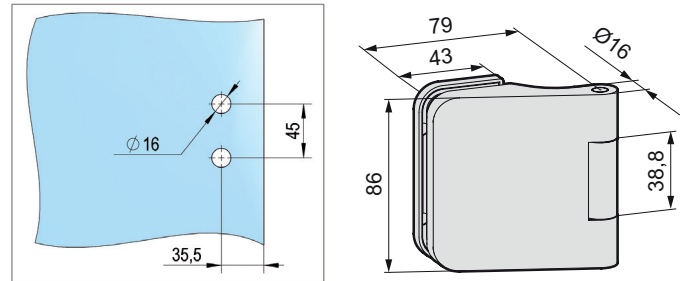

Alea Glass Door Latch DIN left Non locking



FINISH	ART. NO.
aluminium-coloured E4/EV1	BO 5206872
stainless steel look E4/C31	BO 5206883

❗ Glass thickness tempered glass 8 - 10 mm, laminated glass 8.76 - 10.76 mm · Latch, non locking · Tested according to DIN EN 12209 (latch permanent test 500,000 cycles, bolt closing test 100,000 cycles) · Tested according to DIN EN 1670 (corrosion class 3) · For project applications with high frequency use doors · Rebate depth 24 mm (for 8 mm) / 26 mm (for 10 mm) · With noise absorbing whisper latch

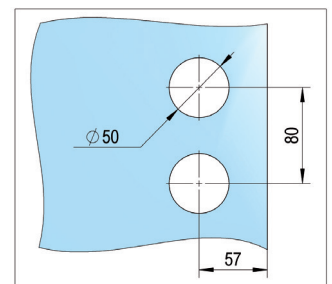

Alea Glass Door Latch DIN right Non locking



FINISH	ART. NO.
aluminium-coloured E4/EV1	BO 5206873
stainless steel look E4/C31	BO 5206884

① Glass thickness tempered glass 8 - 10 mm, laminated glass 8.76 - 10.76 mm · Latch, non locking · Tested according to DIN EN 12209 (latch permanent test 500,000 cycles, bolt closing test 100,000 cycles) · Tested according to DIN EN 1670 (corrosion class 3) · For project applications with high frequency use doors · Rebate depth 24 mm (for 8 mm) / 26 mm (for 10 mm) · With noise absorbing whisper latch

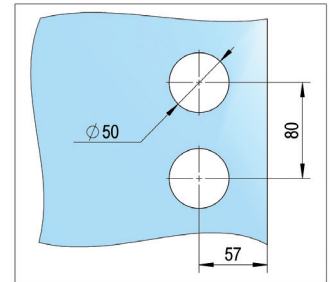

Alea Glass Door Lock DIN left Profile cylinder with rosette



FINISH	ART. NO.
aluminium-coloured E4/EV1	BO 5206874
stainless steel look E4/C31	BO 5206885

① Glass thickness tempered glass 8 - 10 mm, laminated glass 8.76 - 10.76 mm · Lock prepared for profile cylinder · Profile cylinder, 63 mm, for flush closure according to DIN 18257 · Tested according to DIN EN 12209 (latch permanent test 500,000 cycles, bolt closing test 100,000 cycles) · Tested according to DIN EN 1670 (corrosion class 3) · For project applications with high frequency use doors · Rebate depth 24 mm (for 8 mm) / 26 mm (for 10 mm) · Lock with noise absorbing whisper latch

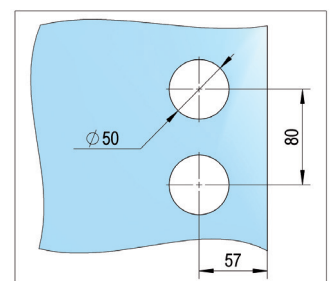

Alea Glass Door Lock DIN right Profile cylinder with rosette



FINISH	ART. NO.
aluminium-coloured E4/EV1	BO 5206875
stainless steel look E4/C31	BO 5206886

i Glass thickness tempered glass 8 - 10 mm, laminated glass 8.76 - 10.76 mm · Lock prepared for profile cylinder · Profile cylinder, 63 mm, for flush closure according to DIN 18257 · Tested according to DIN EN 12209 (latch permanent test 500,000 cycles, bolt closing test 100,000 cycles) · Tested according to DIN EN 1670 (corrosion class 3) · For project applications with high frequency use doors · Rebate depth 24 mm (for 8 mm) / 26 mm (for 10 mm) · Lock with noise absorbing whisper latch

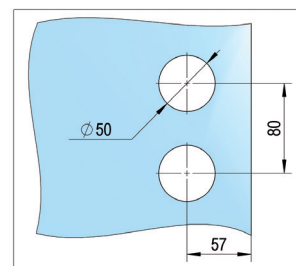

Alea Glass Door Lock DIN left Profile Cylinder



FINISH	ART. NO.
aluminium-coloured E4/EV1	BO 5206876
stainless steel look E4/C31	BO 5206887

i Glass thickness tempered glass 8 - 10 mm, laminated glass 8.76 - 10.76 mm · Lock prepared for profile cylinder · Tested according to DIN EN 12209 (latch permanent test 500,000 cycles, bolt closing test 100,000 cycles) · Tested according to DIN EN 1670 (corrosion class 3) · For project applications with high frequency use doors · Rebate depth 24 mm (for 8 mm) / 26 mm (for 10 mm) · Lock with noise absorbing whisper latch

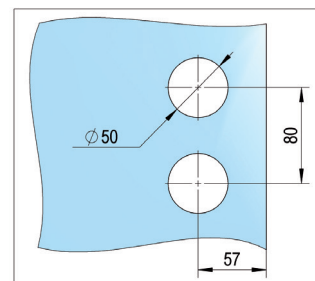

Alea Glass Door Lock DIN right Profile Cylinder



FINISH	ART. NO.
aluminium-coloured E4/EV1	BO 5206877
stainless steel look E4/C31	BO 5206888

① Glass thickness tempered glass 8 - 10 mm, laminated glass 8.76 - 10.76 mm · Lock prepared for profile cylinder · Tested according to DIN EN 12209 (latch permanent test 500,000 cycles, bolt closing test 100,000 cycles) · Tested according to DIN EN 1670 (corrosion class 3) · For project applications with high frequency use doors · Rebate depth 24 mm (for 8 mm) / 26 mm (for 10 mm) · Lock with noise absorbing whisper latch

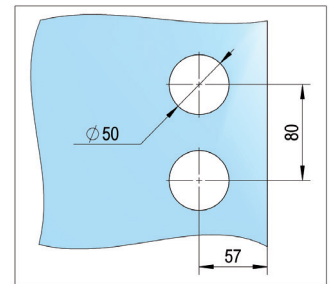

Alea Glass Door Thumb-turn lock DIN left



FINISH	ART. NO.
aluminium-coloured E4/EV1	BO 5206878
stainless steel look E4/C31	BO 5206889

① Glass thickness tempered glass 8 - 10 mm, laminated glass 8.76 - 10.76 mm · Lock with control knob and "red/white" indicator · Tested according to DIN EN 12209 (latch permanent test 500,000 cycles, bolt closing test 100,000 cycles) · Tested according to DIN EN 1670 (corrosion class 3) · For project applications with high frequency use doors · Rebate depth 24 mm (for 8 mm) / 26 mm (for 10 mm) · Lock with noise absorbing whisper latch

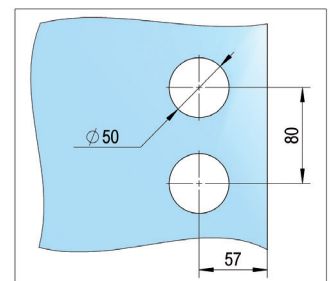

Alea Glass Door Thumb-turn Lock DIN right



FINISH	ART. NO.
aluminium-coloured E4/EV1	BO 5206879
stainless steel look E4/C31	BO 5206890

i Glass thickness tempered glass 8 - 10 mm, laminated glass 8.76 - 10.76 mm · Lock with control knob and "red/white" indicator · Tested according to DIN EN 12209 (latch permanent test 500,000 cycles, bolt closing test 100,000 cycles) · Tested according to DIN EN 1670 (corrosion class 3) · For project applications with high frequency use doors · Rebate depth 24 mm (for 8 mm) / 26 mm (for 10 mm) · Lock with noise absorbing whisper latch

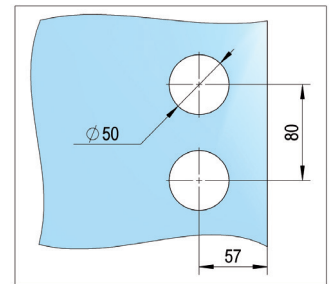

Alea Keep DIN left



FINISH	ART. NO.
aluminium-coloured E4/EV1	BO 5206880
stainless steel look E4/C31	BO 5206891

i Glass thickness tempered glass 8 - 10 mm, laminated glass 8.76 - 10.76 mm · Keep for double doors and fixed glazing · Rebate depth 24 mm (for 8 mm) / 26 mm (for 10 mm)

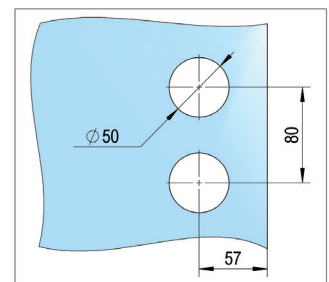

Alea Keep DIN right

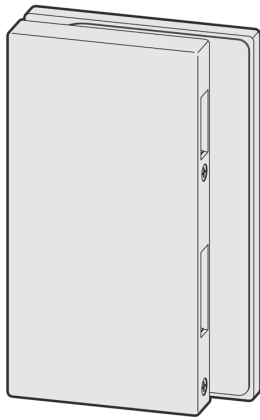

FINISH	ART. NO.
aluminium-coloured E4/EV1	BO 5206881
stainless steel look E4/C31	BO 5206892

① Glass thickness tempered glass 8 - 10 mm, laminated glass 8.76 - 10.76 mm · Keep for double doors and fixed glazing · Rebate depth 24 mm (for 8 mm) / 26 mm (for 10 mm)

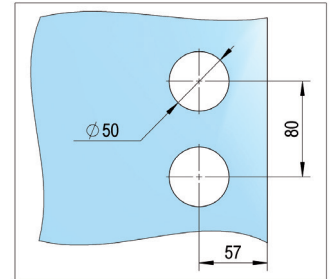

Alea Glass Door Hinge 3-part with sleeve



FINISH	ART. NO.
aluminium-coloured E4/EV1	BO 5206882
stainless steel look E4/C31	BO 5206893

① Glass door hinge with sleeve · Installation in frames according to DIN 18101 / 18111 · Rebate depth 24 mm (for 8 mm) / 26 mm (for 10 mm) · Please order the suitable frame pivot separately · Glass thickness tempered glass 8 - 10 mm, laminated glass 8.76 - 10.76 mm · Max. door width 1000 mm · Self-closing function no · Max. door weight per pair 42 kg

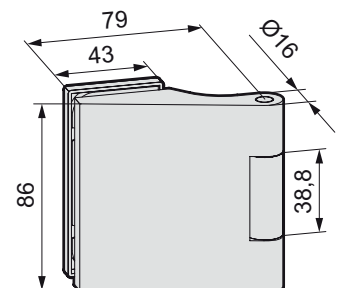
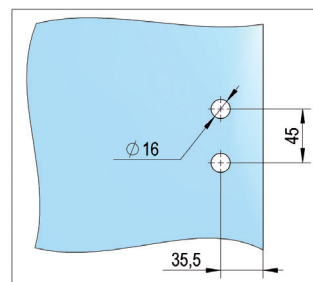

Other products such as strike plates, frame pivots and handles complement the extensive portfolio. Find out more at www.bohle.com!

Bohle AG
Dieselstr. 10
42781 Haan

T +49 2129 5568-249
F +49 2129 5568-241

export@bohle.de
www.bohle.com