



Glass and Glazing Tools

Accessories for Glass Professionals

Contents

01	Manual Glass Cutting · Glass Breaking	4
02	Glass Handling	14
03	Glazing	25
04	Grinding · Drilling · Sawing	35
05	Surface Protection	42
06	Glass Bonding	45
07	Cutting Wheels · Wheel Holder	60
08	Glass Processing Machinery	65

Silberschnitt

DIAMANTOR



Glass Cutting & Glass Breaking

One of the first steps when processing glass is cutting large panes into smaller units. By scoring the glass surface, tensions in the glass are released and lead to the break when bending the pane in a controlled manner - either by hand or with a tool. Only when using a suitable tool is it guaranteed that the glass breaks precisely where desired. Products for cutting and breaking glass were the first

items Josef Bohle started producing in 1923. Since then brand names like Silberschnitt® and Diamantor® have gained a world-wide reputation and today are still Bohle's core competence. In this product range you will find one of the world's largest selections of products for cutting and breaking flat glass.



01 | Glass Cutting & Glass Breaking

▶ Silberschnitt® Oil Glass Cutter



Perfect glass cutting · optimal application of cutting fluid ensures smooth glass breaking · 2-valve technology · round cutting head · trailing, exchangeable Toplife cutting wheels · sturdy brass handle · for shape and straight cutting.

i Cutting angle 155 ° · Straight edge stand-off distance 6 mm · Glass thickness 6 - 12 mm

Art. No.

BO 2000.M

Oil Glass Cutter 2000.M MASTER

▶ Silberschnitt® Oil Glass Cutter



Perfect glass cutting · optimal application of cutting fluid ensures smooth glass breaking · 2-valve technology · round cutting head · trailing, exchangeable Toplife cutting wheels · sturdy brass handle · for shape and straight cutting.

i Cutting angle 145 ° · Straight edge stand-off distance 6 mm · Glass thickness up to 3 - 6 mm

Art. No.

BO 2000.S

Oil Glass Cutter 2000.S STANDARD

▶ Silberschnitt® Oil Glass Cutter



Perfect glass cutting · optimal application of cutting fluid ensures smooth glass breaking · 2-valve technology · round cutting head · trailing, exchangeable Toplife cutting wheels · sturdy brass handle · for shape and straight cutting

i Cutting angle 158 ° · Straight edge stand-off distance 6 mm · Glass thickness up to 12 - 19 mm

Art. No.

BO 2000.P

Description

Silberschnitt® 2000.P POWER Oil Glass Cutter

▶ Transverse Handle for Oil Glass Cutters



Ergonomic transverse handle for optimum application of higher cutting pressure · can be fitted to the metal models of Silberschnitt® oil glass cutters of the series 2000 and 5000 as well as BO 448.8 · individually adjustable to hand size

Art. No.

BO 2045.0

Transverse Handle for Silberschnitt® Oil Glass Cutters

▶ Silberschnitt® Wheel Holder



For Silberschnitt® 2000 oil glass cutters and circle cutters

Art. No.	Glass thickness · Cutting angle
BO 2449.0	0,8 - 2 mm · Wheel holder 120 °
BO 2449.1	1 - 2 mm · Wheel holder 127 °
BO 2449.2	2 - 4 mm · Wheel Holder 135 °
BO 2449.3	3 - 5 mm · Wheel holder 140 °
BO 2449.4	4 - 6 mm · Wheel holder 145 °
BO 2449.5	4 - 8 mm · Wheel holder 150 °
BO 2449.6	6 - 12 mm · Wheel holder 155 °
BO 2449.7	12 - 19 mm · Wheel holder 158 °
BO 2449.8	19 - 25 mm · Wheel holder 160 °
BO 2449.9	19 - 25 mm · Wheel holder 165 °

Silberschnitt® 5000 Oil Glass Cutter



i Cutting angle 140 ° · Straight edge stand-off distance 2,5 mm · Glass thickness 3 - 12 mm · Wide cutting head

Art. No.	Description
BO 5000.0	brass handle

Silberschnitt® 5000 Oil Glass Cutter



i Cutting angle 140 ° · Straight edge stand-off distance 2,5 mm · Glass thickness 3 - 12 mm · Wide cutting head

Art. No.	Description
BO 5001.0	plastic handle

Silberschnitt® Cutting Head

For all Silberschnitt® oil glass cutters and speed cutters



i Cutting angle 140 ° · Glass thickness 3 - 12 mm · Wide cutting head

Art. No.	Description · Cutting angle · Cutting head
BO 5010.0	Spare Cutting Head · 140 ° · wide °

- ✓ High quality and sturdy oil glass cutter
- ✓ “Made in Germany” at affordable prices
- ✓ Cutting head made of wear resistant materials guarantees doubled service life compared to well known competitor’s products
- ✓ Silberschnitt Toplife carbide cutting wheel with improved cutting characteristics
- ✓ Optimized cut, improved edge quality



Silberschnitt® 2000 Special Glass Cutter



Glass cutter in Silberschnitt® 2000 quality · Toplife cutting wheel · plastic handle with traditional glazier’s shape · can be placed underneath the score to break the glass · very lightweight cutting head made of special alloy · very fine, smooth cutting · an ideal all-purpose glass cutter · wheels not exchangeable

i Cutting angle 138 ° · Straight edge stand-off distance 2,5 mm · Glass thickness 2 - 6 mm

Art. No.	plastic handle
BO 2004.0	blue ·

DIAMANTOR Carbide Glass Cutter



i Cutting angle 135 ° · Straight edge stand-off distance 2,5 mm · Glass thickness 3 - 8 mm

Art. No.	Description
BO 260.0	Carbide Glass Cutter

DIAMANTOR Glass Cutter



With rounded wooden handle · with one steel wheel

i Cutting angle 130 ° · Straight edge stand-off distance 1,5 mm · Glass thickness 3 - 6 mm · Packaging unit 12 items

Art. No.	Description
BO 200.1	Glass Cutter

Silberschnitt® Glass Cutter



Glass cutter for general cutting tasks, especially economical as wheels are exchangeable and turrets and cutting heads are nickel-plated · 6 cutting wheels made of stainless steel and tempered by a patented method guarantee high cutting quality and long service life.

i Cutting angle 130 ° · Straight edge stand-off distance 2,5 mm · Glass thickness 3 - 6 mm · Packaging unit 12 items

Art. No.

BO 100.0

Silberschnitt® Spare Turret



For glass cutters BO 400.0, BO 410.0 and BO 400.1

i Carbide Cutting Wheels with 5 mm Ø

Art. No.	Cutting angle · Sales unit
BO 401.120	120 ° · 10 items
BO 401.135	135 ° · 10 items

Bohle Speed Cutter



For quick and easy cutting of large glass panes · with integrated supply of cutting fluid and Silberschnitt® cutting head with Toplife cutting wheel

Art. No.	Cutting width · Cutting angle · Description
BO 4580.0	110 - 600 mm · 138 °
BO 4580.1	110 - 1200 mm · 138 °
BO 4580.2	110 - 1800 mm · 138 °
BO 4580.5	Spare cutting head, complete
BO 4580.6	Spare roller
BO 4580.7	Spare Cutting Head 138 °
BO 4580.145	Spare Cutting Head 145 °
BO 4580.155	Spare Cutting Head 155 °

Silberschnitt® Spare Wheels



Stainless steel · specially tempered · suitable for all Silberschnitt® glass and circle cutters · in a plastic bag

i Cutting angle 130 ° · Packaging unit 12 items

Art. No.	Description
BO 102.1	Spare Wheels

Silberschnitt® Carbide Wheels BASIC



For glass cutters BO 400.0, BO 410.0 and BO 400.1

i Grind Basic · Diameter 5 mm · Thickness 1 mm · Bore hole 1,3 mm

Art. No.	Bracket · Grind · Sales unit
BO 02B120	120 ° · Basic · 10 items
BO 02B135	135 ° · Basic · 10 items

Silberschnitt® Carbide Glass Cutter



Wooden handle · replaceable, tempered turret · especially selected carbide metal guarantees high wear resistance · especially suitable for thick or hard glass

i Cutting angle 135 ° · Straight edge stand-off distance 2,5 mm · Glass thickness 3 - 6 mm · Carbide Cutting Wheels 5 mm Ø

Art. No.	Description
BO 400.0	Carbide Glass Cutter

Glass Tube Cutter



Nickel-plated · for glass tubes of 4 - 30 mm diameters

i Cutting angle 90 °

Art. No.	Description · Cutting angle
BO 5000117	Glass Tube Cutter
BO 5000118	Spare Wheels 90 °

Cutting FluidSilberschnitt®

Silberschnitt



Ensures a soft, precise break · binds glass particles · consistently unhindered run of wheel · low surface tension allows easy penetration into the cut

Art. No.	Contents · Description
BO 026	1 litre · for manual cutting

Container for Glass Cutters



To secure onto smooth, clean and non-porous surfaces

i With suction base

Art. No.	Description
BO 671.0	Container for Glass Cutters

Spare Wheel Holder



For Silberschnitt® 2000 oil glass cutters and circle cutters

Art. No.	Glass thickness · Cutting angle
BO 2449.7	12 - 19 mm · Wheel holder 158 °
BO 2449.8	19 - 25 mm · Wheel holder 160 °

Thick Glass Cutting Sledge Set

Silberschnitt 2000



The Silberschnitt® cutting sledge is ideal for straight cutting of thick glass. It is used with special Bohle straight edges which are secured to the glass by means of suction cups. The Silberschnitt® oil glass cutter 2000

i Glass thickness up to 25 mm

Art. No.	Description
BO 2720.0	Thick Glass Cutting Sledge Set

▶ Thick Glass Cutting Kit in Aluminium Case



This kit contains all necessary tools for cutting circles and straight cuts in glass. For 25 mm glass we recommend wheel holder BO 2449.8 with 160° and glass tapper BO 710.1. Oil glass cutter BO 2000.P POWER and practical aluminium carrying case included.

i Glass thickness up to 20 mm · Diameter max. 120 cm

Art. No.	Glass thickness · Diameter
BO 2740.0	up to 25 mm · 120

▶ Silberschnitt® Cut Opening Tapper for Thick Glass



Heavy-duty, all-metal construction
· works according to striker principle · adjustable tapper force · for controlled breaking with clean edges, even in difficult cases

Art. No.	Glass thickness
BO 710.0	10 - 20 mm
BO 710.1	15 - 25 mm

▶ Silberschnitt® Cut Running Pliers



Heavy-duty · all-metal construction
· precisely adjustable to glass thickness · optimum distribution of pressure · Recommended: BO 702.5 for opening narrow strips

i Cutting length up to 6 m

Art. No.	Description · Glass thickness
BO 702.0	Cut Running Pliers · up to 25 mm
SP B0734.1	Spare plastic tip 10 x 14 mm
BO 702.5	Pressure Bar 80 x 12 mm

▶ Silberschnitt® Circle Cutter with 6 Steel Wheels



Wheels and turret can be easily exchanged

i Cutting angle 130 ° · Diameter min. 72 mm

Art. No.	Diameter · Description
BO 511.0	60 cm
BO 511.1	24 "
BO 514.0	120 cm
BO 514.1	48 "
BO 516.0	200 cm
BO 516.1	80 "
BO 518.0	Cutting Head for Circle Cutters

Silberschnitt® Spare Turret



Suitable for Silberschnitt® glass cutters as well as circle cutter BO 516.0

i Cutting angle 130 °
Packaging unit 12 items

Art. No.	Description
BO 101.0	Spare turret Silberschnitt®

Tool Kit for Corner Cut-Outs



Corner cut-outs can be produced quickly and effortlessly - no more troublesome drilling or sawing
· reduces workload e.g. when producing toughened glass - for manual corner cutting in flat glass
· comes in a practical storage case

i Radius 7 mm · Glass thickness 3 - 15 mm

Art. No.	Description
BO 578.0	

Circle and Oval Cutting Machine System 2000

Silberschnitt 2000



Precise cuts for either 22 - 122 cm or 9" - 48" - for glass up to 25 mm thick using different wheel holders - minimum diameter difference 6 cm
· includes oil glass cutter 2000.S STANDARD 145°, T-handle, Jobo glass breaking device BO 705.0, cutting fluid, 2 felt-tip pens with adaptor - in practical aluminium case

Art. No.	Diameter · Description
BO 2550.0	22 - 122 cm
BO 2550.1	9 - 48 "
BO 2551.0	Extension set 182 cm
BO 2551.1	Extension set 70"

Silberschnitt® Spare Wheels



Stainless steel, specially tempered
· for all Silberschnitt® glass and circle cutters

i Cutting angle 130 °
Packaging unit 120 items in a practical dispenser

Art. No.	Description
BO 102.0	Spare Wheels

Tool Kit for Lateral Cut-Outs



The combination of adjustable template, Silberschnitt® 2000 oil glass cutter with 360° revolving cutting head and cut opener makes lateral cut-outs possible
· ideal for the production of toughened glass and shop fitting - includes case

i Radius 7 mm · Glass thickness up to 10 mm

Art. No.	Description
BO 578.2	

Radius Corner Template

With two suction pads for fixing - for use with glass cutter 2000.M, 2000.P or 2000.S



i Straight edge stand-off distance 6 mm · Radius 10 - 70 mm

Art. No.	Description
BO 078.5	Radius Corner Template

Tape Measure



Adjustable end-hook · shockproof case · locking button

i Tape width 16 mm

Art. No.	Length
BO 5106023	3 m
BO 5106031	5 m
BO 5106032	8 m

▶ Bohle L-Squares with Brace - black



These L-squares are manufactured in one piece from high-quality material. The integrated brace ensures especially high precision.

Art. No.	Length · Width
BO 031.1	60 cm · 30 cm
BO 033.1	105 cm · 40 cm
BO 035.1	150 cm · 45 cm
BO 037.1	205 cm · 60 cm

▶ Bohle Cutting Frame



Practical auxiliary device when cutting a series of equally dimensioned glass panes

Art. No.	Length
BO 070.040	40 cm
BO 070.060	60 cm
BO 070.080	80 cm
BO 070.100	100 cm

▶ Spare Suction Pad



For straight edges · complete with lever, washer and pin

Art. No.	
BO 051.01	Spare Suction Pad

▶ T-Square



Traditional T-square in standard quality · flat run-off ensures cuts all the way to the edge of the glass · easy to use

i Material aluminium

Art. No.	Length
BO SATSQ60R	600 mm
BO SATSQ100R	1000 mm
BO SATSQ150R	1500 mm
BO SATSQ200R	2000 mm

▶ Straight Edges with Integrated Suction Cups



Made of high-quality synthetic material · BO 051.xxx = 5 mm thick · BO 052.xxx = 10 mm thick, thus suitable for Silberschnitt® Cutting Sledge for thick glass BO 2720.0

Art. No.	Length · Width · Suction Cups
BO 052.203	200 cm · 8 cm · 3
BO 052.253	250 cm · 8 cm · 3
BO 052.304	300 cm · 8 cm · 4
BO 052.355	350 cm · 8 cm · 5
BO 052.405	400 cm · 8 cm · 5

▶ Felt Cloth for Cutting Tables



i Width 200 cm · Thickness 4 mm · Weight 800 g/m² · Colour black

Art. No.	Description
BO 2300005	Felt Cloth for Cutting Tables



Verifix® Eccentric Suction Stopper



Eccentrically arranged, flat plastic disc · integrated suction pad · suitable for use when bonding floors or shelves in display cabinets · can be used individually or in pairs as precisely adjustable straight edge holder

i Height 20 mm · Adjustment range 6 mm

Art. No.	Inside · Outside · Description
BO 637.1	55 mm Ø · 70 mm Ø
BO 637.5	Spare Suction Pad



Spray Adhesive 77



Specially for bonding glazier's felt to cutting tables · universal use, sticks immediately, does not bleed through and is resistant to heat and ageing · free of fluorocarbons · for added safety no solvents have been used which are classed as toxic per Ordinance on Hazardous Substances · one can covers approx. 5 m²

Art. No.	Contents
BO 3202070	500 ml



Silberschnitt® Cut Running Pliers



All-metal · with adjustment screw to set to individual glass thickness · optimum load transmission · also ideal to open straight cuts, corner cut-outs, etc. · Recommended: BO 704.5 for opening narrow strips

Art. No.	Description · Glass thickness
BO 704.0	Cut Running Pliers · 6 - 15 mm
SP B0734.1	Spare plastic tip 10 x 14 mm



Silberschnitt® Cut Opener



For complicated cuts · ideal for opening corner, lateral or other shaped cuts · turnable pressure ring for optimum adjustment to all cuts · max. reach 100 mm

i Glass thickness 6-10 mm

Art. No.	Glass thickness
BO 706.0	6 - 10 mm



Cut Running Pliers



With adjustment screw · centre mark on upper jaw · especially suitable for breaking narrow strips

i Glass thickness 3 - 5 mm · Length 200 mm · Jaw width 24 mm

Art. No.	
BO 5008800	Cut Running Pliers



Glass Breaking Pliers



i Colour blue · Length 200 mm · Jaw width 27 mm

Art. No.	
SA GBP0110	Glass Breaking Pliers



Glass Breaking Pliers



Plastic coated handles · ground head · Made in Germany

i Length 180 mm · Jaw width 24 mm · Colour black

Art. No.	
BO 5008118	Glass Breaking Pliers



Glass Breaking Pliers



Lacquered blue · ground head · Made in Germany

i Colour blue · Length 200 mm · Jaw width 20 mm

Art. No.	
BO 5008120	Glass Breaking Pliers



Silberschnitt® Grozing Pliers



Plastic coated handles · ground head · ideal for art glass work · small contact area · little strength required · less risk of breaking · Made in Germany

i Length 160 mm · Jaw width 4 mm

Art. No.

BO 089

Grozing Pliers



Silberschnitt® Scalloping Tool for Edge Decoration



Art. No.

BO 719.0

Description · Glass thickness

Scalloping Tool · 3 - 25 mm

BO 719.1

Spare chisel



Positioning Aid for Scalloping Tool



Makes your scallops on straight edges or circles even more uniform

Art. No.

BO 719.5

Positioning Aid for Scalloping Tool



Spare Bit for Scalloping Tool



For scalloping tool Art. No. BO 719.0 · For scalloping tool Art. No. BO 719.0

Art. No.

BO 719.1

Description

Spare chisel



Handling

The large range of products found in this chapter reflects the diversity of transport requirements that need to be met in the day-to-day handling of glass. Lifting and transporting devices that have been specially developed for the glass trade make this work easier.

Safe transportation of glass is a basic requirement for the user and a main priority during development for Bohle, whether for relatively simple manual lifters or sophisticated, electrically driven lifting systems.



02 | Handling

The right application for any material

Due to the different raw materials used and the different shapes of the suction pads, the suction lifters have been optimised for use on different materials such as flat glass and sheet materials made of plastic, metal, marble or coated wood. Bohle offers suitable suction pads for all gastight materials.

In the following pictures, different materials are displayed by pictograms.



Glass



Metal



Marble / Stoneware



Coated Wood



Plastic

Pump-Activated Suction Lifters

Equipped with one suction pad only, pump-activated suction lifters enable the manual transport of different materials with a load capacity of up to 120 kg. The vacuum is generated by engaging the pump tappet. The vacuum level can be increased at all times, also while the load is attached. Moreover, due to its position the pump tappet offers the possibility of visually monitoring the vacuum. Almost all Bohle Veribor® suction lifters have been granted the TÜV Certificate (German Technical Inspection Agency) as they all take measures against an unintended vacuum loss.



Lever-Activated Suction Lifters with Vacuum Indicator

What was so far only possible for pump-activated suction lifters is now also available for lever-activated suction lifters - controlling a sufficient level of vacuum! In this way the user can recognise whether the suction lifter has been attached correctly or whether the protruding rocker indicates a loss of vacuum. This innovation for lever-activated suction lifters has been patented by Bohle. Thanks to this safety function, the lever-activated suction lifters with vacuum indicator have been granted the TÜV certificate. Many of the Bohle Veribor® products are available both with and without vacuum indicator.



- ✓ 4:1 Safety factor: Carrying Capacity of 133 lbs!
- ✓ Plastic body with new ergonomics
- ✓ Softer rubber pad and improved design
- ✓ TÜV-tested and GS-certified
- ✓ Made in Germany

▶ Veribor® blue line Pump-Activated Suction Lifter



Pump-activated suction-lifter made of plastic. The new Bohle pump-activated suction lifter is designed totally with ergonomics in mind. An entirely newly-designed handle with non-slip coating and larger gripping space offers maximum comfort. The rounded pump tappet enables quick and convenient operation and its red ring enables permanent visual monitoring of the vacuum. The suction lifter lends itself to all materials with flat, airtight surfaces. The high quality of the suction lifter has been confirmed by TÜV (German Technical Inspection Agency) by granting it the GS sign.

❶ Suction pad ø 210 mm · Number of suction pads 1 · suitable for Glass · suitable for Plastic · suitable for Metal · suitable for Coated wood · suitable for Marble / Stoneware · with vacuum gauge · with TÜV Certificate · with CE sign · Load capacity · Lifting direction

Art. No.	Load capacity · Lifting direction · Description
BO 601BL	120 kg · parallel
BO 601.01	Spare suction pad
SP 6830.0K	Spare valve housing
SP 6600.01K	Spare tappet
SP 6850K	Spare handle with bracket

▶ Veribor® blue line 1-Cup Suction Lifter

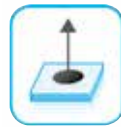

Suction lifter with folding lever for lifting different loads. The suction lifter can be equipped with an additional, optional sealing lip which lends itself to slightly curved or textured surfaces. In addition, spare rubber pads are also available if required, supplied together with lever, spring, bolt and washer.

❶ Suction pad ø 120 mm · Number of suction pads 1 · suitable for Glass · suitable for Plastic · suitable for Metal · suitable for Coated wood · suitable for Marble / Stoneware · with CE sign · Load capacity · Lifting direction

Art. No.	Load capacity · Lifting direction · Description
BO 600.0BL	30 kg · vertical
BO 600.02BL	25 kg · vertical · rubber pad with additional sealing lip
BO 610.0BL	Spare suction pad for BO 600.0BL
BO 610.02BL	Spare suction pad for BO 600.02BL

▶ Veribor® blue line 2-Cup Suction Lifter



Suction lifter with lever and lengthwise handle for carrying and lifting different loads. Suitable for all materials with flat and airtight surfaces.

i Suction pad ø 120 mm · Number of suction pads 2 · suitable for Glass · suitable for Plastic · suitable for Metal · suitable for Coated wood · suitable for Marble / Stoneware · with CE sign · Load capacity · Lifting direction

Art. No.	Load capacity · Lifting direction · Description
BO 602.4BL	60 kg · parallel
BO 602.42BL	50 kg · vertical · rubber pad with additional sealing lip
BO 614.0BL	Spare suction pad for BO 603.0BL / BO 602.0BL / BO 602.4BL
BO 614.02BL	Spare suction pad for BO 602.02BL / BO 602.42BL

▶ Veribor® blue line 3-Cup Suction Lifter



Universal suction lifter from the Veribor® series for carrying and lifting different loads. The blue line series stands out due to its combination of modern, high-performance materials and the high stability of aluminium together with an ergonomic, user-friendly plastic handle. Suitable for all materials with flat, airtight surfaces. The suction lifter must be pressed firmly, with the rubber pad relaxed, onto the respective surface. When you activate the lever, you will clearly notice the resistance caused by generating the vacuum.

i Suction pad ø 120 mm · Number of suction pads 3 · suitable for Glass · suitable for Plastic · suitable for Metal · suitable for Coated wood · suitable for Marble / Stoneware · with CE sign · Load capacity · Lifting direction

Art. No.	Load capacity · Lifting direction · Description
BO 603.0BL	100 kg · parallel
BO 614.0BL	Spare suction pad for BO 603.0BL / BO 602.0BL / BO 602.4BL

▶ Replacement suction pad



Replacement suction pad

i Suction pad 120 mm · Load capacity · Lifting direction · Number of suction pads

Art. No.	Description
BO 614.0BL	Spare suction pad for BO 603.0BL / BO 602.0BL / BO 602.4BL

▶ Veribor® Suction Lifter, 2-Cup, Plastic



The well-known and proven Veribor® plastic suction lifter has been completely redesigned and now offers improved carrying comfort due to an extended gripping area. In addition, the suction lifter is equipped with a newly designed rubber pad which does not roll up during transport. This suction lifter is suitable for all materials with flat, airtight surfaces. It is also available with stainless steel components as an option (BO 602.11A) · The new handle, coated with slip resistant rubber, prevents the hand from slipping while working with the suction lifter.

i Suction pad ø 120 mm · Number of suction pads 2 · suitable for Glass · suitable for Plastic · suitable for Metal · suitable for Coated wood · suitable for Marble / Stoneware · with CE sign · Load capacity · Lifting direction

Art. No.	Load capacity · Lifting direction · Description
BO 602.1A	60 kg · parallel

▶ Suction Lifter, All-Rubber with Two Finger Holes



Suitable for lifting and opening different objects, e.g. for opening cable ducts. The vacuum is generated by simply pressing the suction pad onto the centre of the surface to be lifted. The lifter can be loosened from the surface by slightly lifting the release nipples laterally.

i Diameter 80 mm · Number of suction pads 1 · suitable for Glass · suitable for Plastic · suitable for Metal · suitable for Coated wood · suitable for Marble / Stoneware

Art. No.	Load capacity · Lifting direction
BO 609.80	10 kg · vertical

▶ Suction Lifter, All-rubber, with Finger Hole



Suitable for lifting and carrying different small objects, e.g. for opening cable ducts. The vacuum is generated by simply pressing the suction pad onto the centre of the surface to be lifted. The lifter can be loosened from the surface by slightly lifting the release nipples laterally.

i Diameter 55 mm · Number of suction pads 1 · suitable for Glass · suitable for Plastic · suitable for Metal · suitable for Coated wood · suitable for Marble / Stoneware

Art. No.	Load capacity · Lifting direction
BO 609.50	5 kg · vertical

▶ Veribor® Suction Lifter, 2 Plastic Swivel Heads



Makes working with unwieldy parts quicker and more effective · suitable for all materials with airtight surfaces such as glass, plastic, metal, coated wood and marble · the elongated holes in the articulated joints (BO 602.22) allow transporting panels which are curved beyond standard · On an order quantity of 1000 pieces or more, your personal logo can be printed onto the plastic body and its colour can be chosen on request.

i Suction pad ø 120 mm · Number of suction pads 2 · suitable for curved materials · suitable for Glass · suitable for Plastic · suitable for Metal · with CE sign · Load capacity · Lifting direction

Art. No.	Load capacity · Lifting direction · Description
BO 602.22	30 kg · with elongated hole · parallel · · double swivel heads

▶ Veribor® Suction Holder



This universal Veribor® suction holder is suitable for the many diverse applications. Whether for fixing mounting aids and templates or fixing cameras to vehicles, there are no limits to the user's demands.

i Number of suction pads 1 · Suction pad ø 120 mm · suitable for Glass · suitable for Plastic · suitable for Metal · suitable for Coated wood · suitable for Marble / Stoneware

Art. No.	Connecting bore hole · Description
BO 600.20	6,5 mm Ø

▶ Wood's Powr-Grip® Pump-Activated Suction Lifter



The Powr-Grip® pump-activated suction lifter with lightweight ABS handle is suitable for handling flat and airtight objects. The red ring on the pump tappet enables permanent visual monitoring of the vacuum.

- ❗ Suction pad ø 200 mm ·
- Number of suction pads 1 ·
- suitable for Glass · suitable
- for Plastic · suitable for Metal
- suitable for Coated wood ·
- suitable for Marble / Stoneware ·
- with vacuum gauge · with CE sign
- Load capacity · Lifting direction

Art. No.	Load capacity · Lifting direction
BO 6023157	57 kg · parallel

▶ Powr-Grip (N5000 CS) Vacuum Cup



Lightweight, heavy duty handle made of rustproof ABS · Flexible vacuum pad edge for easy attachment on either flat or curved, nonporous surfaces · Red-line indicator warns user of any significant vacuum loss · Check valve allows repumping without loss of remaining vacuum · Valve lever permits quick and complete release · Easily replaceable handle / release valve and plunger · Supplied with protective carrying case.

- ❗ Vacuum Pad: Concave, 9" (23 cm) diameter · Load Capacity: 150 lbs (68 kg) per vacuum cup

Art. No.	Load capacity · Lifting direction
BO 6023054	68 kg · parallel

▶ Liftmaster B1 Lifting System with Dual Circuit Vacuum Lifter



Features

- Easy and secure handling of structural components of up to 180 kg
- Stable construction
- Rack can be rotated and tilted
- Easy assembly of structural components
- Ideal for transport within company premises and on construction sites
- Can be disassembled easily, fits in any estate car
- Very compact and manoeuvrable
- Fits through standard doors
- Handle is height adjustable
- Vacuum lifter: can be rotated by 360° · can be removed very easily and used separately together with a crane · has a dual circuit vacuum system with 4 suction pads · is very flat and compact · is equipped with a vacuum indicator for monitoring the vacuum · the vacuum is generated via a hand pump, therefore ready for use at all times (no previous charging of batteries required) · weight: 20 kg



Specifications	
Length	1.3 m
Width	(with extended axles for widening the gauge 1.1 m) 0.8 m
Height	1.95 m
Art. No.	BO 88.01



Manual Lifting Device



The manual lifting device can do without an electric pump and is therefore very versatile in use. A dual circuit vacuum system, reserve tanks, vacuum display and an additional visual vacuum indicator ensure high levels of safety. The manual lifting device stands out due to its very compact construction and low weight.

i Load capacity max. 180 kg · Weight approx. 20 kg · Dimensions 910 mm x 510 mm x 100 mm · Turns 360 ° · Tilttable 90 °

Art. No.	
BO B18DM4	

▶ Clamping Carriage, Self-Clamping



This innovative helper saves you time and staff expenses when transporting and mounting furniture. Ideal for transporting doors, partition walls, sheet materials and structural components with a maximum thickness of 100 mm and a maximum weight of 200 kg. The easy and safe operation of the device during transport helps prevent material damages. Fatigue and back pain are minimised due to the ease of operation of the device, therefore reducing health risks and their associated costs. The transport carriage has a sturdy construction and is equipped with pneumatic tyres, also suitable for use on uneven ground, e.g. at construction sites. The equipment also includes 2 reduction blocks for thinner materials, a 4 m tension belt for connecting carriage and transported goods and a guiding aid for smaller parts.

i Now with air tyres for uneven surfaces. · Length 46 cm · Width 33 cm · Height 27 cm · suitable for Glass · suitable for Plastic · suitable for Metal · suitable for Coated wood · suitable for Marble / Stoneware

Art. No.	Description
BO 5000120	Clamping Carriage
BO 5000121	Spare air tyres
BO 5000123	Spare reduction blocks

▶ Glass Carrying Device Tragboy

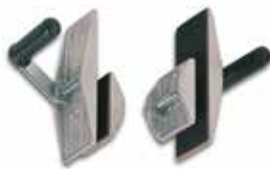

Suitable for transporting sheet materials · the load is held firmly between two non-slip, rubber-lined clamps · the heavier the load, the greater the clamping pressure

i Opening range up to 25 mm · Load capacity per pair 80 kg · suitable for Glass · suitable for Plastic · suitable for Metal · suitable for Coated wood · suitable for Marble / Stoneware

Art. No.	Description
BO 5000101	Glass Carrying Device Tragboy

▶ "Carry Clamp" Carrying Device



As a new feature, the Bohle Carry Clamp is now equipped with a rubber coating with diamond-shape texture. This coating helps prevent wet materials from slipping, particularly crafted stone or marble. The transported goods are held safely with two clamps - the heavier the load, the stronger the clamping mechanism.

i Opening range up to 40 mm · Load capacity per pair 160 kg · suitable for Glass · suitable for Plastic · suitable for Metal · suitable for Coated wood · suitable for Marble / Stoneware

Art. No.	Description
BO 5000200	Carry Clamp "Tragkuli"

▶ Glass Transporting Pliers



Sturdy transporting pliers for handling all kinds of sheet material. This device excels due to its particularly simple and safe handling. With a hoisting tool, simply lift the glass transporting pliers above the object to be transported. When placed onto the plate, a mechanism is set in motion which ensures a safe grip simply by the upwards motion of the transporting pliers. When putting the load down after transport, the pliers are automatically released by the reverse mechanism.

▼ Features

For handling of various sheet materials · Easy and secure handling · Up to 1000 kg load capacity

Art. No.	Load capacity · Material thickness
BO GTP500	500 kg · 3 - 19 mm
BO GTP1000	1000 kg · 4 - 24 mm
BO GTP1030	1000 kg · 10 - 30 mm · Available on request
BO GTP1050	1000 kg · 30 - 50 mm · Available on request



Wood's Powr-Grip® Vacuum Lifter, Load Capacity 320 kg



With 3 frame configurations, 360° rotation and 90° tilt, this Powr-Grip® vacuum lifter provides maximum versatility and flexibility in the workshop or at the construction site. As all Wood's Powr-Grip® vacuum lifters offered by Bohle, this model provides an especially high level of security with its dual circuit vacuum system. It has a load capacity of 320 kg.

Features

- Adapts to diverse transport and installation requirements
- Compact, robust construction
- For use at construction sites or workshops
- Excellent gripping power and maximum security with dual circuit vacuum system
- Independent of power supply
- If desired, also available in plastic box for transport and storage (W32DA4B)



Specifications	Wood's Powr-Grip® Vacuum Lifters
Load capacity	320 kg
Number of suction pads	4
Tilting	90 °
Rotating	360 °
Art. No.	BO W32DA4

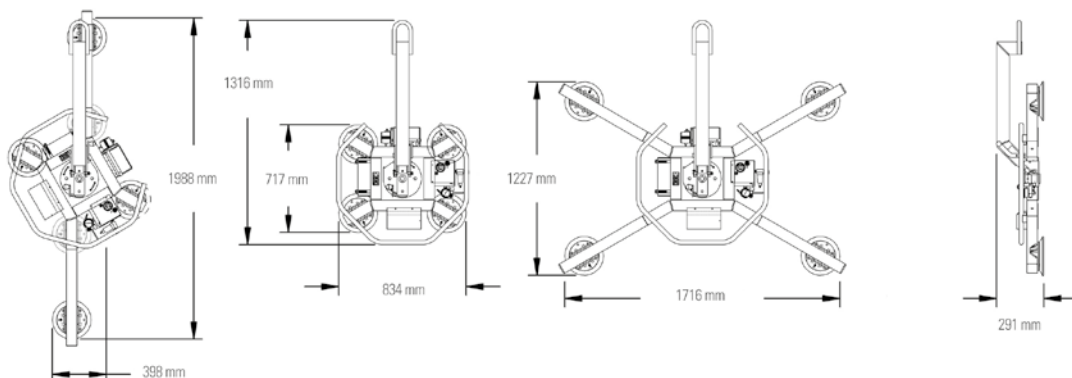



Wood's Powr-Grip® Vacuum Lifter, Load Capacity 635 kg



The Powr-Grip® lifting system MRTA811LDC is suitable for use with cranes or other hoisting equipment. The lifting system can be rotated manually by 360° and tilted by 90°. The load-bearing capacity is 635 kg. The system fully meets all requirements laid down in DIN EN 13155.

Features

- Adapts to diverse transport and installation requirements
- Especially wide range of configurations (8 different configurations)
- For use at construction sites or workshops
- Independent of power supply
- High quality – proven over many years
- High load capacity of 635 kg thanks to high performance dual circuit vacuum system which ensures reliable safety.



Specifications	Wood's Powr-Grip® Vacuum Lifter
Load capacity	635 kg
Number of suction pads	8
Tilting	90 °
Rotating	360 °
Art. No.	BO W63DA8

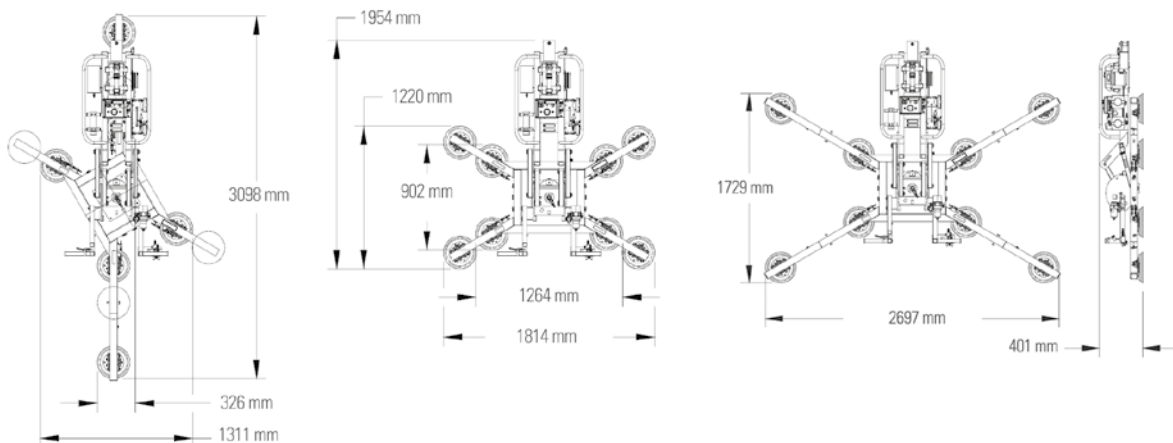



Glazing

Glazing - this section covers a wide spectrum of activities related to working with glass, windows and frames.

This begins with cutting, assembly of panes and windows as well as the required measuring techniques and includes lead and brass glazing. Repair glazing and restoration work will continue to be important in the future, too.

For this constantly growing and developing field of work you can find the appropriate quality tools and aids in this chapter that allow you to achieve professional results.



03 | Glazing

▶ Bohle GlassBuddy®



The multi-functional tool for the accurate analysis of flat glass. No matter whether single-pane, laminated or insulated glass, whether installed or not - in seconds the laser technology supplies information about glass thickness, configuration of panes, coatings, films and the exact position of films. GlassBuddy® from Bohle. One device that does it all. · Included in delivery: GlassBuddy® · protective case · operating instructions · programme for evaluation at the PC (on USB stick) · micro USB cable



▼ Characteristics

Allows installed glass to be analyzed without being removed · measures single-pane glass up to 19 mm thick · analyzes laminated glass, insulated glass panes and bulletproof glass to a total thickness of 100 mm · accuracy: 0.1 mm · detects coatings and their layers · recognises PVB films and detects their number, thickness and position · illuminated display with scrolling function and graphic display of measuring results · memory capacity can store up to 99 measurements · comparison measurements per average measured value · Micro-USB interface for reading data at your PC and for charging the battery · easy, self-explanatory menu · high quality Li-Ion battery for at least 8 hours of continuous operation

Art. No.	Description
BO 5164760	Bohle GlassBuddy® Basic
BO 5164755	Bohle GlassBuddy® Plus

▶ Bohle TinCheck®



The innovative TinCheck® measuring device identifies the tin bath side of float glass quickly, easily and reliably. By using the latest technologies, Bohle has succeeded in eliminating the significant disadvantages of conventional measuring devices such as light sensitivity or short service lives of lamps. The application of electronic components from the new LED generation enables our TinCheck® to indicate the correct result in the alphanumeric display even with the first measurement. Simply press the handy device against the glass pane and push the start button. The display shows your results immediately which remain on the display for a while.



▼ Features

- Innovative tin side tester
- The latest LED technology
- Only one measurement required
- Three display options
- High-durability lamp
- Low energy consumption

Art. No.	Description
BO 5164615	TinCheck®

▶ MERLIN LASER Measuring Tool



For analysing glazed units - laser diode with sophisticated measuring electronics - press the button for instant measurements - precise measurements from only one side (independent of light) - measures glass thickness as well as air gaps of any multi-glazed unit - indicates PVB and resin layers of laminated units - battery-operated - little energy consumption - for coated glass, bullet-proof glass, multi-layered insulating glass, etc.

i Laser class: non-hazardous laser class 2/3a - Material precision-made plastic housing - Warranty 12 months

Art. No.	Scale - Instruction manual
BO 5164701	English - English

▶ Tin Side Detector



For certain applications in glass processing it is necessary to know which side of the glass has been in contact with the tin during float glass production. This is easily achieved with the Bohle tin side detector - especially suitable for use with glass fusing - operated by 4 standard "AA" batteries - includes batteries and instruction manual

Art. No.	Description
BO 5164612	Detector
BO 5164611	Spare bulb for detector

▶ Glass Thickness Gauge



Measures glass thicknesses from 2 to 25 mm as well as the space between panes (up to 24 mm) of insulated glass units - also suitable for already installed windows - works on the basis of reflection in the glass pane

i Material Plastic

Art. No.	Description
BO 5164900	Glass Thickness Gauge
BO 5164901	Private label version with customer logo, one colour
BO 5164902	Private label version with customer logo, two colours

▶ Measuring Device Bohle GlassCheck



GlassCheck is used for measuring the overall glass thickness of already installed glass panes and insulated glass. The device is suitable for measuring glass thicknesses of up to 120 mm. The device also features an integrated glass thickness gauge which offers the possibility of determining the thickness of single glass panes (from 2 - 25 mm). - Please note: - For quantities of 100 or more, available with your personal logo.

i Length 315 mm - Width 270 mm

Art. No.	
BO 5164801	Glass Check

▶ Glass Coating Detector



For detecting and determining the location of low-E coatings on single panes or double glazed units (4-10 mm glass thickness of individual panes). When checking double glazed units, measurements must be taken from both sides in order to determine the exact position of the coating.

Art. No.	
BO 6164805	Glass Coating Detector

▶ MERLIN TGI Toughened Glass Indicator



In leather pouch with battery charger - equipped with rechargeable battery - in no time it shows you whether the glass is toughened or not - also works with insulated glass units

i Material Plastic - Warranty 12 months

Art. No.	
BO 5164601	Merlin TGI
BO 5164601L	Battery charger for Merlin TGI

▶ Corner Protectors



Art. No.	Glass thickness · Bracket length · Colour · Sales unit
BO 5105060	3 - 4 mm · 40 mm · transparent · 100 items
BO 5105061	5 - 6 mm · 47 mm · transparent · 100 items
BO 5105062	8 - 10 mm · 58 mm · transparent · 100 items

▶ Glazing Shovel



Made of plastic · with wooden handle

i Width 66 mm · Length 275 mm

Art. No.	Description
BO 5165400	Glazing Shovel

▶ Glass Scraper



Metal · with blade protection · plastic handle · exchangeable blades · for loosening hardened adhesive residues from glass surfaces · also for hard-to-reach corners · Made in Germany

i Blade width 40 mm

Art. No.	Description
BO 5141000	Glass Scraper

▶ Glazing Shovel



Made of shock-proof plastic · solid · blue · easy-grip handle · especially sturdy · Made in Germany

i Width 74 mm · Length 280 mm

Art. No.	Description
BO 5165301	Glazing Shovel

▶ Knife for Laminated Glass



With single-edged blade · light-coloured wooden handle · for cutting PVB film in laminated glass

i Blade width 40 mm

Art. No.	Description
BO 5141700	Knife for laminated glass

▶ Bohle Premium Glass Cleaner



Ideal for windows, mirrors, windscreens and other glass surfaces · prevents fresh smudging · no streaking · in spray bottles without propellants · biologically degradable · with the purchase of one carton (=12 bottles), 3 spray heads are included · Please note: Not suitable for pre-cleaning before UV bonding! Only for cleaning after bonding! · improved formula with new design

Art. No.	Contents
BO 5107805	Bottle 1 litre
BO 5107806	Bottle 25 litres

▶ Glass Cleaner Bohle Professional



Can be used for glass, smooth plastic surfaces, mirrors, car windows, tiles · for workshop and home, showcases and display windows · sparkling surfaces without streaking · environmentally sound propellant · Ideal for cleaning glass parts after fusing ·

Please note: Not suitable for pre-cleaning before UV bonding! Only for cleaning after bonding! · For quantities of 600 +/- 10%, available with your own label!

Art. No.	Description
BO 5107900	Spray can of 660 ml

▶ Steel Wool



Top quality · long-fibred · tough · good grip · excellent polishing and grinding ability · highly elastic and uniform · easily divisible strands

Art. No.	Description · fineness
BO 5141605	Cardboard roll of 100 g · 00
BO 5141602	Cardboard spool of 5,000 g · 00

▶ Chip BrushFluppi



Glass splinters and other contamination on the cutting table carry the risk not only of scratching the next glass pane, but also of causing injuries. "Fluppi" chip brush is the world's smallest vacuum cleaner and operates without electricity. Simply move the roller brush along the table surface and the splinters are collected in a plastic container. The chip brush works according to the same principle as a large carpet roller brush. After use it can be disassembled quickly and easily for emptying the container. The chip brush is an indispensable helper for an optimum work space - also suitable for cleaning crumbs and for use on carpets, car mats and much more.

Art. No.	
TG 070	Chip Brush

▶ Smoothing Spatula

For smoothing sealed surfaces



i Length 90 mm · Width 90 mm
· Thickness 5 mm · Material Plastic

Art. No.	Description
BO 5166300	Smoothing Spatula

▶ Smoothing Spatula

For smoothing sealed surfaces



i Length 90 mm · Width 90 mm
· Thickness 5 mm · Material Vulkollan

Art. No.	Description
BO 5166301	Smoothing Spatula

▶ PowerGrab Work Gloves



Seamless cotton/polyester fabric · palm and fingertips with blue latex coating · good protection against mechanical risks · for universal use · tested per DIN EN 388 CAT II

i Cut resistance level: 1

Art. No.	Size
BO 5017518	9 / L

▶ Protective Glasses



Panorama glasses · non-slip plastic sport arm, length and slant adjustable · with anti-fog coating · in compliance with EU Directive 89/686/EEC for PPE, type-tested and CE marked · DIN EN166:2002-4

Art. No.	Description
BO 5007614	Protective Glasses

▶ Wrist Protector



Chrome split leather · perforated · with Velcro fastening · borders leather reinforced

i Cut resistance level: 2

Art. No.	Size · Width
BO 5207704	One size · 145 mm

▶ Wrist Protector Sleeves,



KEVLAR® wrist protector sleeves made of knitted material · with thumb hole for good hold · especially good fit and good air circulation · one size

i Total length approx. 300 mm · Cut resistance level: 3

Art. No.	Size
BO 5007509	One size

▶ Work Apron,



Chrome split leather · especially robust quality · with adjustable strap

i Length 60 cm · Width 60 cm · Cut resistance level: 2

Art. No.	Description
BO 5007603	With pocket
BO 5007602	Without pocket

▶ Glazier's Apron



Green · two small pockets for glass cutters and two side pockets · one size

Art. No.	Description
BO 5007605	Glazier's Apron

▶ Tool Kit



In plastic pouch · includes one each of: lipping-out tool, filler tool with replaceable eyes, Allen key, instruction manual for weatherstrip installation

Art. No.	Description · Included in delivery
BO 5312700	Tool Kit
BO 5312901	Guide Loops for Locking Strips · 2 items

▶ Lippping-Out Tool



For mounting windscreens into weatherstrip

Art. No.	Description
BO 5313000	Lippping-Out Tool

▶ Filler Tool



For weatherstrip with replaceable guide loops (8 mm) · with Allen key

Art. No.	Description
BO 5312800	Filler Tool



Cork Protector Pads



Available in dimensions of 16.2 x 17.5 mm, punched on rolls of 10,000 or bulk in boxes of 6,000 (punched foam-on-foam).

Art. No.	Length · Width · Thickness
BO 5105155	16.2 mm · 17.5 mm · 3 mm



Putty Knife



Putty knife, Skew-Point, wood handle

Art. No.	
SA PK30	



Mirror Tape



Art. No.	Size
SA MT181660	18 mm x 1.6 mm x 60 m
SA MT182030	18 mm x 3.0 mm x 30 m
SA MT241660	24 mm x 1.6 mm x 60 m
SA MT243030	24 mm x 3.0 mm x 30 m



Spare Blades



Spare blades, reinforced back

i Width 40 mm · Sales unit 100 items

Art. No.	Description
BO 5141011	for BO 5141000 and BO 5141700



Webbing



i 50 mm x 50 m

Art. No.	Color · Description
SA WEB01	Black · Industrial Strength
SA WEB02	White · Zig-Zag pattern



Glazing Tape



i Color black

Art. No.	Size
BO 5207834	9 mm x 3.0 mm x 15 m
BO 5207835	9 mm x 6.0 mm x 15 m
BO 5207836	12 mm x 3.0 mm x 15 m

XtraCryl



Highly transparent, polyacrylate-based adhesive tape with adhesive on both sides. It has an excellent initial tack, offering a high degree of security shortly after application. XtraCryl shows excellent resistance to ageing, weathering, temperature and solvents and is ideal for bonding rough materials as well as for permanently bonding glass, metal, mirrors as per DIN EN 1036 and many plastics. Stresses in the adhesive bond are reduced and the strength of the bond increases greatly over time. We particularly recommend XtraCryl for mounting laminated safety glass mirrors and when bonding cast resin panes. · Technical data: Peel strength*: steel up to 45N/25mm · glass up to 43N/25mm Shear strength**: up to 45N/625 mm² at 20°C · up to 15N/625 mm² at 70°C Temperature range: -40°C to +120°C, for short periods of time up to +150°C Shelf life: 12 months (room temperature 20°C, humidity 50 %) (According to AFERA *4001, **4012, depending on thickness, technical data can vary slightly - please request our data sheet.)

Art. No.	Width · Thickness · Length
BO 5207740	6 mm · 1,0 mm · 25 m

Domehead Mirror Screws



Chrome domeheads with steel screws, boxed in 200's. Mirror plugs/top hats to suit glass from 3 mm to 6 mm, 6 mm or 7 mm ø hole required. Also available in brass or flat heads.

Art. No.	Threaded pin
BO 6003216	20 mm
BO 6003217	25 mm
BO 6003218	30 mm
BO 6003219	40 mm
BO 6003220	50 mm

Resilient Pads



All resilient pads are made from aliphatic polyurethane material with high quality UV stabilisers and offer a 5-year guarantee against yellowing · A universal weatherproof and dishwasher safe acrylate adhesive is used as standard adhesive.

❗ ø 8 mm · Height 2,2 mm · Colour: crystal clear · Version self-adhesive · On sheets · Description Made in Germany

Art. No.	Sales unit
BO 5200172	bag of 480 items

Resilient Pads



All resilient pads are made from aliphatic polyurethane material with high quality UV stabilisers and offer a 5-year guarantee against yellowing · A universal weatherproof and dishwasher safe acrylate adhesive is used as standard adhesive.

❗ ø 12 mm · Height 3,2 mm · Colour: crystal clear · Version self-adhesive · On sheets · Description Made in Germany

Art. No.	Sales unit
BO 5200174	bag of 264 items

Grommets



For avoiding direct contact between wood screw and mirror when using mirror screws · sales unit = 100 items

❗ Drill hole in glass ø 7 mm

Art. No.	Description
BO 5200988	Protective Sleeve

Mirror Fixation Kits and Accessories

SafecliX® - SafemaX® - SafefiX® have been developed for vertical mounting of mirrors per DIN EN 1036. Our sets are supplied with all necessary mounting hardware in neutral packaging. After mounting they are hidden from sight behind the mirror and allow the mirror to be detached at any time. All metal mounting plates in our mirror fixing kits are coated with the specially developed Xtramount® mirror adhesive tape and are therefore suitable for humid rooms as well as outdoor applications, as long as they are not directly exposed to rain and they stay within the allowable temperature range for Xtramount®. SafecliX® - SafemaX® - SafefiX® offer you many different ways to mount your mirrors securely. If you need special mirror mounting sets for your particular application, or if you wish an own brand label version of SafecliX® - SafemaX® - SafefiX®, please do not hesitate to contact us.

Mirror Adhesive Xtragrip®



Silicone sealants in various colours are available from Bohle

Solvent-free, neutral, silicone-based single-component adhesive (oxime-free). Intended for stress-compensating mirror bonding onto wood, concrete, stone, glass, metal, etc. Porous surfaces must first be treated with a primer. Not suitable for force-fit connections. Xtragrip® is easy to work with, stays permanently elastic, and does not corrode the mirror coating. Technical data: Basis: polysiloxane (oxime-free) Consistency: stable paste Curing system: polymerisation by humidity Skin formation: approx. 10 min. (+20°C and 65% rel. humidity) Curing speed: 1 mm / 24 h. (+20°C and 65% rel. humidity) Density: 1.36 Thermal stability: -50°C to +120°C

Art. No.	Description
BO 6002005S	Xtragrip®

SafecliX® 08

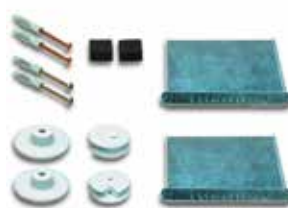

Press button set, for mirrors up to 0.8 m² · resting time only 30 minutes · suitable for humid environments and suitable to a limited extent for exterior applications · suitable for mirrors according to DIN EN 1036 · shelf life of 12 months from the date of delivery note

i Mirror surface max. 0,8 m² · Mirror glass thickness 6 mm

Included in delivery:

2 items lipped plates 100 x 100 mm with Xtramount® mirror adhesive tape
2 items eccentric discs
2 items press buttons
2 items Spacers
2 items countersunk and 2 buttonhead screws ø 4 x 50 mm
4 items plugs ø 6 x 36 mm

Art. No.	Description
BO 5208210	SafecliX® 08

SafecliX® 16

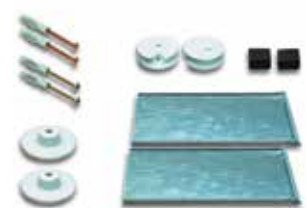

Press button set, for mirrors up to 1.6 m² · resting time only 30 minutes · suitable for humid environments and suitable to a limited extent for exterior applications · suitable for mirrors according to DIN EN 1036 · shelf life of 12 months from the date of delivery note

i Mirror surface max. 1,6 m² · Mirror glass thickness 6 mm

Included in delivery:

2 items lipped plates 200 x 100 mm with Xtramount® mirror adhesive tape
2 items eccentric discs
2 items press buttons
2 items Spacers
2 items countersunk and 2 buttonhead screws ø 4 x 50 mm
4 items plugs ø 6 x 36 mm

Art. No.	Description
BO 5208211	SafecliX® 16

SafecliX® 26



Press button set, for mirrors up to 2.6 m² · resting time only 30 minutes · suitable for humid environments and suitable to a limited extent for exterior applications · suitable for mirrors according to DIN EN 1036 · shelf life of 12 months from the date of delivery note

i Mirror surface max. 2,6 m² · Mirror glass thickness 6 mm

Included in delivery:

3 items lipped plates 200 x 100 mm with Xtramount® mirror adhesive tape
3 items eccentric discs
2 items press buttons
4 items Spacers
3 items countersunk and 2 buttonhead screws ø 4 x 50 mm
5 items plugs ø 6 x 36 mm

Art. No.	Description
BO 5208212	SafecliX® 26

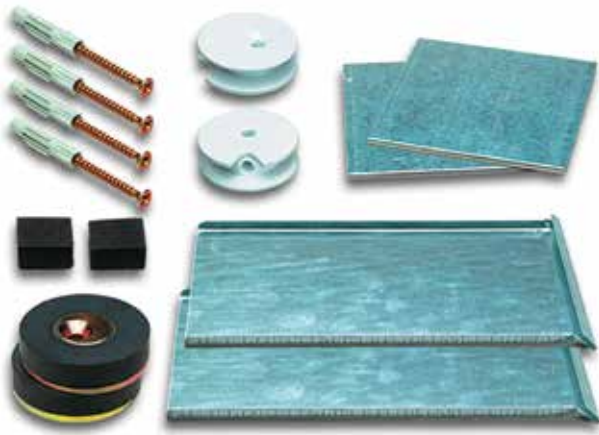

Magnetic set, for mirrors up to 1.6 m² · resting time only 30 minutes
· suitable for humid environments and suitable to a limited extent for exterior applications · suitable for mirrors according to DIN EN 1036 · shelf life of 12 months from the date of delivery note

i Mirror surface max. 1,6 m² · Mirror glass thickness 6 mm

Included in delivery:

2 items lipped plates 200 x 100 mm with Xtramount® mirror adhesive tape
2 items metal plates 70 x 70 x 2 mm with Xtramount® mirror adhesive tape
2 items eccentric discs
2 items magnets ø 45 mm
2 items Spacers
4 items screws ø 4 x 50 mm
4 items plugs ø 6 x 36 mm

Art. No.	Description
BO 5208230	SafemaX® 16



Grinding · Drilling · Sawing

Bohle offers a large range of stationary and mobile glass processing machines and manual tools for glass grinding, drilling and sawing. Comprehensive accessories as well as consumables complete the Bohle product range.



04

Grinding · Drilling · Sawing

▶ Multi-Purpose Sander Makita 9031



For dry edging and arissing of glass and similar materials · infinitely adjustable · easy use in difficult-to-reach spots due to removable swivelling handle · long gliding shoe for even grinding

i Output 230 V / 50 Hz / 550 W · Belt speed 4 - 15 m/s · Belt size 30 x 533 mm · Weight 2,1 kg

Art. No.	Description
BO 5300300	Multi-purpose sander
BO 5300302	Gliding shoe

▶ Cork Polishing Belts



Waterproof · for polishing of already ground glass edges · Klingspor CS 322

Art. No.	Length · Width
BO 5053301K	533 mm · 30 mm
BO 5018301K	1830 mm · 100 mm
BO 6026901N	2690 mm · 100 mm

▶ Silicon Carbide Abrasive Belts



When grinding glass, a milky, dull finish is produced · good abrasive capacity · good service life · for universal use

i Length 1830 mm · Width 100 mm

Art. No.	Grit
BO 5018308	80
BO 5018312	120
BO 5018315	150
BO 5018322	220
BO 5018332	320
BO 5018340	400

▶ Silicon Carbide Abrasive Belts



When grinding glass, a milky, dull finish is produced · good abrasive capacity · good service life · for universal use

i Length 533 mm · Width 30 mm

Art. No.	Description · Grit
BO 5053306	SIC abrasive belt · 60
BO 5053308	SIC abrasive belt · 80
BO 5053312	SIC abrasive belt · 120
BO 5053322	SIC abrasive belt · 220
BO 5053340	SIC abrasive belt · 400

▶ Silicon Carbide Abrasive Belts



When grinding glass, a milky, dull finish is produced · good abrasive capacity · good service life · for universal use

i Length 2690 mm · Width 100 mm

Art. No.	Grit
BO 6026906	60
BO 6026908	80
BO 6026912	120
BO 6026922	220
BO 6026940	400

▶ Compact Grain Abrasive Belts



Long service life (approx. 3 times as long as standard belts) · uniform abrasive capacity and grinding quality over entire life of the belt

i Length 1830 mm · Width 100 mm

Art. No.	Grit
BO 5118318	180
BO 5118324	240
BO 5118340	400

▶ Trizact™ Grinding and Polishing Belts



Structured small pyramids with finest aluminium oxide · when grinding, new abrasive particles are exposed · smooth, even results · quiet · better polishing, less contamination · uniform performance · strong grinding with little grinding pressure · fewer work steps · shorter processing time

Art. No.	Description · Colour · Length · Width
BO 5017805	Polishing belt, A5 · brown · 1830 mm · 100 mm
BO 5017835	Abrasive belt, A35 · green · 1830 mm · 100 mm
BO 5053305	Polishing belt, A5 · brown · 533 mm · 30 mm
BO 5053335	Abrasive belt, A35 · green · 533 mm · 30 mm

▶ Glass Marking Crayon



Suitable for wet glass · comes off in washing machine · no danger of corrosion

i Colour white · Packaging unit 10 items

Art. No.
BO 5007400

▶ Paint Marker



Plastic tip in metal housing · shake well before use

i Colour: white · Feature: waterproof

Art. No.	Line width
BO 5007909	0,8 mm
BO 5007910	2 - 4 mm

▶ Pico Drill with Table



Professional starter machine with table W 1350 x D 890 mm, adjustable stoppers for precise positioning, including drilling templates as glass support.

i Working height 960 mm

Art. No.	Description
BO 79.260	Pico Drill 100 T with table W 1350 x D 890 mm, working height 960 mm, 230 V / 50-60 Hz

▶ Pico Drill 100 Drilling Machine



This robust, portable precision drilling machine for diamond core drills is produced by Bohle. It is very well suited for use on-site as well as in the workshop. The machine is placed directly on top of the glass, a rubber ring prevents it from slipping. Integrated suction holders provide for even safer fixing on the glass and form part of the standard machine equipment. Coolant is supplied directly into the hollow drill through the adjustable supply valve. Lowering the drills is done by a very precise and smooth mechanism that also has a depth stopper. The machine comes with an integrated PRCD safety switch and can be plugged directly to a Schuko plug. The Pico Drill 100 L model includes a point laser which greatly facilitates the positioning of the machine on the glass.

i Technical Data: · Electrical connection 1,15 KW, 230 V, 50 - 60 Hz, 1NPE · Drill diameters max. 75 mm · Drill depth max. 20 mm · Weight 12,5 kg

Art. No.	Description
BO 79.200	Pico Drill 100, 230 V / 50-60 Hz
BO 79.200L	Pico Drill 100 L with point laser, 230 V / 50-60 Hz
BO 79.210	Laser for Pico Drill 79.200, 79.201, 79.200L and 79.201L

▶ Pico Drill 100 T Tabletop Drilling Machine



Portable tabletop glass drilling machine with stainless steel coolant collecting tray and insert rings · suitable for table BO 79.270 · see Pico Drill 100 for technical data · Manufactured by Bohle in Germany

i Reach 430 mm · Width 490 mm · Height 590 mm · Depth 830 mm

Art. No.	Description
BO 79.250	Pico Drill 100 T Tabletop Drilling Machine, 230 V / 50-60 Hz
BO 79.270	Supplemental table with stoppers for Pico Drill 100 T · B 1350 x T 890 x H 960 mm

▶ Diamond Core Drills, Standard Quality



For normal use · drill base made of steel · covered with protective lacquer · diamond coating from sintered material · drill has to be sharpened before first use

i Belgium Shank 3/4" (19 mm across the flat) · Habit Shank 1/2" (12 mm across the flat)

Please confirm shank size when placing order!

Art. No.	Diameter · Length
BO 5000404	4 mm · 75 mm
BO 5000405	5 mm · 75 mm
BO 5000406	6 mm · 75 mm
BO 5000407	7 mm · 75 mm
BO 5000408	8 mm · 75 mm
BO 5000409	9 mm · 75 mm
BO 5000410	10 mm · 75 mm
BO 5000411	11 mm · 75 mm
BO 5000412	12 mm · 75 mm
BO 5000413	13 mm · 75 mm
BO 5000414	14 mm · 75 mm
BO 5000415	15 mm · 75 mm
BO 5000416	16 mm · 75 mm
BO 5000417	17 mm · 75 mm
BO 5000418	18 mm · 75 mm
BO 5000419	19 mm · 75 mm
BO 5000420	20 mm · 75 mm
BO 5000422	22 mm · 75 mm
BO 5000423	23 mm · 75 mm
BO 5000424	24 mm · 75 mm
BO 5000425	25 mm · 75 mm
BO 5000426	26 mm · 75 mm
BO 5000427	27 mm · 75 mm
BO 5000428	28 mm · 75 mm
BO 5000430	30 mm · 75 mm
BO 5000432	32 mm · 75 mm
BO 5000434	34 mm · 75 mm
BO 5000435	35 mm · 75 mm
BO 5000436	36 mm · 75 mm
BO 5000437	37 mm · 75 mm
BO 5000438	38 mm · 75 mm
BO 5000440	40 mm · 75 mm
BO 5000442	42 mm · 75 mm
BO 5000445	45 mm · 75 mm
BO 5000446	46 mm · 75 mm
BO 5000448	48 mm · 75 mm
BO 5000450	50 mm · 75 mm
BO 5000452	52 mm · 75 mm
BO 5000455	55 mm · 75 mm
BO 5000458	58 mm · 75 mm
BO 5000460	60 mm · 75 mm
BO 5000461	61 mm · 75 mm
BO 5000465	65 mm · 75 mm
BO 5000470	70 mm · 75 mm
BO 5000475	75 mm · 75 mm
BO 5000480	80 mm · 75 mm
BO 50004100	100 mm · 75 mm

Precision Drill Extension



For R 1/2" diamond hollow drills
- ranging from 75 mm to 95 mm ·
industrial quality, stainless steel

Art. No.

BO 5000504

Adaptor - Belgium to Habit



For use with R 1/4" diamond
hollow drills to convert to 1/2"
thread

Art. No.

BO 5000502

Adaptor - Habit to Belgium



Art. No.

BO 5000503

Water Feed Jacket



With MK2 morse taper · for
diamond hollow drills with 1/2"
thread · fits drill stands

i Spanner 32 mm

Art. No.

BO 79.12

Water jacket complete with morse taper shank arbor and spanner

Diamond Countersinks



i Outer thread (Continental)
R 1/2 " · Length 75 mm

Art. No.	Diameter
BO 5000535	35 mm
BO 5000545	45 mm
BO 5000565	65 mm

Diamond Countersink



Diamond countersink, hand held,
40 mm

Art. No.

SA DCS40

Dressing Stone for Diamond Drills



Removes used particles and creates a new cutting edge · after using
the dressing stone, sharpen the drill with sharpening stone BO 5000499
· when drills are operated with little forward feed, no self-sharpening
process takes place and the diamond particles turn blunt

i Length 100 mm · Width 25 mm · Height 13 mm

Art. No.

BO 5000498

Cordless Glass Saw



New model for quick and precise cuts · very lightweight and easy to handle (net weight 1.7 kg)

i Cutting depth max. 25.5 mm · Angle adjustment up to 16.5 mm 45° · No-load speed 1400 rpm · Total length 300 mm

Included in delivery:

2x Li-ion Block Batteries, 1.3 Ah
1x Battery Charger
1x Water Tank
1x Diamond Saw Blade ø 85 mm

Art. No.	Description · Version · Thickness
BO 5300110	Cordless Glass Saw
BO 5300112	Makita Diamond Saw Blade ø 85 mm · especially suitable for white glass and tile cutting

Scratch-A-Way, Electrical



Manual Edge Coating Deleter



Electrical edge coating deleter for Low-E glass · for glass with straight or shaped edges · guided along the glass edge with stopper rollers · manual grinding pressure and forward feed · 1200 - 3700 rpm · 1200 W · 230V / 50Hz

i Size Abrasive Wheels
125 x 10 x 76,2 mm · Please note: Supplied without grinding disc.

Art. No.	
BO 89.110	Manual Edge Coating Deleter

Abrasive Wheels



For edge coating deleter BO 89.100 / BO 89.110 and other makes · suitable for the most popular Low-E soft coatings · on request also possible for modified glass coatings and further pane dimensions · New at Bohle Norton Beartex: Especially flexible grinding fleece with outstanding abrasive properties; gentle to coating removal drive motors of cuttings plants.

Art. No.	Type · Outer diameter · Thickness · Bore hole
BO 5042001	MT · 125 mm · 10 mm · 76,2 mm ·
BO 5042003	HT · 125 mm · 10 mm · 76,2 mm ·
BO 5042005	Elastic · 125 mm · 10 mm · 76,2 mm ·

i Version electrical · Output 150 W · Speed 5000 - 9500 rpm · Polishing disc 45 mm Ø · Insulation / safety according to EN50144 / HD 400.1 + HD 400.2 · Weight 1,5 kg

Art. No.	Voltage
BO 5300900	230 V

Rubber Collar

For Scratch-A-Way BO 5300900



Art. No.	
BO 5300906	

Carbon Brushes



Suitable for Scratch-A-Way electric models · Set of 2

Art. No.	For
BO 5300908	BO 5300900
BO 5300909	BO 5300901

▶ Polishing Gel containing Cerium



Cero-Gel is a high quality polishing agent based on cerium oxide. It excels due to the amount of dirt and grime it removes and the high brilliance of polished surfaces. Cero-Gel was especially developed for the window and glass industry. Hairline scratches, the first signs of glass corrosion or stains caused by cement, concrete or silicone can be easily removed in this way. Cero-Gel can be applied using the Bohle felt polishing wheel BO 5007901 together with a cordless drilling machine or, for larger surfaces, the Flex glass polisher BO 5300809 together with felt disc BO 5300811. For final polishing, we recommend Radora Brillant BO 5008003 or simply clean with water.

i Contents 100 ml · Please note: The optimum polishing temperature of the glass surface lies between + 50° and + 60° C. In order to avoid partial overheating or even breaking of glass, the corresponding area should be cooled with clear tap water, e.g. from a spray bottle, during polishing.

Art. No.

BO 5008004	Polishing Gel containing Cerium
------------	---------------------------------

▶ Cerium Polishing Powder



For removing small scratches or "blind" areas on glass in conjunction with a felt polishing wheel · mix polishing compound with water to form a paste and apply to glass surface · carefully polish with felt polishing wheel BO 5007901 · FOR STRAIGHT LINE EDGERS AND FLAT BEVELLING

Art. No.

BO KF15001	
------------	--

▶ Abrasive Diamond Hand Pad "Diapad"



Flexible grinding area · smooths and grinds glass edges, ceramic and granite · can be used wet or dry

i Length 90 mm · Width 55 mm · Height 27 mm

Art. No.

Grit · Colour

BO 5007912	120 / N 125 · black
BO 5007922	220 / N 74 · red
BO 5007936	360 / N 40 · yellow

▶ Hand Seaming Tool



Smooths both sides of glass edges simultaneously · prevents injuries

i Grit 100

Art. No.

Description

BO 5007300	Hand Seaming Tool
BO 5007301	Replacement stones

▶ Felt Polishing Wheel



With bonded shaft ø 6 mm · for removing small scratches or "blind" areas on glass in connection with polishing compound

i Diameter 80 mm · Thickness 30 mm · Colour white

Art. No.

BO 5007901	
------------	--



Surface Protection

With BriteGuard® (www.BriteGuard.com), Bohle's revolutionary protection product for glass and glazed ceramic surfaces, is both extremely wear resistant and durable. Further, the application process is simple and can be done either manually or mechanically. Another advantage is that the BriteGuard® system requires a minimal number of products and can easily be applied, either manually or mechanically. Once again, Bohle offers a

highly attractive business opportunity for glass processing companies. In addition to high quality glass products they can supply their customers with a high perceived value surface protection system developed for professional use without expensive application equipment and complex and time-consuming product training.



05 | Surface Protection

▶ BriteGuard® Express



Protect your showers quickly and easily before mounting with BriteGuard® Express. The coated glass surface is protected immediately and can be cleaned easily. In this way your customer will enjoy a high quality shower for a long time. Its use is as easy as can be. The special liquid is simply applied evenly onto the clean glass surface and is wiped off again with a suitable cloth. The only thing you have to be aware of is to moisten surfaces completely and evenly. The protective effect is activated immediately. The one-step product is appropriate for interior and exterior application. It can be used as efficiently on glass showers and partitions as on conservatory roofs. · Quick protection for all smooth glass surfaces · Simple application - clean the glass pane, apply BriteGuard® Express uniformly with a spray bottle and polish. · The surface becomes hydrophobic immediately (water drips off) · The glass remains protected & easy to clean for several months · Can be reapplied at any time · For professional requirements and for use at home · 500 ml bottle with spray head · Shelf life in original packaging: 12 months from the date of manufacture

Art. No.	Contents
BO 5850050	500 ml

▶ BriteGuard® Limescale Remover



Limescale remover for professional use or standard use at home · Can be reapplied at any time · 500 ml bottle with spray head · Spray BriteGuard® Limescale Remover onto the surface and allow to take effect shortly to be then removed with a clean towel. · Suitable for pre-cleaning before using BriteGuard® Express

Art. No.	Contents
BO 5880500	500 ml





BriteGuard® Surface SEALER X



Surface SEALER X was specially developed for rough surfaces. This can be glass that is satin finished or sandblasted. · Together with the 0.5 litre bottle, spray head BO 5107810 is included in the delivery · Please note: 5 l containers can only be shipped outside Germany via a forwarding agent. · Shelf life in original packaging: 12 months from the date of manufacture · Hazmat item-please note this cannot be shipped via Air - only Ground shipment is available

i Please note: The material is only suitable to a limited extent for exterior applications. If you have questions, please contact our application technicians.

Art. No.	Contents
BO 5820500	0,5 litre



Special Cleaning Cloth



Made of cotton · for drying glass surfaces

Art. No.	
BC 5052300	Special Cleaning Cloth



Cotton Pads

Pure cotton pads



Art. No.	Length · Width · Contents
BO 5052065	8 cm · 10 cm · 20 items



Glass Bonding

Glass bonding technology has developed in recent years to become an integral, state of the art form of technology in the glass processing industry. As a result, demands from both the glass processing industry and the individual glaziers' shops are constantly increasing. Bohle offers everything you need for the perfect bond. Apart from its long-standing experience of 25 years in glass

bonding, the company also falls back on one of the world's largest product ranges, with all the technology you need, bringing obvious advantages for your business: for example, multiple design possibilities, short processing times and low equipment expenses. Open up new fields of business and broaden your offers.



08 | Glass Bonding

▶ Glass Bonding Table



The Verifix® glass bonding table is available in 3 different versions, depending on the accessories. The basic version (BO 5590100) includes the bonding table, a 90° lamp holder, two holding devices and a Verifix® Pro 90° angle suction holder set which enables carrying out 90° bonds safely and easily. The glass bonding table for 45° / 90° bonds (BO 5590200) is ideal for both bonding types. Apart from the basic table, the set contains two lamp holders which are suitable both for 45° mitre bonds and 90° bonds, two holding devices for fixing the glass panes, two 45° mitre stops and a Verifix® Pro 45° angle suction holder set. The Deluxe version (BO 5590300), in addition to the accessories for BO 5590200, includes a Verifix® Pro 90° angle suction holder set and a "Star Light" and a "Long Light XL" UV lamp. This comprehensive set is suitable both for 45° and 90° bonds.

i Length 182 cm · Width 93 cm · Height 90 cm



Art. No.	Version
BO 5590200	Verifix® Glass Bonding Table 45° / 90°

Specifications	BO 5590200
Verifix® Basic Glass Bonding Table (BO 5590000)	1 item
Verifix® Lamp Holder 90° (BO 5591000)	
Verifix® Lamp Holder 45° / 90° (BO 5591100)	2 items
Verifix® Holding Device (BO 5591200)	2 items
Verifix® Mitre Stop 45° (tabletop version) (BO 5591300)	2 items
Verifix® Pro Angle Suction Holder 45° (BO 639.3)	1 Set
Verifix® Pro Angle Suction Holder 90° (BO 639.1)	
UVA-Star "Light", 230 volts (BO 5209470)	
UVA-Star "Long Light XL" (BO 5209476)	

▶ Pyrosil® Basic Kit for Silicate Treatment



For improved adhesive strength for UV bonds on problematic surfaces · kit contains a burner with piezoelectric firing, 50 ml bottle of coupling agent, 27.5 g gas refill cartridge · size of flame adjustable · contents are sufficient for pre-treating approx. 3000 cm² of bonding surface · The flame burner is supplied empty.

Art. No.	Description
BO 5209490	Pyrosil® Basic Kit

▶ Pyrosil® Accessories



Hazmat item-please note this cannot be shipped via Air - only Ground shipment is available

Art. No.	Contents
BO 5209494	50 ml
BO 5209498	250 ml
BO 5209499	1000 ml

▶ Positioning Device



For the correct position of the lock, we recommend our positioning device - the lock is placed onto the set device and securely bonded with the glass

Art. No.	
BO 633.5	

▶ Pyrosil® Professional Kit for Silicate Treatment



For improved long-term adhesion of challenging bonds. Especially suitable for regular use under industrial conditions, this kit has a larger burner with more contents, robust operating elements and a support base. This kit contains a burner with piezoelectric firing, 2 x 27.5 g gas cartridges, 2 x 50 ml of coupling agent and an application brush. Contents are sufficient to pre-treat approx. 10,000 cm² of bonding surface. · The flame burner is supplied empty.

Art. No.	Description
BO 5209491	Pyrosil® Professional Kit

▶ Verifix® Pro angle suction holder



The Verifix® Pro angle suction holder is a high quality product topping the list of positioning and fixing devices for glass bonding. Especially in the case of UV bonds, as is common in glass furniture or showcase construction, Verifix® Pro offers superior protection against vibration and slipping - both for corner and T-joints. · Exact adjustment of the bonding gap (= thickness of adhesive layer) · extremely sturdy

ⓘ Height 176 mm · Depth 160 mm · Suction pad 110 mm Ø

Art. No.	Description
BO 639.1	Verifix® Pro Angle Suction Holder 90°

▶ Verifix® Eccentric Suction Stopper

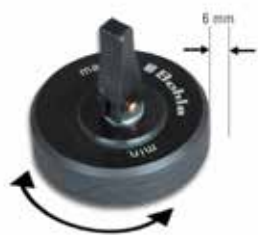

Eccentrically arranged, flat plastic disc · suitable for small parts for universal adjusting of sheet materials · ideal for use when bonding floors or shelves in display cabinets · can be used individually or in pairs as precisely adjustable straight edge holder

i Height 20 mm · Adjustment range 6 mm

Art. No.	Inside · Outside · Description
BO 637.2	36,5 mm Ø · 47,5 mm Ø ·
BO 637.6	Spare Suction Pad for BO 637.2
SP 5280.55	Rubber Coated Iron Plate with Naps

▶ Verifix® Eccentric Suction Stopper



Eccentrically arranged, flat plastic disc · integrated suction pad · suitable for use when bonding floors or shelves in display cabinets · can be used individually or in pairs as precisely adjustable straight edge holder

i Height 20 mm · Adjustment range 6 mm

Art. No.	Inside · Outside · Description
BO 637.1	55 mm Ø · 70 mm Ø
BO 637.5	Spare Suction Pad

▶ Bohle Special Cleaner



Ideal for preliminary cleaning prior to glass bonding or sealing. The Bohle Special Cleaner cleans and degreases glass, metal, ceramic and rubber. The special composition of the cleaner ensures very thorough cleaning. · Particularly suitable for use with UV adhesives · Hazmat item-please note this cannot be shipped via Air · only Ground shipment is available

Art. No.	Contents · incl.
BO 5107910	Atomiser, refillable 0,25 litre · Spray Head
BO 5107911	Refill 1 litre

▶ Metal Primer



For improved adhesion on aluminium, chrome or nickel-plated surfaces · for bonding with acrylate adhesives · Shelf life in original packaging: 12 months from the date of manufacture · Hazmat item-please note this cannot be shipped via Air · only Ground shipment is available

Art. No.	Contents
BO 5209488	100 g
BO 5209489	1000 g

▶ Activator LF



This activator allows the curing of Verifix® B 682-T UV adhesive where it is not possible under normal circumstances using UVA radiation, e.g. with coloured glass, screen printed glass, laminated safety glass, metal/metal bonds, etc. When activator is used, slight yellowing of the bond can occur. · Using an additional UV lamp is not required. · Shelf life: 6 months

Art. No.	Contents
BO 5209365	9 ml
BO 5209367	50 ml

▶ Verifix® UV Adhesive MV 760



i Viscosity: medium 1500 mPas · Shear strength: 25 MPa · Bondline gap: 0,08 - 0,5 mm · Max. allowable continuous temperature: 70 °C · Temperature range: -40 - +120 °C · Colour: crystal clear · Capillary characteristics: none · Compensation of tension: limited · Impact resistant: yes · Suitable for use with activator: no · Vibration absorbing: yes · Moisture resistance: yes · UVA curing: yes · Light curing: no · Construction: open and closed

Art. No.	Contents
BO MV76010	100 g

▶ Verifix® UV Adhesive MV 760VIS



i Viscosity: medium 1500 mPas
 · Shear strength: 25 MPa · Bondline gap: 0,08 - 0,5 mm · Max. allowable continuous temperature: 70 °C · Temperature range: -40 - +120 °C · Colour: crystal clear · Capillary characteristics: none · Compensation of tension: limited · Impact resistant: yes · Suitable for use with activator: no · Vibration absorbing: yes · Moisture resistance: yes · UVA curing: yes · Light curing: yes · Construction: open and closed

Art. No.	Contents
BO MV76V10	100 g

▶ Verifix® UV Adhesive LV 740



i Viscosity: low 80 mPas · Shear strength: 17 MPa · Bondline gap: 0,04 - 0,2 mm · Max. allowable continuous temperature: 70 °C · Temperature range: -40 - +120 °C · Colour: crystal clear · Capillary characteristics: very good · Compensation of tension: limited · Impact resistant: no · Suitable for use with activator: no · Vibration absorbing: limited · Moisture resistance: yes · UVA curing: yes · Light curing: no · Construction: open and closed

Art. No.	Contents
BO LV74010	100 g

▶ UV Adhesive Verifix® B 665-0



UV curing · thin and crystal clear · good capillary action · for bonding glass to glass · low viscosity · time-saving · not waterproof over time · Shelf life in original packaging: 12 months from the date of manufacture

i Viscosity: low 80 mPas · Shear strength: 23 MPa · Bondline gap: 0,04 - 0,2 mm · Max. allowable continuous temperature: 50 °C · Temperature range: -40 - +120 °C · Colour: crystal clear · Capillary characteristics: very good · Compensation of tension: no · Impact resistant: no · Suitable for use with activator: no · Vibration absorbing: no · Moisture resistance: no · UVA curing: yes · Light curing: no · Construction: open and closed

Art. No.	Contents
BO 5209300	100 g

▶ Verifix® UV Adhesive LV 740VIS



i Viscosity: low 80 mPas · Shear strength: 17 MPa · Bondline gap: 0,04 - 0,2 mm · Max. allowable continuous temperature: 70 °C · Temperature range: -40 - +120 °C · Colour: crystal clear · Capillary characteristics: very good · Compensation of tension: limited · Impact resistant: no · Suitable for use with activator: no · Vibration absorbing: limited · Moisture resistance: yes · UVA curing: yes · Light curing: yes · Construction: open and closed

Art. No.	Contents
BO LV74V10	100 g

▶ UV Adhesive B 682-T



Cures either by UV light or with activator · medium viscosity · transparent · especially for glass / metal bonding · Shelf life in original packaging: 12 months from the date of manufacture

i Viscosity: medium 900 mPas · Shear strength: 26 MPa · Bondline gap: 0,09 - 0,5 mm · Max. allowable continuous temperature: 50 °C · Temperature range: -40 - +140 °C · Colour: transparent · Capillary characteristics: none · Compensation of tension: limited · Impact resistant: yes · Suitable for use with activator: yes · Vibration absorbing: yes · Moisture resistance: no · UVA curing: yes · Light curing: no · Construction: open and closed

Art. No.	Contents
BO 5209394	100 g

▶ Verifix® UV adhesive 420 VIS



i Viscosity: medium 300 mPas · Shear strength: 6 MPa · Bondline gap: 0,07 - 0,2 mm · Max. allowable continuous temperature: 50 °C · Temperature range: -55 - +120 °C · Colour: crystal clear · Capillary characteristics: limited · Compensation of tension: very good · Impact resistant: no · Suitable for use with activator: no · Vibration absorbing: yes · Moisture resistance: no · UVA curing: yes · Light curing: yes · Construction: closed

Art. No.	Contents
BO 420V110	100 g

▶ UV Adhesive B 690-0



Due to its exceptional elasticity, this UVA curing adhesive is ideal for bonding different material combinations and surfaces of up to 1 m². · Shelf life in original packaging: 12 months from the date of manufacture

i Viscosity: medium 600 mPas · Shear strength: 9 MPa · Bondline gap: 0,06 - 0,3 mm · Max. allowable continuous temperature: 50 °C · Temperature range: -40 - +100 °C · Colour: crystal clear · Compensation of tension: very good · Impact resistant: no · Suitable for use with activator: no · Vibration absorbing: high · Moisture resistance: yes · UVA curing: yes · Light curing: no · Construction: closed · Viscoelastic properties: elastic

Art. No.	Contents
BO 5209370	85 g

▶ UV Adhesive Verifix® B 678-0 "Lamifix"



This UV-curing adhesive has a relatively thin consistency and is crystal clear · for glass thicknesses up to 6mm · due to its high sensitivity to UV light, it is ideal for bonding laminated glass to: glass, laminated glass, metal, wood, stone as well as to many thermoplastics · Shelf life in original packaging: 12 months from the date of manufacture

i Viscosity: medium 600 mPas · Shear strength: 9 MPa · Bondline gap: 0,06 - 0,3 mm · Max. allowable continuous temperature: 50 °C · Temperature range: -40 - +100 °C · Colour: crystal clear · Compensation of tension: very good · Impact resistant: no · Suitable for use with activator: no · Vibration absorbing: high · Moisture resistance: yes · UVA curing: yes · Light curing: yes · Construction: closed · Viscoelastic properties: elastic

Art. No.	Contents
BO 5209360	85 g

▶ Application Needle Set with Adaptor



Set of one adaptor with 5 application needles

i Diameter 0,33 · 0,41 · 0,58 · 0,84 · 1,37 mm

Art. No.	Description
BO 5209319	Application Needle Set with Adaptor

▶ Application Needles



For UV adhesives · for use with adaptor BO 5209320 only

Art. No.	Colour · Diameter · For adhesive
BO 5209304	orange · 0,33 mm · B 665-0 / LV 740 / LV 740 VIS
BO 5209305	blue · 0,41 mm · B 665-0 / LV 740 / 420 VIS / LV 740 VIS
BO 5209306	pink · 0,58 mm · B 678-0 / B 690-0
BO 5209308	amber · 1,37 mm · B 682-T / MV 760 / MV 760 VIS

▶ Needle Adaptor



Fits all Bohle UV adhesive bottles (except for 1 litre container)

Art. No.	Description
BO 5209320	Needle Adaptor

▶ Application Brush



Soft · for activator and thin adhesive · suitable for all dispensing systems

Art. No.	
BO 5209399	Application Brush



Processing Guidelines for Glass Bonding with UV Adhesives

1. Material selection (suitability of the adhesive):

The material selection and the subsequent selection of the appropriate adhesive (see point 3) results in different mechanical strength properties of the bond. For technical data of our Verifix® bonding portfolio, please see the preceding pages. All specifications relate to transparent, UVA light translucent float glasses. Transparent float glass, mirrors (on the visible side), tempered glass and plate wired glass can be bonded without any difficulty. Special types of glass can lead to reduced mechanical strength properties or cannot be bonded. All types of structured glass are problematic, such as ornamental glass or wired glass. The UVA light translucency depends, among other things, on glass thickness and colour intensity. Important: Glass with a high UV absorption rate, such as laminated safety glass and coloured glass, cannot be bonded with standard UV adhesives. The following highly photosensitive Bohle Verifix® adhesives are suitable for this purpose: MV 760VIS, LV 740VIS or Lamifix 678 and 682-T with activator. Please note: The indicated strength values can be reached within the corresponding layer thicknesses mentioned above. Excessive, too thin or irregular adhesive layer thicknesses have an adverse effect on bonding strength. Extensive tests have shown that stainless steel is especially suitable for bonding glass to metal.

2. Pre-treatment of bonding surfaces

2.1 Cleaning

- The surfaces to be bonded must be completely clean and free of dust and grease (free of separating agents). Use a cleaning agent that is suitable for UV bonding (free from surfactants or separating agents).
- Standard glass or household cleaners are not suitable in most cases.
- Recommendation: Bohle special cleaner for glass bonding, art. no. BO 5107910.

2.2 Removing residual moisture

- The adhesive and the parts to be bonded must be at room temperature. In order to achieve a durably stable bond, it is essential to briefly warm the glass and fittings before bonding. In this way residual moisture (condensate) can be completely removed.
- Use hot-air unit or hairdryer. Failure to observe these instructions can lead to decreased stability of the bond which may not be noticed immediately, and thus result in decreasing long-term stability.

2.3 Pyrosil® surface pre-treatment

Durable adhesion can be achieved by an additional pre-treatment of problematic bonding surfaces with the Pyrosil® technology protecting the bond from moisture infiltration. This is particularly important for high load-bearing bonds, exterior applications or for use in humid environments.

3. Adhesive selection

Different Bohle Verifix® UVA and light curing adhesives are available for testing, depending on the requirements of the bond, its desired load capacity and intended use. Special observations: Glass/metal bonds: The medium-viscosity UV adhesives Verifix® B-682-T or Verifix® MV 760 are ideal for dynamic bonds. Glass/glass bonds: When planning and constructing all-glass objects, the construction type should always be "closed" (i.e. self-stabilising, see fig.) for achieving maximum stability. Elastic adhesives, such as B-678-0 and B-690-0, are particularly appropriate for "closed" constructions and for surface bonding of glass/glass and glass/metal constructions. If an "open" construction is explicitly desired for design reasons or if this is the only feasible construction type, only the following adhesives must be used: Verifix® LV 740, Verifix® LV 740VIS, Verifix® B-665-0, Verifix® MV 760VIS, Verifix® MV 760 or Verifix® B-682-T.

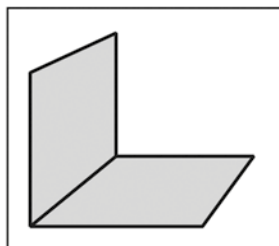

open construction

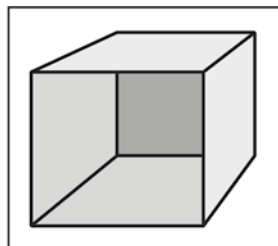
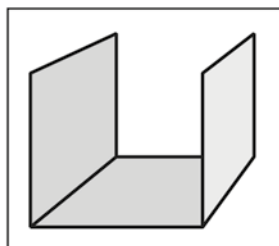

closed construction

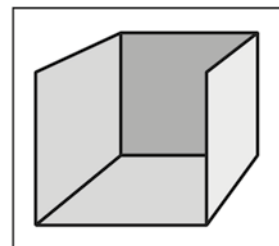



Processing Guidelines for Glass Bonding with UV Adhesives

4. Fixing aids

It is essential to secure bonded objects against vibrations and slipping in order to guarantee the complete curing of the UV adhesive. The Verifix® product portfolio includes suitable fixing aids which facilitate securing the bonded object in position. Our sales representative will be happy to talk to you about further details.

5. Bonding/application of the adhesive

- Before applying the adhesive, check the objects to be bonded for accuracy of fit. This can best be done by mounting the whole construction by way of a trial (use fixing aids).
- If more than 5 minutes have passed after heating the bonding joints, they must be heated again before applying the adhesive.
- If possible, the adhesive should be applied in a horizontal position; applying it in a vertical position might lead to problems.
- If too much adhesive is used, removing the excess material is time-consuming.
- If the adhesive layer is too thick or too thin, the stability of the bond will be affected!
- Suitable dosing aids facilitate the exact and cost-efficient application of the adhesive.

5.1 Applying the adhesive BEFORE constructing the whole object

Medium-viscosity adhesive (Verifix® MV 760, MV 760VIS, B-678, B-690 and B-682-T) is applied before assembling the construction. For surface bonding (B690-0 and B 678-0), the adhesive is always applied before joining the parts.

- When bonding horizontally, a perfect bond without air bubbles is achieved by carefully and evenly lowering the object.
- For edge bonding, the net weight of the bonding parts is sufficient for spreading the adhesive over the entire bonding surface.

5.2 Applying the adhesive AFTER assembling the construction

- Low viscosity adhesive (Verifix® LV 740, Verifix® LV 740VIS and Verifix® B-665-0) enters the bonding joint by capillary action. That is why the parts to be bonded can be assembled in their final position before applying the adhesive.
- For multiple-part objects, make sure the adhesive is applied on the bonding joints one by one (not all at once).
- Before curing the bond, bonding parts should be lifted briefly and lowered again (open and close the bonding joint) in order to guarantee the optimum distribution of the adhesive.

6. Curing (light exposure) - General Information:

Use suitable UV lamp for curing: The lamp must not be smaller/shorter than the bonding joint in order to avoid tensions in the joint due to irregular light exposure.

- During light exposure (curing) position the lamp as closely as possible to the bonding joint.
- Under no circumstances must the object be moved or exposed to vibrations (use fixing aid).
- All Bohle UVA hand lamps are equipped with special filter screens to avoid injuries to eyes and skin, etc.
- For your own safety, appropriate equipment must be worn when working with UV lamps. Please be aware of the manufacturer's instructions. (The use of appropriate safety equipment is recommended when working with UV lamps.)

Curing is done in 2 steps:

1. During pre-curing, processing strength is achieved (approx. 30% of final strength). Then excess adhesive outside the bonding joints can be easily removed.
 - Pre-curing can take between 10 seconds and approx. 2 minutes, depending on the type of lamp. After pre-curing, remove eventual fixing aids and clean objects from possible excess adhesive using Bohle special cleaner, a glass scraper or steel wool, fineness no. 00.
2. Final curing: Depending on the type of lamp, this can take between 60 seconds and approx. 5 minutes.
 - Excessive light exposure has neither negative nor positive effects on the stability of the bond.
 - After final curing and an additional resting time of 24 hours, the bond has reached its full functionality and load capacity.

7. Test Bonds

If you are not sure about the ideal bonding requirements, always conduct a bonding test:

- Bond the object according to the instructions above.
- Afterwards load the object beyond the intended load capacity, e.g. impacts, tilting or jerky movements, use tools if necessary (e.g. pliers, etc.)
- Load until deformation/break in order to determine the load limit.
- If you have problems or questions concerning certain bonding options, our Bohle experts are happy to assist you any time!

Disclaimer

The preceding information as well as any technical recommendation given in writing, verbally or based on tests is provided to the best of our knowledge. However, these are non-binding recommendations only and do not affect your responsibility to determine the correctness of given recommendations and the suitability of the product for your particular processes and purposes. The application, use or processing of our products as well as the production of products based on our technical recommendations are beyond our control and therefore fall exclusively within your area of responsibility. Sales of our products are subject to our most updated General Sales and Delivery Conditions.



Twin LED

The new "Twin LED" UV-LED lamp is suitable for bonds with a diameter of approx. 120 mm. The lamp achieves an even distribution of light intensity over the entire surface, which enables tension-free bonds. The size of the cone of light can be adjusted via the distance of the lamp to the bonding joint. The "Twin LED" is equipped with two integrated LEDs. This offers the possibility to switch between the wavelengths of 365 nm and 395 nm. That is why the lamp can be used both for UVA and light curing adhesives. In addition, curing both through UV transmitting glass, such as float glass or tempered glass, or UV absorbing glass like laminated safety glass or coloured float glass is possible. The "Twin LED" is small, handy and lightweight. It is ideally suited for bonding metal parts. The lamp operates silently and does not become hot over time, which enables convenient handling. The integrated battery makes the "Twin LED" a mobile device, independent from a specific work place. In particular complicated bonds, such as bonding metal parts to already finished objects, for example showcases which can hardly be moved anymore, can now be carried out easily and conveniently. If the construction site is still a shell construction, the previous installation of power lines is no longer necessary. Battery performance is constantly monitored. As soon as the battery is too weak to supply the LED with sufficient energy, the LED switches off automatically. If the LED lamp is permanently operated, the battery life amounts to approx. 2 hours. The display of the "Twin LED" continues working until the battery is finally empty. The battery can be charged with the supplied power cable. The LED can be used while charging. After switching it on, the "Twin LED" is immediately ready for use. The device is operated with four keys. Different curing times can be programmed via 3 timers. The lamp is also additionally endowed with a stop watch function. When used stationary, the "Twin LED" is equipped with several screw fixing points for connecting a tripod, for example. Please note: Very high performance, short curing times!

i Dimensions 125 x 40 x 70 mm · Weight approx. 600 g · Wavelength 365 nm, 395 nm · Battery life approx. 2 hours when LED is permanently operated · Mains voltage 100 - 240 V, 50 - 60 Hz

Included in delivery:

UV lamp supplied in carrying case with foam padding

Battery Pack (already inside the device)

Charger



Art. No.	Description
BO 5500355	Verifix® "Twin LED" UV-LED Lamp
SP BT5559	Spare battery



Verifix® UVA-Star 500, 1110, 1410



The new series of Verifix® UVA-Star tube lamps combines the latest technology with a new design. The "T8" tubes excel thanks to their elevated UVA performance and at the same time save electricity. The high quality electronic ballast is now integrated into the lamp housing, which makes these UVA lamps even more convenient to handle. All lengths are available with either 120 or 230 Volts. As before, the protective tube or the bulb can be exchanged quickly and easily. The new Verifix® UVA-Star tube lamps reach their full capacity after a short warm-up time of 180 sec. They are white light lamps with wave lengths between 315 - 400 nm, they are also suitable for curing UVA and light curing acrylate adhesives. The Verifix® UVA-Star tube lamps are particularly suited for the tension free curing of longer bonding edges in glass/glass bonding. Also bonding edges which are longer than 1410 mm can be cured tension free by putting together several tube lamps.



Art. No.	Version
BO 5500380	Verifix® UVA-Star 500, 230 volts, 18 watts, working length 500 mm
BO 5500381	Verifix® UVA-Star 500, 120 volts, 18 watts, working length 500 mm
BO 5500382	Spare lamp for Verifix® UVA-Star 500
BO 5500383	Acrylic protective tube for Verifix® UVA-Star 500
BO 5500385	Verifix® UVA-Star 1110, 230 volts, 36 watts, working length 1110 mm
BO 5500386	Verifix® UVA-Star 1110, 120 volts, 36 watts, working length 1110 mm
BO 5500387	Spare lamp for Verifix® UVA-Star 1110
BO 5500388	Acrylic protective tube for Verifix® UVA-Star 1110
BO 5500390	Verifix® UVA-Star 1410, 230 volts, 58 watts, working length 1410 mm
BO 5500391	Verifix® UVA-Star 1410, 120 volts, 58 watts, working length 1410 mm
BO 5500392	Spare lamp for Verifix® UVA-Star 1410
BO 5500393	Acrylic protective tube for Verifix® UVA-Star 1410
BO 5500399	End Cap

▶ UVA Hand Lamp UVAHAND 250



For use with short bonding distances · short curing times · UVA wave length 315 - 400 nm · integrated time meter · spacers as protection against overheating · integrated cooling fan · special filter screen · For curing UVA and light curing adhesives · with filter screen · ideal for bonding metal parts and smaller surfaces

Art. No.	Version · For · Description
BO 5209404	230 Volt, 250 Watt · white light

▶ UVA Hand Lamp



For curing UVA and light curing adhesives · with filter screen · ideal for bonding metal parts and smaller surfaces

i Version 230 volts · 100 watts

Art. No.	Version
BO 5500310	UVA Hand Lamp
BO 5500311	Spare fluorescent tube UV 150 F
BO 5500312	Spare H1 filter screen

▶ Spare Parts



For UVA Hand Lamp BO 52 094 04 and BO 52 094 15

Art. No.	For · Version · Description
BO 5209406	BO 5209404 · Spare H1 filter screen with frame · white light
BO 5209407	BO 5209404 · Spare fluorescent tube 250 F

▶ Case



For UVA hand lamps · light grey

i Size 396 x 296 x 315 mm

Art. No.	For
BO 5209409	BO 5209404 / 5209415
BO 5500315	BO 5500310

▶ Professional Kit with Verifix® Fixing Devices and UVA Tube Lamp

Professional kit for UV bonding. Ideally suited for the construction of display cabinets and glass furniture.



This set comprises the following items:

BO 5141000	Glass Scraper, metal	1 pc.
BO 5141001E	Spare Blades, reinforced back	1 box
BO 5141605	Steel Wool, fineness 00	1 pc.
BO 5209305	Application Needle 0.41 mm ø · blue	1 pc.
BO 5209306	Application Needle 0.58 mm ø · pink	1 pc.
BO 5209307	Application Needle 0.84 mm ø · green	2 pc.
BO 5209308	Application Needle 1.37 mm ø · amber	2 pc.
BO 5209320	Needle Adaptor	2 pc.
BO 5209470	UVA Star "Light", 230 volts	1 pc.
BO 639.0	Verifix® Pro Angle Suction Holder	1 pc.
BO 636.0	Verifix® Clamping Device for 3 - 10 mm glass	1 pc.
BO 636.1	Verifix® Clamping Device for 6- 19 mm glass	1 pc.
BO 637.1	Eccentric Suction Stopper	4 pc.
BO 638.0	Verifix® Pump-activated Angle Suction Holder	2 pc.
BO 5007510	Dermatril Disposable Gloves	1 box
BO 5007613	Protective Glasses	1 pc.

Please note:

The required chemical products (cleaners, adhesives, etc.) have to be ordered separately.

Art. No.	Version
BO 5500372	Standard version ·
BO 5500374	110V export version ·

Tiomos Mirro Glass and Mirror Door Hinge



i Mounting glass / wood
· Opening angle 125 ° ·
Glass thickness 3 - 8 mm ·
3-dimensional with mounting
plate · Sales unit 1 pair · Material
Bonding plate zinc · Door stainless
steel

Art. No.	Description
BO 5500290	1 pair Glass- and Mirror Door Hinge with linear mounting plate
BO 5500291	1 pair Glass- and Mirror Door Hinge with cross mounting plate

Swing Hinge square



High quality stainless steel
hinge suitable for inset doors · a
threaded pin in the hinge enables
the door to be removed after
bonding

i Packaging unit 2 items ·
Shape square

Art. No.	Mounting · Description · Edge length · Door weight max.
BO 5500281	glass/glass · 20 mm · 10 kg
BO 5500282	glass/wood · for inset doors · 20 mm · per pair 10 kg
BO 5500283	glass/glass · 30 mm · 20 kg
BO 5500284	glass/wood · for inset doors · 30 mm · per pair 20 kg

Flat Hinge



This polished aluminium hinge for
inset doors is suitable for all glass
thicknesses.

i Shape flat · Maximum load
capacity per pair 10 kg · Packaging
unit 2 items

Art. No.	Application
BO 5206265	right
BO 5206267	left

Flat Hinge



This polished aluminium hinge for
inset doors is suitable for all glass
thicknesses.

i For inset doors · Max. load
capacity per pair 10 kg · Packaging
unit 2 items · Material thickness
2,65 mm

Art. No.	Application
BO 5206266	right
BO 5206268	left

Swing Hinge



High quality stainless steel
hinge suitable for inset doors · a
threaded pin in the hinge enables
the door to be removed after
bonding

i For inset doors · Diameter
20 mm · Height 18,5 mm · Glass
thickness up to 12 mm · Door
weight max. 10 kg · Packaging unit
2 items

Art. No.	Description
BO 5206260	Swing Hinge, round

Swing Hinge



High quality stainless steel
hinge suitable for inset doors · a
threaded pin in the hinge enables
the door to be removed after
bonding

i For inset doors · Diameter
30 mm · Height 24,5 mm · Glass
thickness up to 12 mm · Door
weight max. 20 kg · Packaging unit
2 items

Art. No.	Description
BO 5206261	Swing Hinge, round

Swing Hinge



High quality stainless steel
hinge suitable for inset doors ·
after bonding the door cannot be
removed again

i For inset doors · Mounting
glass/glass · Door weight 5,5 kg ·
Packaging unit 2 items

Art. No.	Description · Version
BO 5500285	Swing Hinge · bonded inside

Swing Hinge



High quality stainless steel
hinge suitable for inset doors ·
after bonding the door cannot be
removed again

i For inset doors · Mounting
glass/wood · Door weight per
pair max. 5,5 kg · Packaging unit
2 items

Art. No.	Description · Version
BO 5500286	Swing Hinge · bonded inside

"SWING" Hinge · glass / wood



Stainless steel · threaded pin in the hinge enables the door to be removed after bonding

i For inset doors · Height 18,5 mm · Max. load capacity per pair 10 kg · Glass thickness up to 12 mm · Packaging unit 2 items

Art. No.	Description · Version
BO 5206262	Swing Hinge · round

"SWING" Hinge · glass / wood



Stainless steel · threaded pin in the hinge enables the door to be removed after bonding

i For inset doors · Height 24,5 mm · Glass thickness up to 12 mm · Max. load capacity per pair 20 kg · Packaging unit 2 items

Art. No.	Description · Version
BO 5206263	Swing Hinge · round

Glass Shelf Support with Plastic Lining



For UV bonding · made of stainless steel

i Diameter 16 mm · Max. load capacity per sales unit 30 kg · Packaging unit 4 items

Art. No.	Description
BO 5206198	Glass Shelf Support with Plastic Lining

Borosilicate Glass Discs



Ground plane-parallel · centre with laser mark · suitable as shelf support or furniture foot

i Thickness 10 mm · Max. load capacity per 4 pieces 40 kg · Packaging unit 20 items

Art. No.	Description · Diameter
BO 5206190	Borosilicate Glass Discs · 20 mm
BO 5206110	Glass Discs · borosilicate · 10 mm

Borosilicate Glass Cubes, for UV Bonding



All sides polished · edges bevelled

i Packaging unit 4 items

Art. No.	Edge length · Load capacity
BO 5500030	15 mm · per sales unit 15 kg
BO 5500031	20 mm · per sales unit 20 kg

Glass Door Handle for UV-bonding



For UV bonding · with many application possibilities such as door knob, wardrobe hook or furniture foot · your glass object will obtain a sophisticated, individual touch

i Material Glass · Height 40 mm

Art. No.	Material
BO 5500243	float glass
BO 5500244	low iron glass

Door Knob, Stainless Steel



i Diameter 16 mm · Length 20 mm · Packaging unit 2 items

Art. No.	Description
BO 5206256	Door Knob, Stainless Steel

Receiving element for Symo lock



For UV bonding · made of stainless steel · Please note: Receiving element and cylinder have to be ordered separately. · Can be retrofitted to finished objects or tempered glass door systems.

i Glass thickness 4 - 15 mm · Sales unit 1 item

Art. No.	Description
BO 5206000	Symo lock for bonding, aluminium, right/left
BO 5206001	Symo core for BO 5206000
BO 5206002	Single door strike-plate, glass/glass
BO 5206003	Double door strike-plate, glass/glass
BO 5206004	Single door strike-plate, glass/wood

▶ Lock for Double Doors



For UV bonding · stainless steel · universal key · bolt lock mechanism BO 5206259/58 is required · The lock is suitable for right and left handed doors as both bolt and lock cylinder can be turned around by loosening the screw.

i Diameter 35 mm · Drill hole in glass 25 mm Ø · Glass thickness 6 - 15 mm · Packaging unit 1 item

Art. No.	Description
BO 5206242	Lock for Double Doors

▶ Lock for Single Inset or Overlay Doors



For UV bonding · stainless steel · universal key · please indicate glass thickness when ordering · The lock is suitable for right and left handed doors as both bolt and lock cylinder can be turned around by loosening the screw.

i Diameter 35 mm · Glass thickness 6 - 15 mm · Drill hole in glass Ø 25 mm · Packaging unit 1 item

Art. No.	Description
BO 5206240	Lock for Single Inset or Overlay Doors

▶ Lock for Double Doors



For UV bonding · universal key · stainless steel · suitable for all glass thicknesses · bolt lock mechanism BO 5206258/59 is required · can be retrofitted to finished objects or tempered glass door systems · The key can only be removed after locking.

i Height 39 mm · Glass thickness 6 - 12 mm · Packaging unit 1 item

Art. No.	Description
BO 5206283	Lock for Double Doors

▶ Shoot Bolt Lock Mechanism



For UV bonding · stainless steel · to secure the slave door on a set of double doors

i Packaging unit 1 item

Art. No.	Diameter · Total length
BO 5206258	10 mm · 50 mm
BO 5206259	20 mm · 68 mm

▶ Magnetic Latch



For UV bonding · stainless steel · for single doors · magnetic locking force 2 kg

i Diameter magnetic plate 8 mm · Packaging unit 1 item · Length 11 mm · Width 12 mm · Height 12 mm

Art. No.	Description
BO 5206254	Magnetic Latch

▶ Magnetic Latch



For UV bonding · stainless steel · for double doors · magnetic locking force 2 kg

i Diameter magnetic plate 8 mm · Packaging unit 1 item · Length 30 mm · Width 12 mm · Height 12 mm

Art. No.	Description
BO 5206255	Magnetic Latch

▶ Magnetic Latch for Wooden Cabinets



Includes screw and plug-in sleeve · magnetic locking force 2 kg each

i Version for single doors · Diameter magnetic plate 8 mm · Material stainless steel · Packaging unit 1 item · Length 18 mm · Width 11 mm · Height 11 mm

Art. No.	Description
BO 5206294	Magnetic Latch for Wooden Cabinets

▶ Magnetic Latch for Wooden Cabinets



Includes screw and plug-in sleeve · magnetic locking force 2 kg each

i Version for double doors · Diameter magnetic plate 8 mm · Material stainless steel · Packaging unit 1 item · Length 30 mm · Width 12 mm · Height 12 mm

Art. No.	Description
BO 5206295	Magnetic Latch for Wooden Cabinets



Pushbutton Magnetic Latch



The pushbutton magnetic latches are suitable for glass doors or drawers whose fittings are not self-closing, i.e. without spring closing mechanisms. The magnetic latch must be positioned opposite the hinge (at the side where the door swings open). It does not matter whether the latch is placed closer to the top or to the bottom.

i Packaging unit 1 item

Art. No.	Version
BO 5500250	round
BO 5500251	square



Adaptor Disc, Stainless Steel



Can also be used as a furniture foot · Suitable for different types of furniture rollers

i Diameter 49,5 mm · Thread M8 · Height 12 mm · Packaging unit 1 item

Art. No.	Description
BO 5206182	Adaptor Disc, Stainless Steel



Adaptor Disc for Table Legs



For UV bonding · made of stainless steel

i Diameter 85 mm · Thread M10 · For Table Leg 80 mm Ø · Packaging unit 1 item

Art. No.	Description
BO 5206186	Adaptor Disc for Table Legs



Adaptor Disc, Stainless Steel



Suitable for different types of furniture rollers

i Diameter 35 mm · Thread M8 · Thickness 4 mm · Packaging unit 1 item

Art. No.	Description
BO 5206155	Adaptor Disc, Stainless Steel

Silberschnitt



Automatic Glass Cutting

One of the major benefits of carbide steel is that it features a service life which is several times longer than the life of conventional steel wheels. Furthermore, carbide cutting wheels have consistently good cutting properties which produce clean cut edges for different glass thicknesses. Bohle continuously invests

in the research and development of glass cutting technology. New materials are being tested both in our own laboratory and also in day-to-day practice in trial plants.



06 | Cutting Wheels

▶ Silberschnitt® Carbide Cutting Wheels



Standard pack consists of 10 wheels. To order packs of 100, please add an H to the article number (e.g. BO 12A135H). · suitable carbide axle BO 496.139F · suitable holder BO 432.0 · For further cutting angles, please refer to our Online Shop.

i Diameter 4,10 mm · Thickness 1,08 mm · Bore hole 1,42 mm

Art. No.	Bracket · Grind · Sales unit
BO 12A135	135 ° · Active · 10 items
BO 12A140	140 ° · Active · 10 items
BO 12A145	145 ° · Active · 10 items
BO 12A150	150 ° · Active · 10 items
BO 12A155	155 ° · Active · 10 items

▶ Silberschnitt® Carbide cutting Wheels



These wheels have a special tolerance (thickness tolerance +0.01). An "L" (Lisec) is added following the numbers that indicate the angle · suitable carbide axle BO 496.439 · suitable carbide holder BO 439.1/439.2

i Diameter 5,00 mm · Thickness 1,00 mm · Bore hole 1,30 mm

Art. No.	Bracket · Grind · Sales unit
BO 02A135L	135 ° · Active · 10 items
BO 02A145L	145 ° · Active · 10 items
BO 02A150L	150 ° · Active · 10 items
BO 02A155L	155 ° · Active · 10 items
BO 02A160L	160 ° · Active · 10 items
BO 02A165L	165 ° · Active · 10 items

▶ Silberschnitt® Carbide Cutting Wheels



Standard pack consists of 10 wheels. To order packs of 100, please add an H to the article number (e.g. BO 02A135H). · suitable carbide axle BO 496.130 · suitable carbide holder BO 432.3 · For further cutting angles, please refer to our Online Shop.

i Diameter 5,00 mm · Thickness 1,00 mm · Bore hole 1,30 mm

Art. No.	Bracket · Grind · Sales unit
BO 02A135	135 ° · Active · 10 items
BO 02A140	140 ° · Active · 10 items
BO 02A145	145 ° · Active · 10 items

▶ Silberschnitt® Carbide Cutting Wheels



Standard pack consists of 10 wheels. To order packs of 100, please add an H to the article number (e.g. BO 03A135H). · suitable carbide axle BO 496.139F · suitable holder BO 432.0 · For further cutting angles, please refer to our Online Shop.

i Diameter 5,60 mm · Thickness 1,08 mm · Bore hole 1,42 mm

Art. No.	Bracket · Grind · Sales unit
BO 03A135	135 ° · Active · 10 items
BO 03A140	140 ° · Active · 10 items
BO 03A145	145 ° · Active · 10 items
BO 03A150	150 ° · Active · 10 items
BO 03A155	155 ° · Active · 10 items
BO 03A160	160 ° · Active · 10 items
BO 03A162	162 ° · Active · 10 items
BO 03A165	165 ° · Active · 10 items

Silberschnitt® Wheel HolderMetal



Without wheel and axle (please order separately) · made of high quality tempered metal alloy · precision machined · suitable for Armatec, Bavelloni, Bottero, Bystronic, Grenzebach, Hegla, Intermac, Laser, Lisec, MacoTec, Olbricht, Pannkoek, Pfister, Rohmer & Stimpfig

i Sales unit 10 items

Art. No.	for Carbide Wheels · Suitable carbide axle
BO 432.0	12, 03 · BO 496.138F, 496.139F
BO 432.1	12, 03 · BO 496.138F, BO 496.139F
BO 432.3	05, 02L · BO 496.130
BO 432.6	06, 66 · BO 496.080

Silberschnitt® Wheel HolderMetal



i for Carbide Wheels 12, 03 · Suitable carbide axle BO 496.139F · Sales unit 10 items

Art. No.	With Inscription
BO 432.135	135 °
BO 432.140	140 °
BO 432.145	145 °
BO 432.148	148 °
BO 432.150	150 °
BO 432.155	155 °
BO 432.158	158 °
BO 432.160	160 °
BO 432.165	165 °

Silberschnitt® Plastic Wheel Holder



Plastic wheel holder ·

i Sales unit 10 items

Art. No.	Cutting angle · Colour · Grind
BO 416A135	135 ° · white · Active
BO 416A140	140 ° · blue · Active
BO 416A145	145 ° · black · Active
BO 416A150	150 ° · brown · Active
BO 416A155	155 ° · red · Active
BO 416A160	160 ° · dark green · Active
BO 416A165	165 ° · light green · Active

Silberschnitt® Plastic Wheel Holder



Plastic wheel holder

i Sales unit 10 items

Art. No.	Cutting angle · Colour · Grind
BO 417A135	135 ° · white · Active
BO 417A145	145 ° · black · Active
BO 417A155	155 ° · red · Active

▶ Wheel Holder, Metal



Without wheel and axle (please order separately) · made of high quality tempered metal alloy · precision machined · suitable for Bavelloni, Bottero, Bystronic, Grenzebach, Hegla, Laser, Lisec, MacoTec, Olbricht, Pannkoke, Rohmer & Stimpfig

i for Carbide Wheels 12, 03 · Suitable carbide axle BO 496.422 · Sales unit 10 items

Art. No.

BO 422.0

▶ Wheel Holder, Metal



Hardened steel · for Lisec cutting equipment

i Length 11,0 mm · for Carbide Wheels 02L · Suitable carbide axle BO 496.439

Art. No.

BO 439.1

▶ Wheel Holders, Metal, for Bottero



For optimised cutting, Bohle offers an additional model to the standard plastic wheel holders type 416. The cutting characteristics can be considerably improved due to the metal wheel holder BO 439.16 and the plastic rings which are colour-coded to indicate the different cutting angles. For shaped and open cuts the use of this type of wheel holder is recommended.

i Bore hole 1,4 mm Ø · Slot 1,1 mm · for Carbide Wheels 12, 03 · Suitable carbide axle BO 496.140F

Art. No.

Version

BO 439.16

non-tempered

BO 439.16V

tempered

▶ Wheel Holder, Metal



Hardened steel · for Lisec cutting equipment

i Length 16 mm · for Carbide Wheels 02L · Suitable carbide axle BO 496.439

Art. No.

BO 439.2

▶ Wheel Holders, Metal, for Bottero

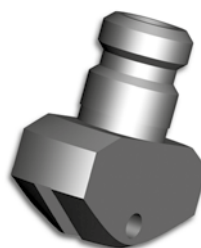

Wheel holder for Bottero systems

i Bore hole 1,4 mm Ø · Slot 1,1 mm · for Carbide Wheels 12, 03 · Suitable carbide axle BO 496.140F

Art. No.

Version

BO 439.122

non-tempered

▶ Plastic Clip



With narrow blade · for cutting shapes

Art. No.

BO 416.1

▶ Protective Cap



for wheel holder module 432

i Colour red · Packaging unit 1 item

Art. No.

BO 432.005

Silberschnitt® Carbide Axles



Wheel axles made of carbide

Art. No.	ø · Length
BO 496.138F	1,38 mm · 4,2 mm
BO 496.139F	1,39 mm · 4,6 mm
BO 496.140F	1,4 mm · 12 mm
BO 496.422	1,39 mm · 9 mm
BO 496.439	1,3 mm · 8 mm

Steel Holder



With narrow blade · for cutting shapes

Art. No.	Version
BO 432.7	standard

Mounting Aid for Carbide Wheels



The practical mounting aid makes wheel exchange easy

Art. No.	Diameter
BO 440	1,30 mm

ACECUT 4153 Cutting Fluid



Applications: Automotive glass, general cutting, shape cutting

i Glass thickness 1,6 - 6 mm
· Viscosity: approx. 35 mPas
Description washable

Art. No.	Contents
BO 5002802	30 litre

ACECUT 5929 Cutting Fluid



Especially suitable for coated glass · evaporates after use without leaving residue · small glass particles are bound · low surface tension · can be used for float glass production of 4 - 19 mm · temperature range 40° - 60° C

i Viscosity: approx. 2 mPas

Art. No.	Contents · Description
BO 5002807	30 litre · evaporating

ACECUT 6000 Cutting Fluid



Applications: automotive glass, shape cutting with high requirements · washable

i Temperature range 40° - 90 ° · Viscosity: approx. 65 mPas

Art. No.	Contents · Description
BO 5002806	30 litre · washable

ACECUT 5503 Cutting Fluid



Especially suitable for coated glass · evaporates after use without leaving residue · small glass particles are bound · low surface tension · for mirrors, patterned and float glass as well as painted or printed glass · can be used for float glass production of up to 10 mm · temperature range 30° - 50° C

i Viscosity: approx. 2 mPas

Art. No.	Contents · Description
BO 5002805	30 litre · evaporating



Glass Processing Machinery

Whether in glaziers' shops or industrial companies, machines are becoming increasingly important in professional glass processing. Strict production sequences and high precision make machine processing of glass especially efficient. Based on years of experience, Bohle has developed a comprehensive range of machinery for all kinds of glass processing, including glass grinding, drilling and sandblasting. The machines are manufactured at Bohle headquarters

in Haan, Germany, and meet the highest quality standards. Auxiliary systems such as coolant circulation and cleaning systems, glass washing machines as well as workshop equipment are also available.



07 | Glass Processing Machinery

Transport and Mounting Aids

The tendency towards increasingly larger glass constructions in architecture and the growing use of 2-gap insulating glass pose new challenges for glass processors and assemblers: Elements which could previously be moved by two people have now become so heavy that they can hardly be transported manually on site or within company premises any longer. With the Liftmaster B1 Bohle has developed an innovative handling and mounting aid which enables transporting objects of up to 180 kg such as glass panes, window elements or metal and stone sheets easily and safely - by only one person.

Innovative Handling Aid

▶ Liftmaster B1

Features

- Easy and secure handling of structural components of up to 180 kg
- Stable construction
- Mast can be rotated and tilted
- Easy assembly of structural components
- Ideal for transport within company premises and on construction sites
- Can be disassembled easily, fits in almost any multi-purpose vehicle
- Very compact and manoeuvrable
- Fits through standard doors
- Handle is height adjustable
- Includes vacuum lifter: can be rotated by 360° · can be removed very easily and used separately together with a crane · has a dual circuit vacuum system with 4 suction pads · is very flat and compact · is equipped with a vacuum indicator for monitoring the vacuum · the vacuum is generated via a hand pump, therefore ready for use at all times (no previous charging of batteries required) · weight: 20 kg

Specifications	Liftmaster B1
Length	1.2 m
Width	0.8 m (with extended axles to widen track 1.1 m)
Height	1.95 m
Art. No.	BO 88.01



▶ Manual Lifting Device



The manual lifting device can do without an electric pump and is therefore very versatile in use. A dual circuit vacuum system, reserve tanks, vacuum display and an additional visual vacuum indicator ensure high levels of safety. The manual lifting device stands out due to its very compact construction and low weight.

❗ Load capacity max. 180 kg · Weight approx. 20 kg · Dimensions 910 mm x 510 mm x 100 mm · Turns 360° · Tilttable 90°

Art. No.

BO B18DM4

Process Water Treatment Systems

▶ Sedimentor

Using machine coolant for a long time is not only better for the environment but also for your wallet. The coolant cleaning systems from Bohle can help you do that. Thus the costly cleaning of the machine purifying system is greatly reduced. Further advantages of clean coolant: longer service life of tools and significantly improved processing quality of the glass.

Features

- Manufactured by Bohle in Germany
- Practically clear process water due to effective sedimentation granules
- Much improved processing quality, especially when polishing
- Time and effort to clean the glass processing equipment is significantly reduced
- Compact, space-saving system
- Decentralised solution for direct connection to the machine
- Consistent high grinding quality

▼ Accessories

Optimised sedimentation granules ·
Pumps for waste water · Collecting
systems for waste water



Specifications	Sedimentor 1.0	Sedimentor 0.3
Flow rate	150 l/min	50 l/min
Cleaning performance	approx. 3,6 kg/h	approx. 1,0 kg/h
Filling quantity	1000 litres	320 litres
Optimised sedimentation granules	Powder	Powder
Electrical connection	2 kW, 400 V, 50 Hz, 3 NPE	2 kW, 400 V, 50 Hz, 3 NPE
Filter bag	300 litres	70 litres
Art. No.	BO SEDI10	BO 85.30



Hand Refractometer



Art. No.

BO 50028303



Filtering Bag for Sludge Drainage



Especially strong filter fabric with 4 carrying loops · for drainage of glass sludge · suitable for Bohle Sedimentor water cleaning systems · with 4 additional base loops for easy handling

Art. No.

Contents

BO 50028401

300 litre

BO 50028403

70 litre



Flocculant



Binds the fine suspended particles in the coolant of glass processing machines, allowing sedimentation. Hence it is possible to achieve virtually clear water in the system. BO 50028310 Bohle Sediflock 310 granulated flocculant, for use exclusively with Bohle Sedimentor water cleaning systems. Also suitable for manual purification of grinding water! Add approx. 200g of flocculant after finishing grinding, thoroughly mix for about 3 min. Keeps grinding sludge soft and easy to remove from the tank.

Art. No.

Description · Contents

BO 50028310

granules · 10 kg

Grinding Machines



Vetrocraft® Straight Line Edgers

The vertical straight line edgers from Bohle are suitable for the efficient grinding, polishing and arripping of straight edges. The machines are available with 4, 6, 8 or 9 spindles and process glass panes that are 3 - 25 mm thick and weigh up to 300 kg. The working speed is infinitely adjustable from 0.8 to 3 metres per minute.

Features

- Automatic vertical grinding machine for edge and arris
- Easy operation by PLC control
- Automatic or manual operation
- Excellent grinding results
- Sturdy, vibration-free construction
- Minimal maintenance costs
- Exceptional value for money



Accessories

Process Water Treatment · Cooling lubricant · Grinding and polishing wheels for laminated safety glass

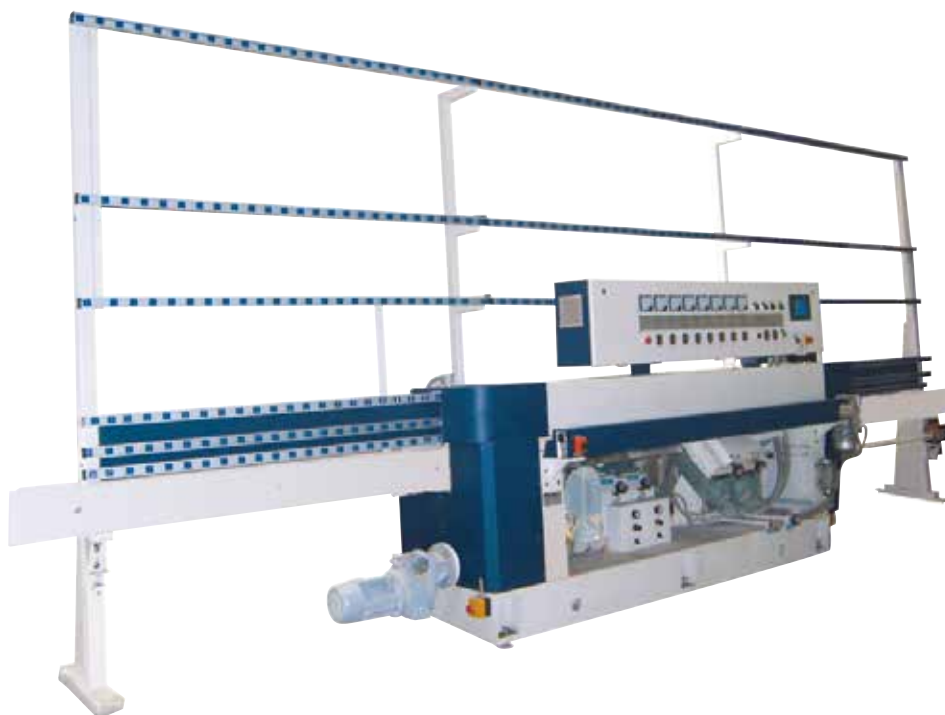

Specifications	Vetrocraft SL8328A
Spindles	8
Glass thickness adjustment	semi-automatic
Dimensions	6500 x 1600 x 2600 mm
Output	13,8 kW
Electrical connection	400 V, 50 Hz, 3 NPE
Art. No.	BO SL8328A



Bohle Glass Equipment - 8 Spindle Straight line Polisher Wheel Guide



Specifications	Position 1	Position 2	Position 3	Position 4
Art. No.	BO 5470004 / BO 547004S	BO 5470003 / BO 547003S	BO 5471340	BO 5470140
Side	Flat Edge	Flat Edge	Arris	Arris
Purpose	Rough Diamond	Smooth Diamond	Grind - Polish	Polish
ø diameter in mm	150 mm	150 mm	130 mm	130 mm
ø bore size mm	12 mm	12 mm	12 mm	60 mm
Height in mm	35 mm	35 mm	35 mm	35 mm



Specifications	Position 5	Position 6	Position 7	Position 8
Art. No.	BO 5471340	BO 5470140	BO 5470127	BO 5470110
Side	Arris	Arris	Flat Edge	Flat Edge
Purpose	Grind - Polish	Polish	Polish (10S40)	Cerium Polish (X5000)
ø diameter in mm	130 mm	130 mm	150 mm	150 mm
ø bore size mm	12 mm	60 mm	70 mm	70 mm
Height in mm	35 mm	35 mm	30 mm	30 mm



Acecool 5679 Coolant



Acecool 5679 is a fully synthetic coolant and is ideal for edge working, drilling, and sawing glass · can be used for processing float glass, technical glass (bososilicate) and crystal and lead crystal glass · lower concentration level required · recommended for bevelling and sawing · increased corrosion inhibition and dispersing effect · free from mineral oil · 100% soluble in water

Art. No.	Contents
BO 6100402	20 litre



Features

- Manual grinding machine with uniform belt speed
- For simple grinding applications
- Available in 230 V and in 400 V
- Smooth running action
- Integrated coolant circulation system, optimum belt cooling
- Simple belt changing system for grinding edges and arrisses
- For use with all common silicon carbide abrasive belts (100 x 2690 mm)



Belt position "straight grinding"



Belt position "lower edge grinding"



Belt position "upper edge grinding"



Specifications	Versalux + 230V	Versalux + 400V
Abrasive belt dimensions (W x L)	100 x 2690 mm	100 x 2690 mm
Working height approx.	1000 mm	1000 mm
Power connection	2 kW, 230 V, 50 Hz, 1NPE	2 kW, 400 V, 50 Hz, 3NPE
Belt speed	7,5 m/s	7,5 m/s
Dimensions	780 x 470 x 1650 mm	780 x 470 x 1650 mm
Weight	110 kg	110 kg
Art. No.	BO VL07230	BO VL07400



Glass Belt Grinding Machine Master Belt

The Bohle glass belt grinding machines are available with castor roller table and different belt speeds. · All models can be optionally equipped with comprehensive accessories.

Features

- Manufactured by Bohle in Germany
- Large contact roller (Ø 200 mm) for minimal hollow grinding
- All machine parts subject to humidity made of stainless steel
- Castor roller working table, 1200 x 600 mm
- Grinding and arissing unit with handwheel and special stopper for precise arrises
- Including height adjustment for grinding and arissing unit
- Socket for coolant circulation system and thermal motor protection
- On/off switch with emergency stop function and undervoltage release
- Lateral speed adjustment system within the operator's reach
- Articulated cooling hose for direct cooling of the grinding area
- Connection of coolant circulation system is possible
- Fixing points for comprehensive accessories available



Accessories

Table extensions and pull-outs
· Coolant collecting trays and circulation systems · Grinding tables for small panes · Stopper rollers for grinding circular panes



Specifications	Master Belt 11	Master Belt 11/22	Master Belt 8/30 -S	Master Belt 8/25 -SE
Belt length	100 x 1830 mm	100 x 1830 mm	100 x 1830 mm	100 x 1830 mm
Electrical connection	1,1 kW, 400 V, 50 Hz, 3 NPE	1,4/1,8 kW, 400 V, 50 Hz, 3 NPE	2,2 kW, 400 V, 50 Hz, 3 NPE	1,1 kW, 230 V, 50 Hz, 1 NPE
Working height	1050 mm	1050 mm	1050 mm	1050 mm
Contact roller	200 mm Ø	200 mm Ø	200 mm Ø	200 mm Ø
Belt speed	11 m/s	2-speed 11/22 m/s	Infinitely adjustable 8 - 30 m/s	Infinitely adjustable 8 - 25 m/s
Dimensions	1200 x 1130 x 1720 mm	1200 x 1130 x 1720 mm	1200 x 1130 x 1720 mm	1200 x 1130 x 1720 mm
Art. No.	BO 80.3-1N	BO 80.5N	BO 80.6-SN	BO 80.6-SEN



Swivelling Ball-Castor



With 2 adjustable nuts

i Material: Rubber · Thread M14 mm

Art. No.	Description
BO 5008000	50 mm
BO 5008005	35 mm



Twin Belt Grinding Machine "Twin Belt" for Dry Grinding

Bohle twin belt grinding machines for dry grinding are, among other things, ideally suited for processing glasses with a protective film or water-sensitive coating. Certified filtering systems keep glass surfaces clean after grinding. In this way scratches are avoided.

Features

- Manufactured by Bohle in Germany
- Manual machine for dry grinding
- High quality grinding for sensitive glass like Low-E
- Optimum cooling by special air guides
- Powerful filter technology ensures that workplace conforms to standards
- Especially high productivity when diamond belts are used
- Optional air cushion table for easy handling and scratch prevention



Accessories

Castor roller worktable and extensions · Air-cushioned table, adjustable to glass weight · Support rollers for large glass panes · Pneumatic folding stopper for positioning · Corner edging devices for dry grinding · Filtering system for dry grinding



Specifications	Twin Belt KSA 15T	Twin Belt Compact KSA-C 15T
Type	for straight edges and shapes	for straight edges
Belt length	100 x 1830 mm	100 x 1160 mm
Belt speed	15 m/s	15 m/s
Electrical connection	6 kW, 400 V, 50 Hz, 3 NPE	5 kW, 400 V, 50 Hz, 3 NPE
Dimensions	1100 x 1050 x 1800 mm	700 x 660 x 1600 mm
Glass thickness	3 - 20 mm	3 - 12 (20) mm
Art. No.	BO 80.12-T	BO 80.13-T



Twin Belt Grinding Machine "Twin Belt" for Wet Grinding

Twin belt grinding machines for the use of diamond belts and other high performance belts in industry in particular, as well as for use in workshops. Top model with two belt speeds · high efficiency and improved grinding results · ideal for straight edges and shape cuts · two modes of operation : Grinding at the "hard belt" for straight edges, grinding at the "soft belt" to grind shaped glass panes · heavy-duty construction · low vibration run to obtain optimum grinding results · infinitely adjustable belt tension by pneumatic control within easy reach · attachment of a coolant circulation system possible · easy exchange of belts due to the large side door · easy setting of glass thickness and arris

Features

- Manufactured by Bohle in Germany
- Manual machine for wet grinding
- High performance for perfect edge quality
- Adjustable glass thickness and depth of arris
- Especially high productivity when diamond belts are used



Accessories

Castor roller worktable and extensions · Support rollers for large glass panes · Pneumatic folding stopper for positioning · Corner edging devices for dry grinding · Coolant Circulation Systems



Specifications	Twin Belt KSA 15/30	Twin Belt compact KSA-C 15/30
Belt type	hard and soft	hard
Belt length	100 x 1830 mm	100 x 1160 mm
Belt speed	15 / 30 m/s	15 / 30 m/s
Electrical connection	4 kW, 400 V, 50 Hz, 3 NPE	4 kW, 400 V, 50 Hz, 3 NPE
Dimensions	1100 x 1050 x 1800 mm	700 x 660 x 1600 mm
Glass thickness	3 - 20 mm	3 - 20 mm
Art. No.	BO 80.12-P	BO 80.13-P



Features

- Manufactured by Bohle in Germany
- Frequency-controlled speed with electronic brake
- Precisely ground steel disc ø 600 mm
- Vibration-free run for optimum grinding results
- Quick and easy exchange of magnetic grinding discs
- Central coolant supply through the axle of the grinding disc
- Additional cooling via articulated hose
- Clockwise and anti-clockwise rotation for optimum use of abrasive agent
- Stainless steel coolant tray with conductive elements for reducing the resulting water mist



Accessories

Adjustable stopper system, foldable
· Prism for grinding cylindrical parts · Bevel guide 45° · Coolant Circulation System

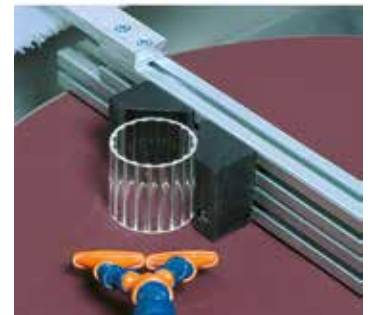

Specifications	Plano 600-S
Speed	infinitely adjustable 100 - 800 rpm
Disc support	600 mm Ø
Rotational direction	clockwise and anti-clockwise
Water connection	1/2 "
Electrical connection	1,5 kW, 400 V, 50 Hz, 3 NPE
Dimensions	800 x 800 x 1000 mm
Art. No.	BO 81.3-S

Drilling Machines



Manual Drilling Machine - Pico Drill

Pico Drill from Bohle is an economical one-sided drilling machine with continuous speed adjustment, which can be used as a portable tabletop model or as a drilling table. Its very compact design makes the Pico Drill ideal for use at the construction site or in the workshop. The safety switch as standard significantly reduces the risk of accidents. The Pico Drill 100 L version with point laser positioning enables much easier alignment of the drilling machine on the glass.

Features

- Powerful drill with continuous speed control
- Easy adjustment of drilling depth by stopper
- Good support of the glass by different drill templates
- Easy electrical connection with Schuko plug and safety switch as standard
- For drill diameters between 3 and 75 mm



BO 79.200



BO 79.260

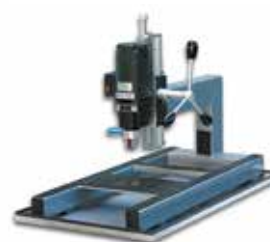

BO 79.250

Specifications	Pico Drill 100 T Tabletop Drilling Machine, 230 V / 50-60 Hz	Pico Drill 100 T with table W 1350 x D 890 mm, working height 960 mm, 230 V / 50-60 Hz	Pico Drill 100, 230 V / 50-60 Hz	Pico Drill 100, 110 V / 50-60 Hz
Art. No.	BO 79.250	BO 79.260	BO 79.200	BO 79.201
Specifications	Pico Drill 100 L with point laser, 230 V / 50-60 Hz	Pico Drill 100 L, 110 V / 50-60 Hz with point laser	Laser for Pico Drill 79.200, 79.201, 79.200L and 79.201L	Cross laser for Pico Drill 79.250 and 79.260
Art. No.	BO 79.200L	BO 79.201L	BO 79.210	BO 79.215



Profi Drill

The manual operation of both spindles of the Profi Drill series of double-sided horizontal glass drilling machines is done from above. This allows quick and precise drilling.

Features

- Manufactured by Bohle in Germany
- Double-sided horizontal drilling machine
- Electronic speed control via frequency converter
- Long reach of 1000 mm
- Sturdy construction - also suitable for countersinking
- Professional drill heads with precise, smooth-running drill spindles
- Easy operation and maintenance
- All parts made of stainless steel, galvanised or lacquered twice



Accessories

Table extensions with castor rollers · Lateral and front additional supports · Laser as positioning aid · Positioning stoppers · Halogen lamp · Coolant Circulation System



Profi Drill 2/1000-S

Specifications	Profi Drill 2/1000-S
Electrical connection	2 kW, 400 V, 50 Hz, 3 NPE
Dimensions	760 x 1530 x 1650 mm
Speed	infinitely adjustable 300 - 3500 rpm
Glass thickness	(one-sided up to 40 mm) 3 - 20 mm
Drill diameters	3 - 80 mm
Art. No.	BO 79.3-S

Verti-Clean Glass Washing Machines

▶ Verti-Clean

The powerful systems of the Verti-Clean series are ideal for cleaning flat glass after processing. The open construction also allows panes to be washed that are higher than the machine itself.

Features

- Space-saving vertical construction
- Motor-driven inlet and outlet with shut-off
- 2 - 4 brushes
- Thermostat-controlled warm water preparation
- Automatic hot-air blower in sound-insulated casing for clean, dry panes
- Exit side with illuminated inspection station for reliable quality control of glass

▼ Accessories

Entry and exit extensions · Damper for hot air · Brushes for Low-E
· Washing compound for glass washing machines



Specifications	Verti-Clean 13.2	Verti-Clean 15.4	Verti-Clean 16.4	Verti-Clean 16.4-20
Washing height	1300 mm	1500 mm	1600 mm	1600 mm
Number of brushes	2	4	4	4
Glass thickness	3-12 mm	3-12 mm	3-12 mm	3-20 mm
Total length	4850 mm	5100 mm	5100 mm	5100 mm
Total height	2050 mm	2150 mm	2250 mm	2250 mm
Art. No.	BO 84.132	BO 84.154	BO 84.164	BO 84.164-2

▶ Acedet 5509 for glass washing machines



Neutral, non ionic product particularly for use in insulating glass industry · does not attack soft coated glass · during proper application has no negative effect on the subsequent sealing · for washing before laminated glass production as well as before coating and tempering · postconnected refinement processes during proper application are also not influenced · at recommended application temperatures (40 - 60°C / 104° - 194° F) the product is virtually foam free · has no negative effect on the ion exchange system, however its detergency is not decreased by the ion exchanger · can also be used on cycle washing machines

Please note: Hazardous material
- shipping by air is not possible

Art. No.	Contents
BO 6100602	30 litre

Machine Accessories



Coolant Circulation Systems

Nowadays, whenever glass processing machines are used, coolant circulation systems should naturally be on hand as well. Not only do such systems offer significant potential for cutting water costs, but the resulting longer service life of tools also helps to amortise the investment quickly. Another benefit is that your glass processing results are improved due to optimum cooling and the option of using cooling lubricants.

Features

- Manufactured by Bohle in Germany
- Water consumption is significantly reduced.
- Cooling lubricants can be used, resulting in improved glass processing, extended service lives of tools and reduction of effort required for cleaning.
- Water and waste water connections are not needed at the machine site.
- No costly drainage systems required
- Sludge can be easily removed.
- Special chamber system improves cleaning of the water.



Accessories

Transport roller for KUS 1 - KUS 2-1
· Coolant concentrate



Specifications	KUS 2	KUS 3
Tank size	50 litres	100 litres
Flow rate	60 l/min	60 l/min
Dimensions	850 x 500 x 570 mm	1200 x 800 x 500 mm
Electrical connection	0,16 kW, 400 V, 50 Hz, 3 NPE	0,16 kW, 400 V, 50 Hz, 3 NPE
Art. No.	BO 78.82	BO 78.95



Dust Filtering Systems

Dry grinding produces dust which must be extracted and filtered out as near as possible to the site where it originates. For this purpose Bohle offers powerful filtering systems especially designed for extracting aggressive glass dust. Used together with Bohle twin belt grinding machines, these filtering systems fulfil the strict environmental regulations for set-up at the workplace.

Features

- Suitable for Twin Belt grinding machine for dry grinding
- Certified for set-up directly at the workplace
- Low operating expenses
- High suction rating for good cleaning of ground glass panes
- Convenient dust extraction due to tiltable filter housing
- Special filter cartridges for glass dust
- Fully automatic cleaning of permanent filter cartridges (dust class M)
- Mobile with 6 castors
- Minimal generation of noise thanks to sound-absorbing filter housing



Accessories

Connecting hoses



Specifications	Dustomat Filtering System
Art. No.	BO 89.205

In regard to this catalogue

With the printing of this catalogue, all previous catalogues and price lists, or parts thereof, are no longer valid. Our offers apply to retail, trade and industry. Technical specifications (dimensions, weights, materials, etc.) and other specifications (design, colour, etc.) are subject to change. The range of products can change during the time this catalogue is current. In particular, we reserve the right to remove individual articles without prior notice. Please request further details from your Bohle contact person. Print-related colour variations are possible. Bohle AG is not liable for any printing or other errors and omissions in this catalogue. For many of the articles protective rights such as patents, trademarks, design copyrights, etc. have been registered or are pending registration - also by third parties.

© Copyright by Bohle - This catalogue is protected in all parts (texts, photos, images etc.) by copyright. Any use outside the strict limits of copyright laws without written permission of Bohle AG is not permitted. This applies in particular to duplications, reprints, translations, microfilming as well as saving and processing in electronic systems. July 2016.

South Africa Sales Conditions

1 Application

These conditions apply to sales, service as well as all statements made by Bohle in catalogues, brochures, price lists, quotations, on the internet or verbally. Variations of these conditions are only valid if confirmed by Bohle in writing. Any other terms or conditions are excluded. Placing an order means acceptance of these conditions. Bohle may change their sales conditions at their discretion.

2 Orders/Contract

Orders received by mail, internet, phone or fax are only binding when accepted by Bohle. Customers are encouraged not to place orders via telephone to avoid misunderstandings and incorrect goods being ordered.

3. Price & Payment Terms

Quotations are only valid in writing and for the stated period. Bohle reserves the right to change products at any time but guarantee at least equivalent functionality and performance. Prices are to be understood in R (Rands), net, ex-warehouse, excluding VAT, transport cost, insurance and installation. Bohle reserves the right to adjust prices due to exchange rates, production cost, duties, insurance, freight and other purchase costs (incl. for components & services). Please note that deliveries of small but unwieldy orders (such as L-squares, straight edges, mirror profiles etc.) cause relatively high transport cost. Consolidate such products with other orders and ask for transport cost prior to delivery. Our staff will be happy to be of assistance. Payment is to be made either in advance (EFT) or by irrevocable, confirmed letter of credit issued to our indicated bank, by cheque or credit card. Other payment conditions have to be agreed upon prior to accepting the order. Bohle may suspend deliveries or service until having received full payment. Any costs involved with receiving a late payment are for the account of the purchaser and will not be waived. Cheques may only be accepted conditionally. The Seller shall be entitled to charge interest at the rate as stipulated by the National Credit Act regulations of South Africa. The Seller shall also be entitled to charge such reasonable costs as it may incur in recovering any overdue balance.

4 Delivery/Title/Risk

Deliveries take place from our warehouses from the most appropriate location for Bohle. The delivery period stated in any order confirmation is approximate. Delays in delivery do not justify any kind of compensation. We reserve the right to supply similar articles in case the products ordered are not available or have been modified. Partial deliveries may be made. Title to product passes on full payment only. Until then the purchaser has to insure and store the goods separately and may not modify, pledge or sell them. On request the products have to be made available to Bohle for re-collection. Should the purchaser sell the goods before the title has passed, the proceeds of that sale shall be held on Bohle's behalf, separately from the purchaser's general funds. If the purchaser refuses to accept a delivery without Bohle's agreement, he must pay Bohle's expenses or loss resulting from that refusal, including storage costs, until he accepts delivery. Until title of the goods has passed to the Buyer, the Buyer shall not purport to be the owner of the goods and shall not show such goods as stock in its accounts.

5 Acceptance

Delivered products have to be inspected by the purchaser promptly after receipt of the delivery. If the purchaser does not claim any discrepancies in the delivery within 3 working days after receipt of the shipment in his warehouse or elected delivery address, the goods are considered as accepted in full. Should Bohle agree to return products, they must be in their original condition (unused, undamaged, in original packaging) and accompanied by a return note as well as proof of purchase. Any return charges are for the purchaser's account, a 10% handling fee will be charged to the purchaser for any goods returned through no fault of supply; all machinery parts, machines and special articles are excluded from acceptance of return to Bohle due to purchaser's incorrect or cancelled orders. Goods received in an obviously damaged condition (damaged packaging) should be either rejected by the purchaser, or his representative, on delivery, or, if signed for, then signed for as "Received in damaged condition", regardless of carrier paperwork instructions and of carrier driver information. Failure to do this will result in any claim for damage being rejected.

6 Warranty

Bohle guarantees that their products will be free from defects for 6 months after date of invoice. Should a product be defective within this period, Bohle will repair or replace it within a reasonable time. Bohle is allowed to examine the product at the purchaser's or Bohle's premises (at Bohle's choice). Any return of goods has to be approved by Bohle in writing before being effected. Any shipments sent payment collect will not be accepted. Bohle will not accept warranty protection claims for damage caused by incorrect installation, use, modifications or repair by the purchaser or any unauthorised 3rd party.

7 Liability

Any liability exceeding the replacement of faulty material is generally excluded. This refers especially to any indirect or consequential loss, damages or expenses.

8 Force Majeure

Bohle is not liable for delays in delivery or service caused by circumstances beyond their reasonable control and will be entitled to a delivery time extension for the fulfillment of the order.

9. Jurisdiction

Only South African law applies and the exclusive place of jurisdiction for all legal disputes is South Africa.

July 2016

How to contact Bohle

South Africa

Bohle Online-Shop

E-Mail

Sales Telephone

Sales Fax

Physical Address

www.bohle-group.com

sales@bohle.co.za

+27 11 792-6430

+27 11 793-5634

Bohle Glass Equipment (Pty) Ltd

Unit 3, Graphite Industrial Park

Fabriek Street

Strijdom Park 2125, Gauteng

Office hours

Monday to Friday 8:30 – 16:30

Collecting goods

Monday to Friday 8:30 – 16:30

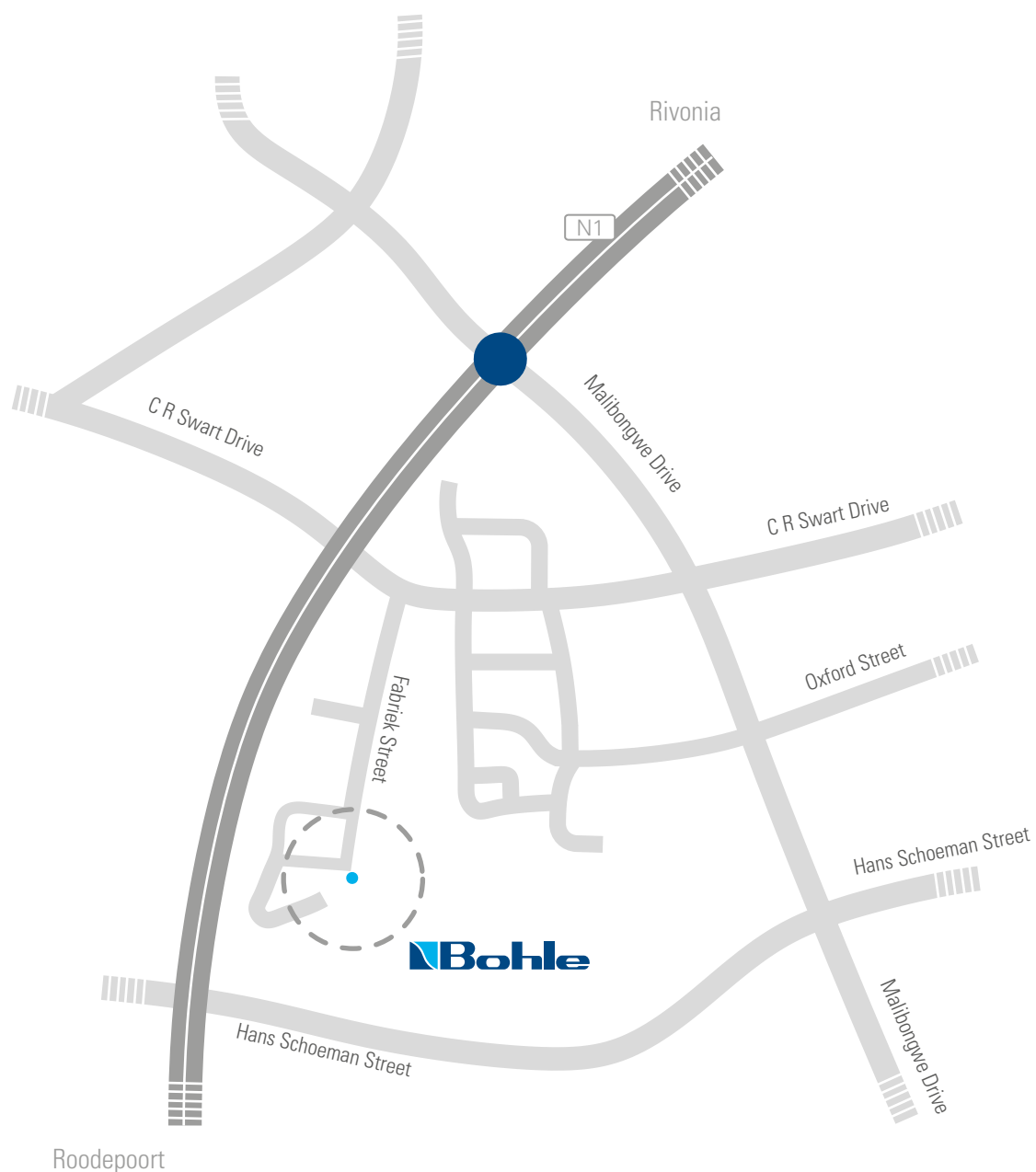

South Africa

Bohle Glass Equipment (Pty) Ltd.
Unit 3, Graphite Industrial Park
Fabriek Street,
Strijdom Park 2125, Gauteng

T +27 11 792-6432
F +27 11 793-5634

sales@bohle.co.za
www.bohle-group.com