



HARDWARE

for Interior Fit-Out

SLIDING DOOR SYSTEMS 3

MasterTrack® FT	4
MasterTrack® BT	11
SlideTec	17



HARDWARE FOR ALL-GLASS CONSTRUCTION 21

Patch and Corner Fittings	22
Glass Door Locks	30
Glass Door Hinges	35



GLASS DOOR HANDLES 36

Rod Handles	37
Flush Handles	42



WALL CONNECTING AND GLAZING PROFILES 43

Clamp-on Frame Profile	44
Glass Connection Profiles	45
Duplocoll®	47



MasterTrack® FT 60/80

With MasterTrack® FT Bohle offers a new, complete, high-tech solution for sliding door systems which stands out due to its revolutionary running smoothness and palpable ease of movement. What is so special about it: The entire installation requires only a few simple steps. Mounting is quick, intuitive and cost-effective.



Bohle MasterTrack® FT 60 Set Wall Mounting incl. damping mechanism, single door

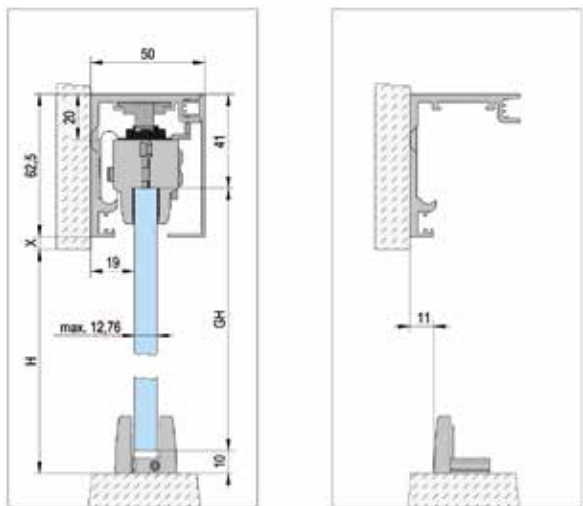

LENGTH · FINISH	ART. NO.
2000 mm · aluminium-coloured E6/EV1	BO 5762011
Mounting	Wall Mounting
Max. door weight	60 kg
Complete set	Yes



i Glass thickness door: toughened glass 8 - 12 mm, laminated safety glass 8.76 - 12.76 mm · no glass processing required · minimum door width 600 mm · the running track is pre-drilled.

INCLUDED IN DELIVERY:

1x	Top Track
1x	Cover
2x	Carriages
2x	Damping Mechanisms
1x	Bottom Guide
2x	End Caps

Bohle MasterTrack® FT 60 Set Ceiling Mounting incl. damping mechanism, single door

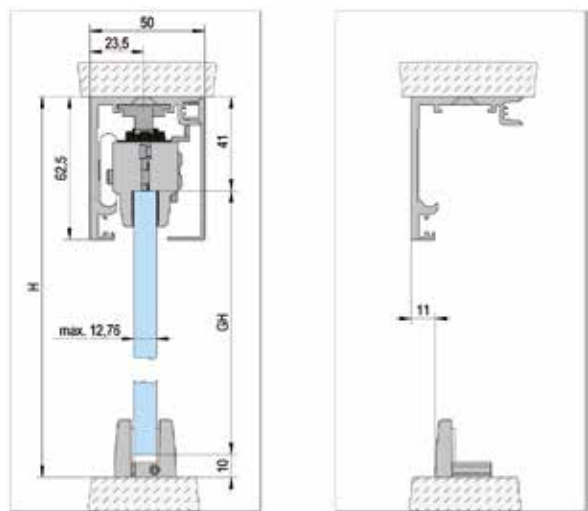

LENGTH · MAX. DOOR WEIGHT	ART. NO.
2500 mm · 60 kg	BO 5762521
2500 mm · 80 kg	BO 5782521
Mounting	Ceiling Mounting
Finish	aluminium-coloured E6/EV1
Complete set	Yes



i Glass thickness door: toughened glass 8 - 12 mm, laminated safety glass 8.76 - 12.76 mm · no glass processing required · minimum door width 600 mm · the running track is pre-drilled. · please order cover caps separately if required.

INCLUDED IN DELIVERY:

1x	Top Track
1x	Cover
2x	Carriages
2x	Damping Mechanisms
1x	Bottom Guide

Bohle MasterTrack® FT 80 Set Wall Mounting incl. damping mechanism, single door

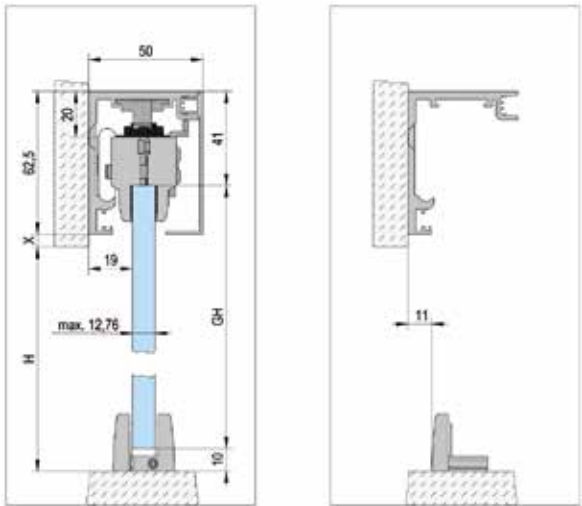

LENGTH · MAX. DOOR WEIGHT	ART. NO.
2500 mm · 60 kg	B0 5762511
2500 mm · 80 kg	B0 5782511

Mounting	Wall Mounting
Finish	aluminium-coloured E6/EV1
Complete set	Yes



1 Glass thickness door: toughened glass 8 - 12 mm, laminated safety glass 8.76 - 12.76 mm · no glass processing required · the running track is pre-drilled. · minimum door width 790 mm

INCLUDED IN DELIVERY:

1x	Top Track
1x	Cover
2x	Carriages
2x	Damping Mechanisms
1x	Bottom Guide
2x	End Caps

Bohle MasterTrack® FT 80 Set Ceiling Mounting incl. damping mechanism, single door

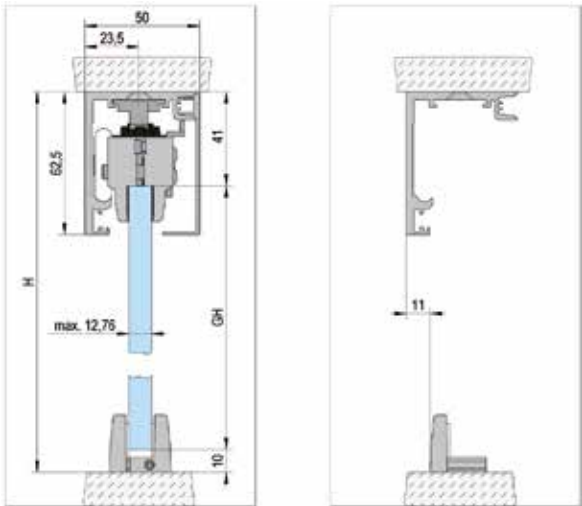

LENGTH · FINISH	ART. NO.
3000 mm · aluminium-coloured E6/EV1	B0 5783021

Mounting	Ceiling Mounting
Max. door weight	80 kg
Complete set	Yes



1 Glass thickness door: toughened glass 8 - 12 mm, laminated safety glass 8.76 - 12.76 mm · no glass processing required · the running track is pre-drilled. · minimum door width 790 mm · please order cover caps separately if required.

INCLUDED IN DELIVERY:

1x	Top Track
1x	Cover
2x	Carriages
2x	Damping Mechanisms
1x	Bottom Guide

Bohle MasterTrack® FT Set Ceiling Mounting with Fixed Sidelight incl. damping mechanism, single door

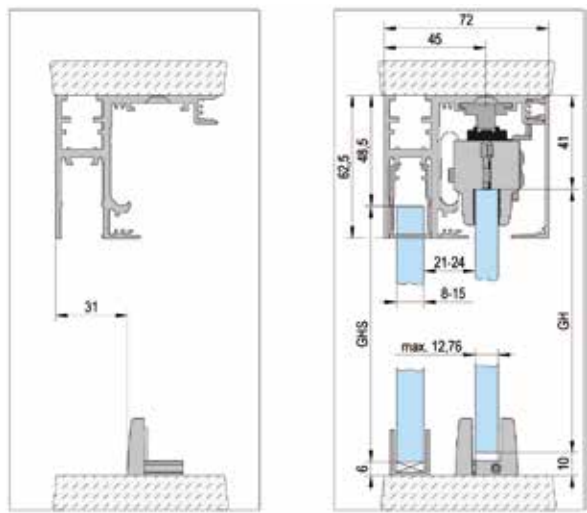

i Glass thickness door: toughened glass 8 - 12 mm, laminated safety glass 8.76 - 12.76 mm · glass thickness Fixed Sidelight: toughened glass 8 - 15 mm, laminated glass 8.76 - 15.52 mm · no glass processing required · the running track is pre-drilled. · minimum door width 790 mm · please order cover caps separately if required.

LENGTH · FINISH	ART. NO.
2000 mm · aluminium-coloured E6/EV1	BO 5762031N
3000 mm · aluminium-coloured E6/EV1	BO 5783031N
Mounting	Ceiling Mounting with Fixed Sidelight
Max. door weight	80 kg
Complete set	Yes



INCLUDED IN DELIVERY:

- | | |
|----|--|
| 1x | Top Track |
| 1x | Cover |
| 2x | Carriages |
| 2x | Damping Mechanisms |
| 1x | Bottom Guide |
| 1x | Snapframe standard for Fixed Sidelight Profile |



MasterTrack® FT
is also available in Stainless Steel Look E4/C31

Mounting
video



MasterTrack® FT 120/150



Bohle MasterTrack® FT Profile Set Wall Mounting

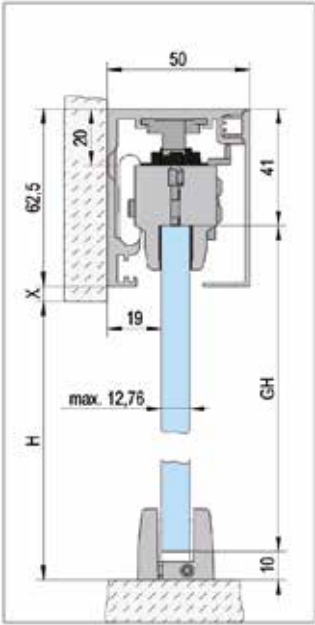

LENGTH · FINISH	ART. NO.
4000 mm · aluminium-coloured E6/EV1	BO 5704011



i The running track is pre-drilled. · please order cover caps separately if required.

INCLUDED IN DELIVERY:	
1x	Top Track
1x	Cover

Bohle MasterTrack® FT Profile Set Ceiling Mounting with Fixed Sidelight

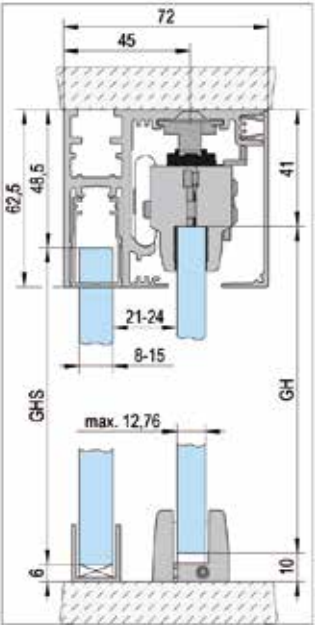

LENGTH · FINISH	ART. NO.
4000 mm · aluminium-coloured E6/EV1	BO 5704031N
6000 mm · aluminium-coloured E6/EV1	BO 5706031N



i The running track is pre-drilled. · please order cover caps separately if required.

INCLUDED IN DELIVERY:	
1x	Top Track
1x	Cover

Bohle MasterTrack® FT Carriage Set incl. damping mechanism



MAX. DOOR WEIGHT · DESCRIPTION	ART. NO.
80 kg · Minimum door width 790 mm	BO 5708000
120 kg · Minimum door width 905 mm	BO 5701200
150 kg · Minimum door width 905 mm	BO 5701500

❗ Glass thickness door: toughened glass 8 - 12 mm, laminated safety glass 8.76 - 12.76 mm · glass thickness Fixed Sidelight: toughened glass 8 - 15 mm, laminated glass 8.76 - 15.52 mm · no glass processing required · can be used to upgrade complete sets to double door systems.

INCLUDED IN DELIVERY: 2x Carriages 2x Damping Mechanisms 2x Triggers for Damping Mechanism

Bohle MasterTrack® FT Bottom Guide



FINISH	ART. NO.
aluminium-coloured E6/EV1	BO 5700005

INCLUDED IN DELIVERY: 1x Bottom Guide

Bohle MasterTrack® FT End Caps Set



FINISH	ART. NO.
aluminium-coloured E6/EV1	BO 5700011

INCLUDED IN DELIVERY: 2x Face Fixed Removable Cover Plates

Bohle MasterTrack® FT End Caps Set for Ceiling Mounting with Fixed Sidelight



FINISH

aluminium-coloured E6/EV1

ART. NO.

BO 5700031

INCLUDED IN DELIVERY: 2x Face Fixed Removable Cover Plates

Bohle MasterTrack® FT Accessory Set Synchro



ART. NO.

BO 5700020

i Suitable for all Bohle MasterTrack® FT systems · minimum wing widths for Synchro: for 60 kg min. 675 mm; for 80 kg min. 865 mm; for 120 kg min. 980 mm; for 150 kg min. 980 mm

INCLUDED IN DELIVERY: 1x Synchronous Converter Set

MasterTrack® BT

The special design of the MasterTrack® BT sliding door series is used when the installation requires more than simple ceiling or wall mounting. With MasterTrack® BT's modular system, there are no limits to the room design. With only a few individual components and thanks to the compact track in which the glass suspension is located below the carriage, single and multi-leaf doors as well as flush ceiling designs can be installed in no time at all.



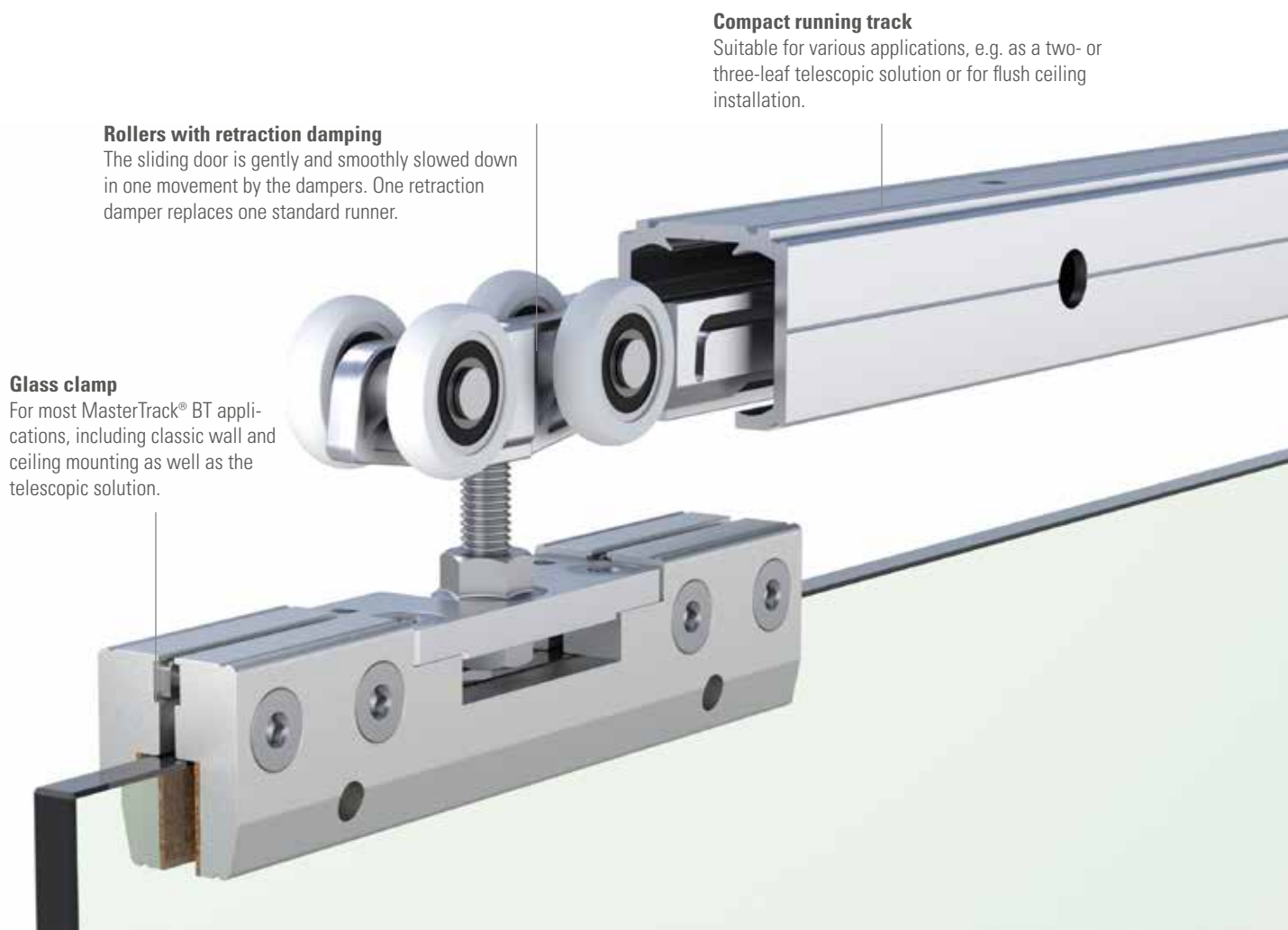

Compact running track

Suitable for various applications, e.g. as a two- or three-leaf telescopic solution or for flush ceiling installation.

Rollers with retraction damping

The sliding door is gently and smoothly slowed down in one movement by the dampers. One retraction damper replaces one standard runner.

Glass clamp

For most MasterTrack® BT applications, including classic wall and ceiling mounting as well as the telescopic solution.

MasterTrack® BT TELESCOPIC SOLUTION

Product highlights

- Simultaneous movement of double or triple leaf doors
- Floating floor guide
- Simple glass clamping mechanism for a secure hold
- Installation with or without fixed glazing
- Height adjustment ± 3 mm
- Smooth closing mechanism
- Safe anti-jump protection
- Optional metal damper with high-quality hydraulics and double-sided spring guide

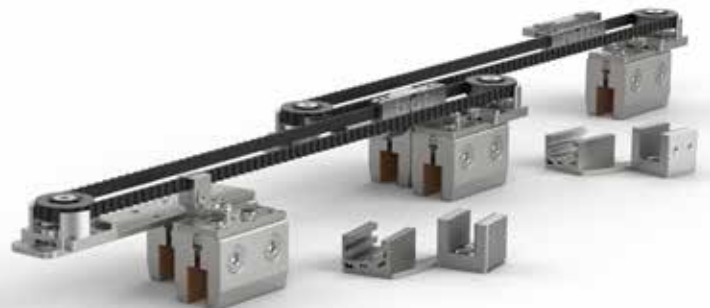

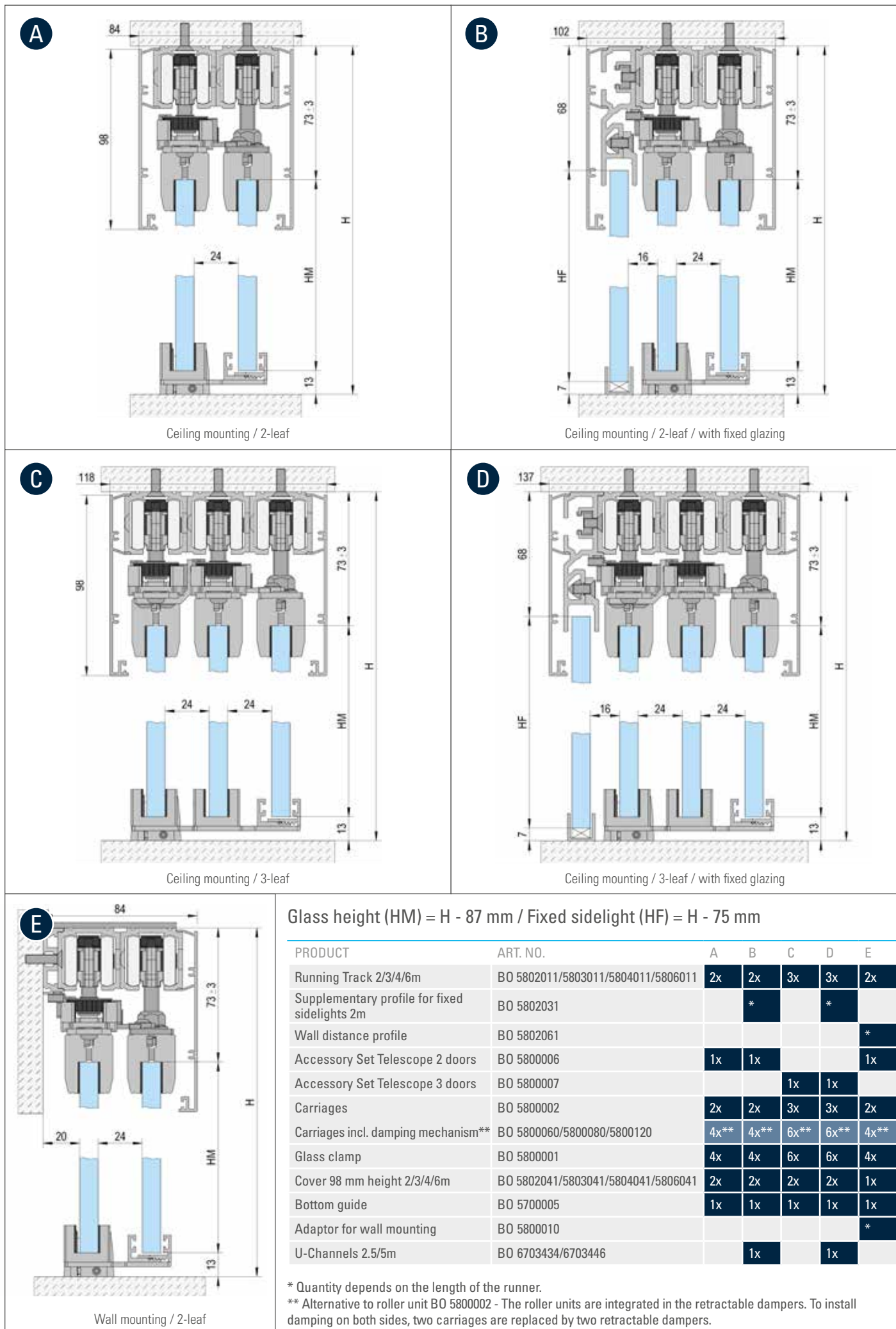

MasterTrack® BT Running Track



The running tracks of the MasterTrack® BT series are versatile in use, e.g. as telescopic application with two or three doors or for flush installation with the wall or ceiling. In addition, it can be used for classical wall or ceiling installations.

- Max. door weight 120 kg
- Suitable for all MasterTrack® BT applications

APPLICATION	LENGTH	FINISH	ART. NO.	SU
Standard / Telescopic	3000 mm	Aluminium-coloured E6 C0	BO 5803011	1x
Standard / Telescopic	4000 mm	Aluminium-coloured E6 C0	BO 5804011	1x
Standard / Telescopic	6000 mm	Aluminium-coloured E6 C0	BO 5806011	1x

MasterTrack® BT Cover



Cover for attachment to the MasterTrack® BT running track. Suitable for standard wall and ceiling mounting applications.

APPLICATION	LENGTH	HEIGHT	FINISH	ART. NO.	SU
Telescopic	3000 mm	98 mm	Aluminium-coloured E6 C0	BO 5803041	1x
Telescopic	4000 mm	98 mm	Aluminium-coloured E6 C0	BO 5804041	1x
Telescopic	6000 mm	98 mm	Aluminium-coloured E6 C0	BO 5806041	1x

MasterTrack® BT Supplementary Profile for Fixed Sidelights



This supplementary profile can be attached either to one or both sides of the MasterTrack® BT running track and enables inserting and stabilising fixed sidelights.

- Max. door weight 120 kg
- Glass thickness: 8 - 10 mm

APPLICATION	LENGTH	FINISH	ART. NO.	SU
Standard / Telescopic	2000 mm	Aluminium-coloured E6 C0	BO 5802031	1x

MasterTrack® BT Wall Distance Profile



The wall distance profile increases the distance between wall and glass by 8 mm.

- Max. door weight 120 kg

Available
on request

APPLICATION	LENGTH	FINISH	ART. NO.	SU
Standard / Telescopic	2000 mm	Aluminium-coloured E6 C0	BO 5802061	1x

MasterTrack® BT Carriages



High quality carriage for all MasterTrack® BT applications

- Max. door weight 120 kg

APPLICATION	ART. NO.	SU
Standard / Telescopic / Flush with the ceiling	BO 5800002	1x

MasterTrack® BT Glass Clamp



Glass clamp for most MasterTrack® BT applications, including classic wall and ceiling installations, and telescopic applications.

- Max. door weight 120 kg
- Glass thickness door: 8 - 12.76 mm

APPLICATION	ART. NO.	SU
Standard / Telescopic	BO 5800001	1x

MasterTrack® BT Carriages incl. Damping Mechanism



Optional metal dampers for all MasterTrack® BT applications.

Equipped with hydraulics and double-sided spring guidance. The sliding door is braked by the damper in one smooth, fluid movement. A self-closing damper replaces a standard carriage.

Minimum door width:

60 kg: cushioning on one side = 500mm / cushioning on both sides = 625mm

80 kg: cushioning on one side = 560mm / cushioning on both sides = 780mm

120 kg: cushioning on one side = 600mm / cushioning on both sides = 825mm

- High quality hydraulics
- Double-sided spring guidance
- A closing damper replaces a standard carriage

MAX. DOOR WEIGHT	ART. NO.	SU
80 kg	BO 5800080	1x
60 kg	BO 5800060	1x
120 kg	BO 5800120	1x

Available
on request

MasterTrack® BT Synchro Accessories Set



Optional synchronous deflection for simultaneous opening and closing of two door leaves. Suitable for the classic wall or ceiling mounting.

- Max. door weight 120 kg

Available
on request

APPLICATION	ART. NO.	SU
Standard / Flush with the ceiling	BO 5800005	1x

MasterTrack® BT Telescope Accessories Set



Accessory set for simultaneous opening and closing of two doors in telescopic alignment with two guides.

- Max. door weight 120 kg
- Glass thickness door: 8 - 10 mm

APPLICATION	ART. NO.	SU
Telescopic for two doors	BO 5800006	1x

Accessory set for simultaneous opening and closing of three doors in telescopic alignment with two guides

- Max. door weight 120 kg
- Glass thickness door: 8 - 10 mm

APPLICATION	ART. NO.	SU
Telescopic for three doors	BO 5800007	1x

MasterTrack® BT Adaptor for wall mounting



Used for mounting telescopic applications with two guides to a wall.

- Max. door weight 120 kg
- 5 adapters per metre necessary

APPLICATION	ART. NO.	SU
Telescopic	BO 5800010	1x

U-Channels 20 x 17



- Size 20 x 17 x 20 x 1.5 mm
- Glass thickness 10 - 12.76 mm
- Material Aluminium

LENGTH	FINISH	ART. NO.	SU
2500 mm	Aluminium-coloured anodised E6 EV1	BO 6703434	1x

SlideTec

SlideTec sliding door system is ideal for moving door(s) with a maximum weight of 150kg, smoothly and quietly along an elegant rail. Mounting to all glass walls or concrete/brick walls (or to both) are possible and makes SlideTec a solution for customised applications.



SlideTec Carriages



i For sliding tracks with a 25mm diameter • Ø26mm hole in glass (not Countersunk) for Door Glass

SlideTec Wall Track Clamp



i For sliding tracks with a 25mm diameter

SlideTec Track Clamp Glass Mounting



i For sliding tracks with a 25mm diameter • Ø26mm hole in glass (not Countersunk)

	ART. NO.
Sliding Door Roller	SA 5214101
Max. door weight	150 kg
Finish	brushed stainless steel

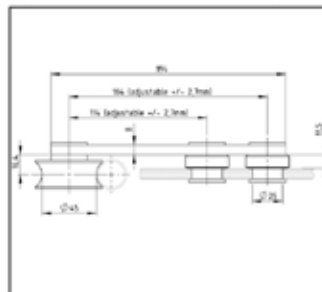

INCLUDED IN DELIVERY:

 $2x$

Carriages

	ART. NO.
Track Clamp for Wall Connection	SA 5214102
Finish	brushed stainless steel

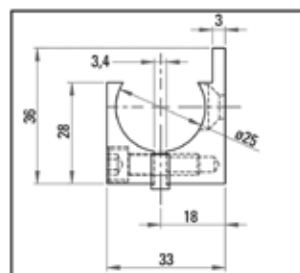

INCLUDED IN DELIVERY:

1x

Wall Track Clamp

	ART. NO.
Track Clamp for Glass Connection	SA 5214103
Finish	brushed stainless steel

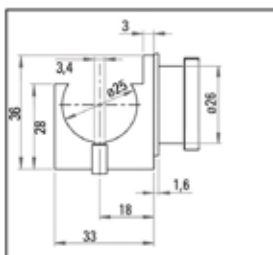

INCLUDED IN DELIVERY:

1x

Track Clamp for Glass Connection

SlideTec Door Stop on Track



i For sliding tracks with a 63/64" (25 mm) diameter

ART. NO.	
Door Stop on Track	SA 5214104
Finish	brushed stainless steel

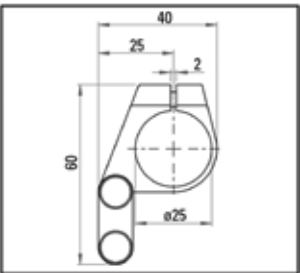

INCLUDED IN DELIVERY:	
2x	Door Stops on Track

SlideTec Bottom Guide



i Minimum space glass-to-floor 7 mm · adjustable · glass thickness toughened glass 8 -12 mm

ART. NO.	
Bottom Guide	SA 5214105
Finish	brushed stainless steel

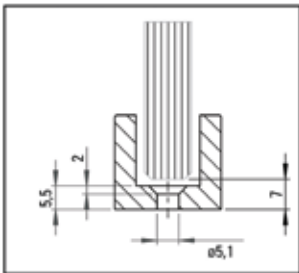
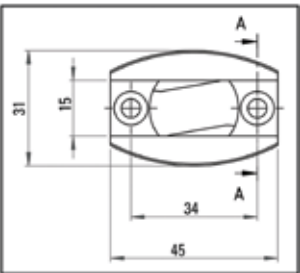

INCLUDED IN DELIVERY:	
1x	Bottom Guide

SlideTec Sliding Sleeve for Wall Mounting



i For sliding tracks with a 63/64" (25 mm) diameter

ART. NO.	
Sliding Sleeve	SA 5213794
Finish	brushed stainless steel

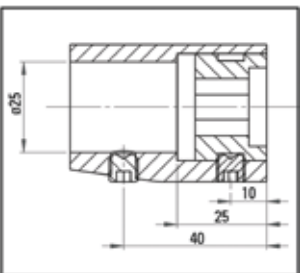

INCLUDED IN DELIVERY:	
1x	Sliding Sleeve for Wall Mounting

SlideTec End Covers for Sliding Track



ART. NO.	
SA 5213795	
Finish	brushed stainless steel

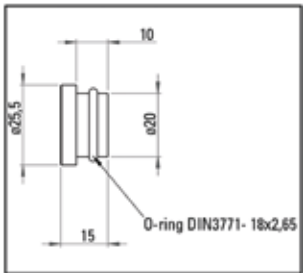

SlideTec Sliding Track Tube



LENGTH	ART. NO.
3000 mm	SA 5214107
Finish	brushed stainless steel

i End covers BO 5213795 · diameter 25 mm · material thickness 2 mm

INCLUDED IN DELIVERY:	
1x	Sliding Track Tube

Face spanner adjustable



ART. NO.	
SA 5214110	

i For point fixings, sliding and pivot door systems · Pin diameter 2.8 mm · Adjustable pin distance

Patch and Corner Fittings

Bohle Patch fittings for toughened glass are suitable for all standard types of all-glass assemblies. Any glass cut-outs or holes needed are uncomplicated and can be completed quickly and easily. Bohle attaches great importance to top quality products which ensure a long service life.



Self-closing Patch Fitting Standard Duty EN3



- ① Tested as per DIN 1154 with 500,000 cycles · for averagely frequented buildings · variable closing speeds · can be used with stopper · door width 750 - 1000 mm · for interior as well as exterior use · max. door height 2500 mm · adjustable zero position $\pm 4^\circ$ · glass thickness toughened glass 10-12mm
- adjustable closing speed $90^\circ - 15^\circ / 15^\circ - 0^\circ$ · ambient temperature $-20^\circ - +50^\circ\text{C}$ · not suitable for laminated safety glass

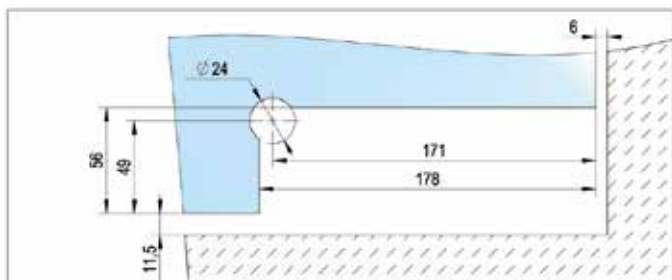

HOLD POSITION · MATERIAL · FINISH	ART. NO.
90° · stainless steel · brushed	SA 5214350
Max. door width	1000 mm
Max. door weight	100 kg
Closing force	EN3
Max. door opening angle	130°

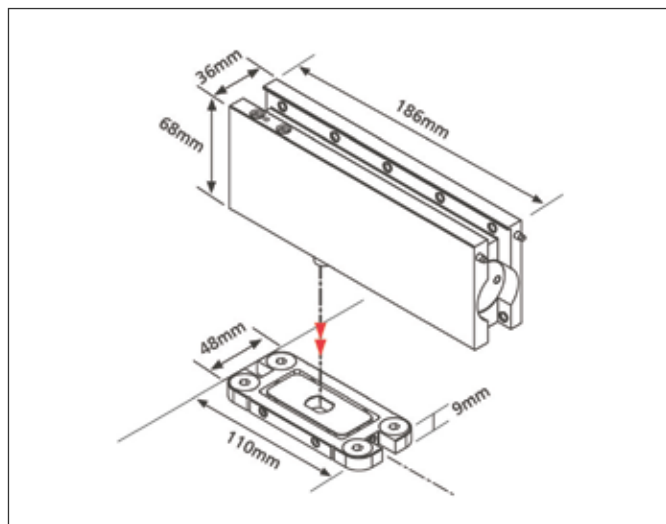

Floor Spring EN3



- ① Standard 10 mm plug-in flat conical floor spring axle included · plug-in flat conical floor spring axle not exchangeable · adjustable closing speed $90^\circ - 15^\circ / 15^\circ - 0^\circ$ · ambient temperature $-20^\circ - +45^\circ\text{C}$ · tested over 500,000 cycles according to EN 1154 · dimensions 305 x 108 x 40.5 mm · suitable for glass, wooden and aluminium doors

HOLD POSITION · MATERIAL · FINISH	ART. NO.
90° · stainless steel · brushed	SA 5214010
Max. door width	1000 mm
Max. door weight	100 kg
Closing force	EN3
Max. door opening angle	130°

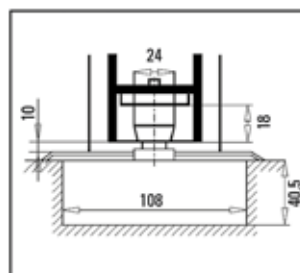

Patch Fitting bottom PT 10



i With insert for flat conical axle · adjustable pivot (55/65 mm) · glass thickness toughened glass 10, 12 mm

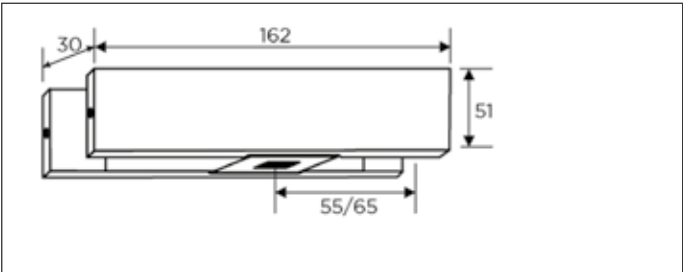

FINISH	ART. NO.
brushed	SA 5214266
Max. door width	1200 mm
Max. door weight	100 kg
Material	stainless steel

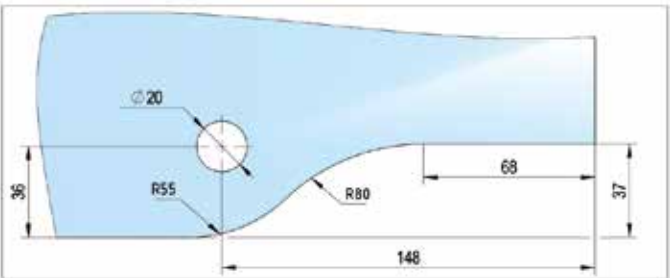
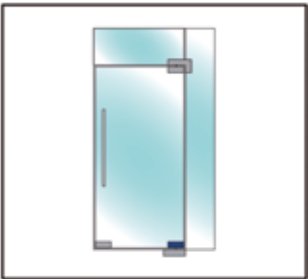

Patch Fitting top PT20



i With plastic bushing for 15 mm diameter pin · adjustable pivot (55/65 mm) · glass thickness toughened glass 10, 12 mm

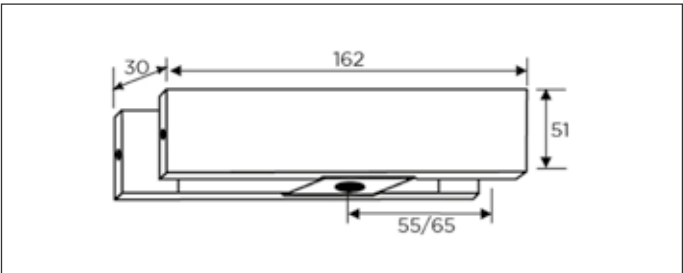

FINISH	ART. NO.
brushed	SA 5214264
Max. door width	1200 mm
Max. door weight	100 kg
Material	stainless steel

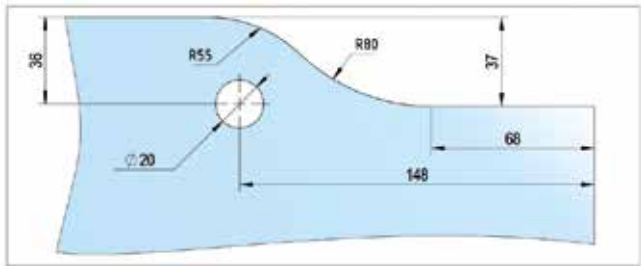
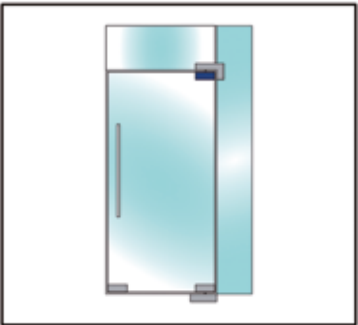

Top Pivot PT 24



Pin diameter 15 mm

FINISH	ART. NO.
brushed	SA 5214287

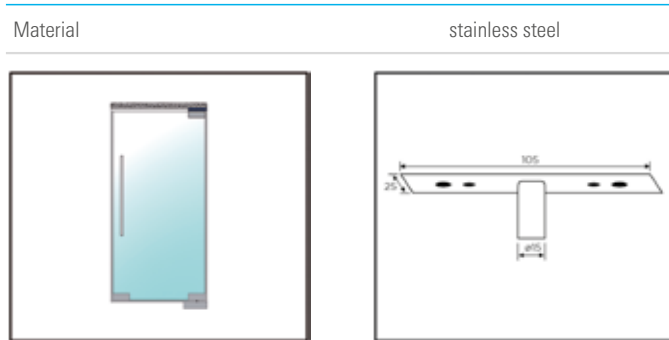

Floor Pivot PT11



Important: Free pivot. Use floor spring if self closing door is required.

FINISH	ART. NO.
brushed	SA 5214288

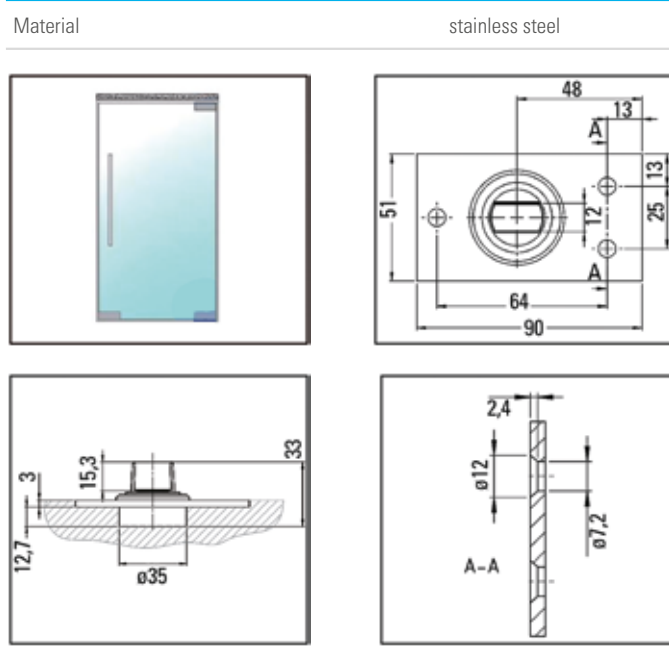

Overpanel Fitting with Screw-on plate PT30.3



FINISH	ART. NO.
brushed	SA 5214267
Material	stainless steel

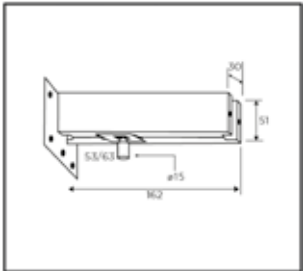

With pin $\varnothing 15$ mm · adjustable pivot (55/65 mm) · glass thickness toughened glass 10, 12 mm

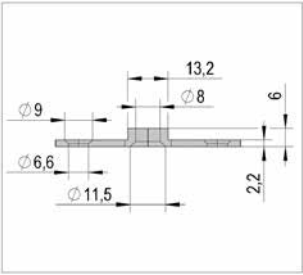
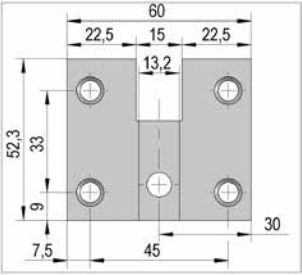
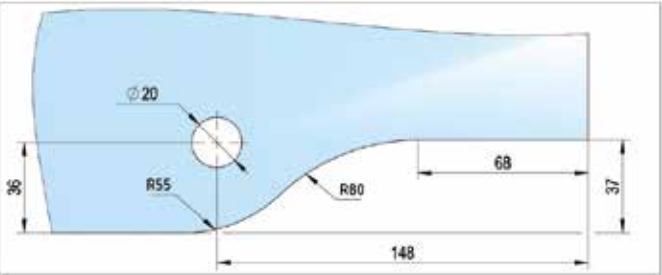

Angled Overpanel Fitting PT40



FINISH	ART. NO.
brushed	SA 5214263
Material	stainless steel

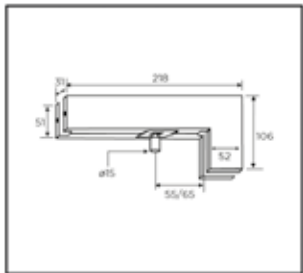
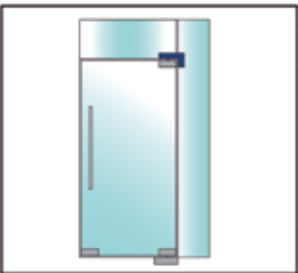

With pin $\varnothing 15$ mm · adjustable pivot (55/65 mm) · glass thickness toughened glass 10, 12 mm

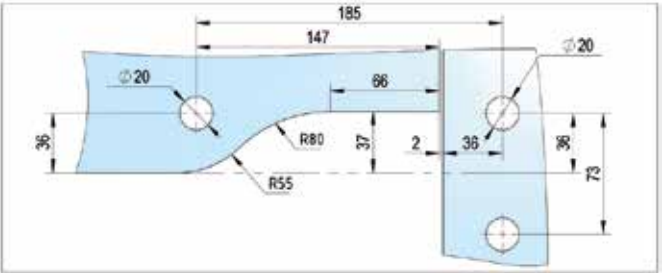
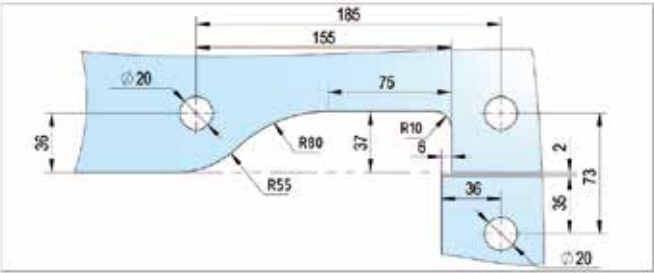

Angled Overpanel Fitting left with one side bracing PT41



With pin $\varnothing 15$ mm · adjustable pivot (55/65 mm) · glass thickness toughened glass 10, 12 mm

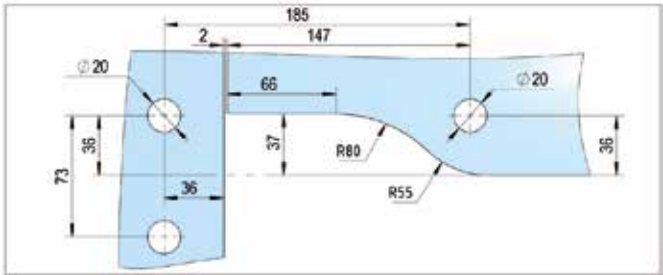

FINISH	ART. NO.
brushed	SA 5214268
Material	stainless steel

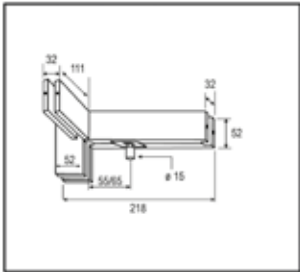
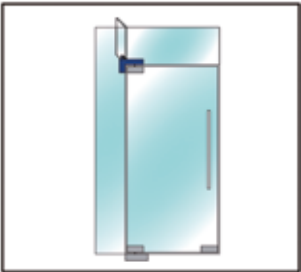

Angled Overpanel Fitting right with one side bracing PT41



With pin $\varnothing 15$ mm · adjustable pivot (55/65 mm) · glass thickness toughened glass 10, 12 mm

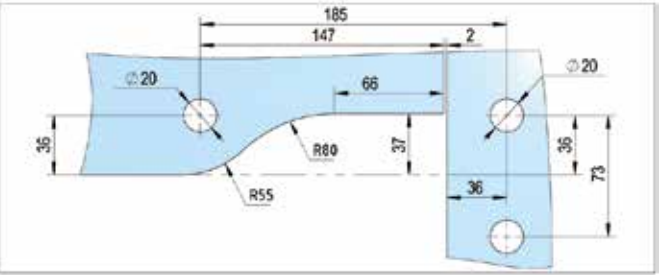

FINISH	ART. NO.
brushed	SA 5214269
Material	stainless steel

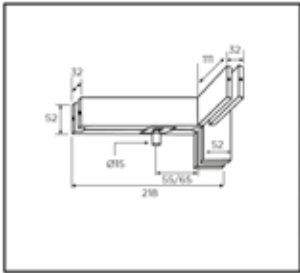
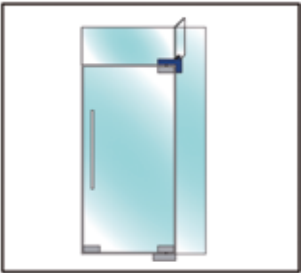

Overpanel Fitting PT51



i With pin ø15 mm · adjustable pivot (55/65 mm) · glass thickness toughened glass 10, 12 mm

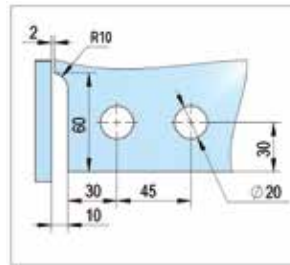
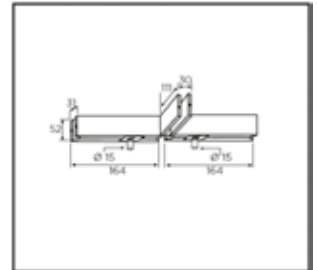
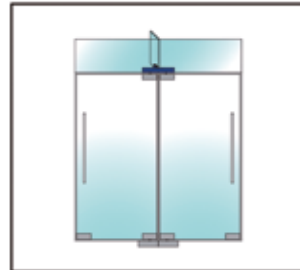
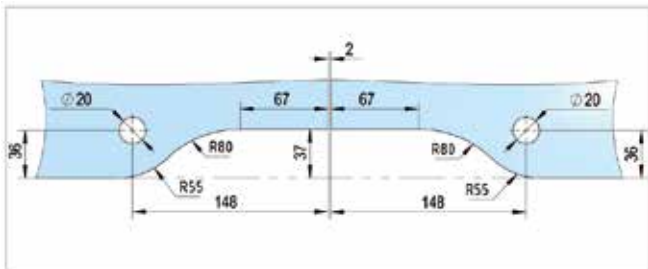

Corner Clamp PT60



i Glass thickness toughened glass 10, 12 mm

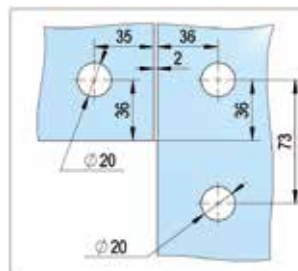
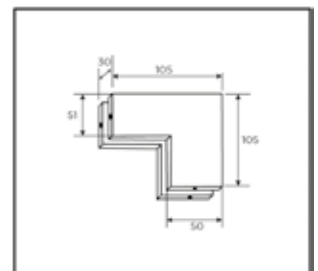
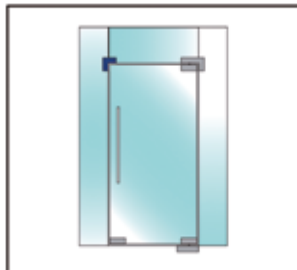

FINISH	ART. NO.
brushed	SA 5214270
Material	stainless steel

FINISH	ART. NO.
brushed	SA 5214271
Material	stainless steel

Bohle Patch PT81 glass connector with one-side bracing



FINISH	ART. NO.
brushed	SA 5214276
Material	stainless steel

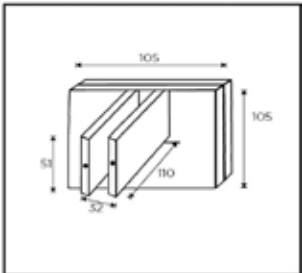
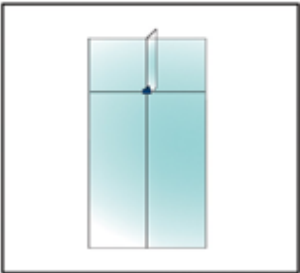

1 Glass thickness toughened glass 10, 12 mm

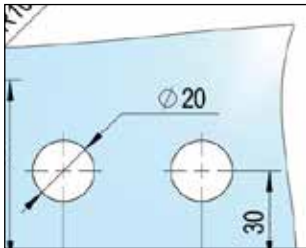
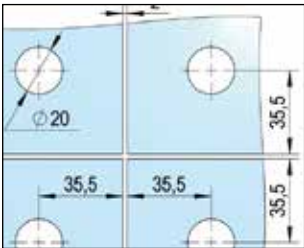

Overpanel Connector with one side bracing PT71



FINISH	ART. NO.
brushed	SA 5214277
Material	stainless steel

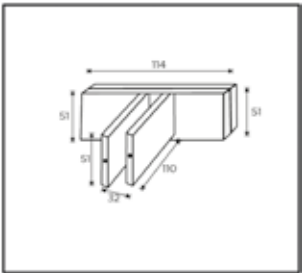
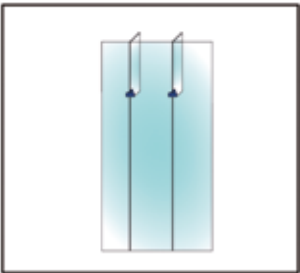

1 Glass thickness toughened glass 10, 12 mm

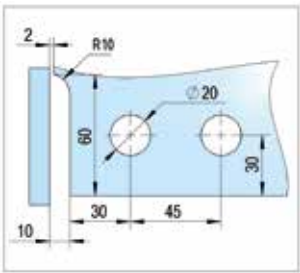
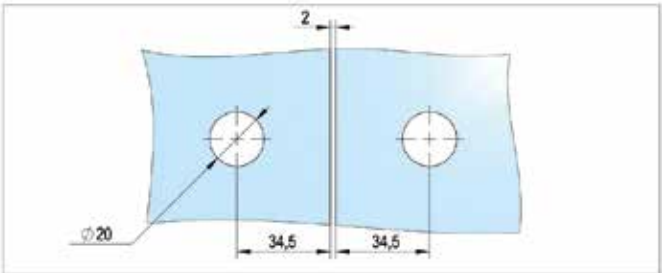

Overpanel Connector with stopper PT72



i Glass thickness toughened glass 10, 12 mm

FINISH	ART. NO.
brushed	SA 5214260
Material	stainless steel

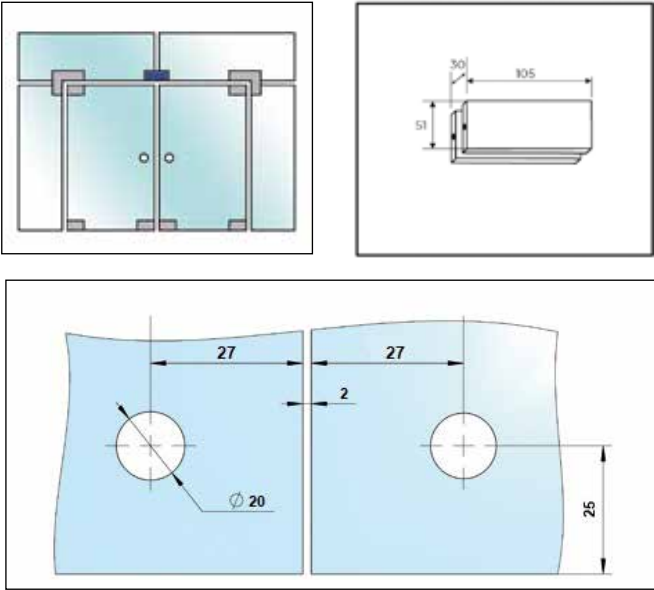

Glass Connector PT 80



i Glass thickness toughened glass 10, 12 mm

FINISH	ART. NO.
brushed	SA 5214275
Material	stainless steel

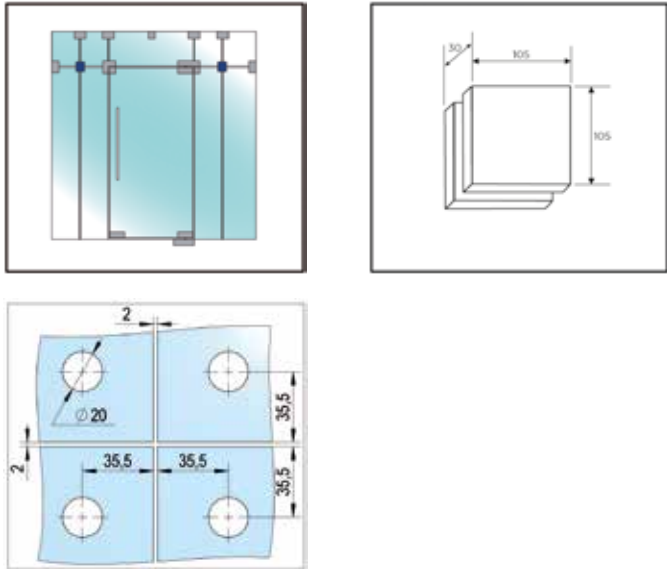

Glass/wall Connector PT90



1 Glass thickness toughened glass 10, 12 mm

FINISH	ART. NO.
brushed	SA 5214278
Material	
stainless steel	

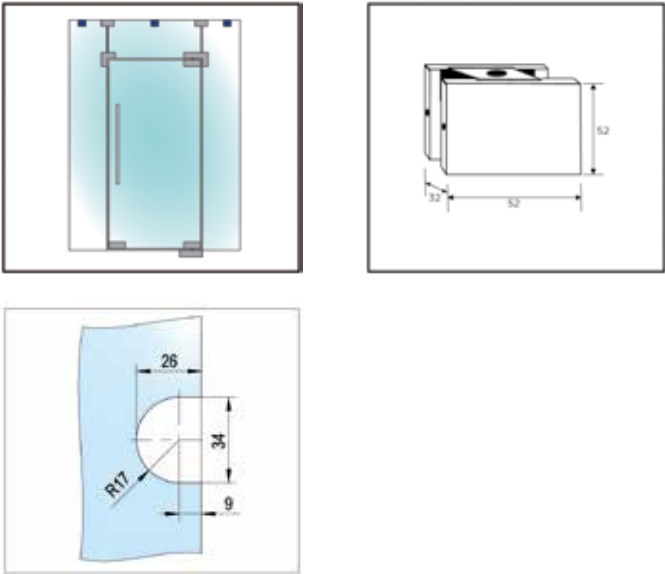

Glass Door Locks

Patch Corner Lock US10



1 Euro profile cylinder (individual key) 60 mm (30/30) · incl. 4 keys · glass thickness toughened glass 10, 12 mm · with Round bolt

FINISH	ART. NO.
brushed	SA 5214280
Material	
stainless steel	

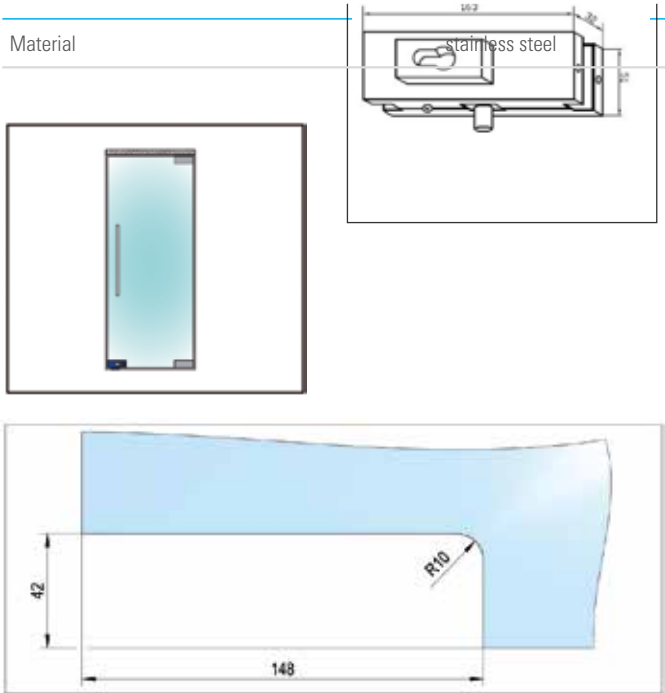

Middle Lock with flat bolt US20



i Euro profile cylinder (individual key) 60 mm (30/30) · incl. 4 keys · when used as a centre lock on double doors, one door must be used as a slave door · glass thickness toughened glass 10, 12 mm

FINISH	ART. NO.
brushed	SA 5214281
Material	stainless steel

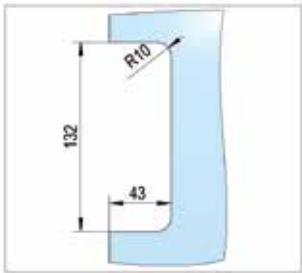
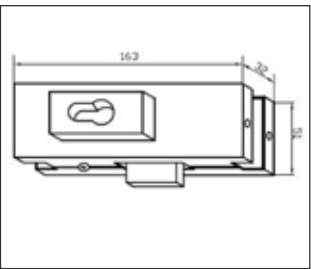
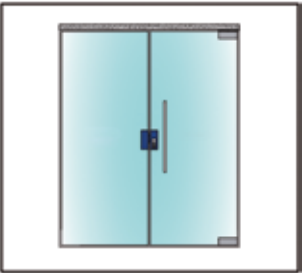

Keep GK50



i Glass thickness toughened glass 10, 12 mm · when used as a centre lock on double doors, one door must be used as a slave door.

FINISH	ART. NO.
brushed	SA 5214282
Material	stainless steel

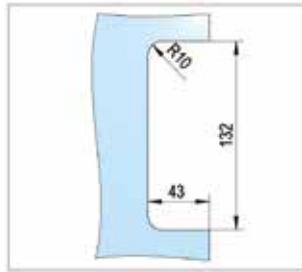
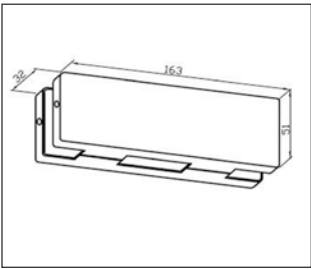
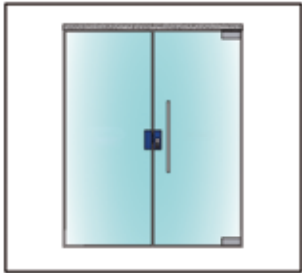

Middle Lock with round bolt and one side rotating twist lock



FINISH	ART. NO.
brushed	BO 5214283
Material	
stainless steel	

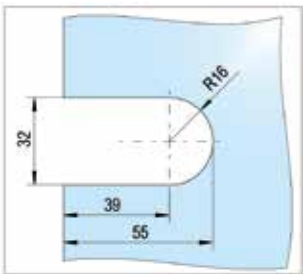

❗ When used as a centre lock on double doors, one door must be used as a slave door. · glass thickness toughened glass 10, 12 mm · size 53 x 64 mm · single throw / 17 mm bolt projection

Keep for BO 5214283 Middle Lock



FINISH	ART. NO.
brushed	BO 5214284
Material	
stainless steel	

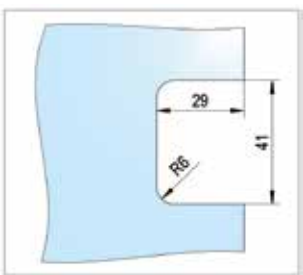
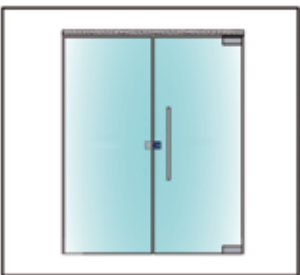

❗ When used as a centre lock on double doors, one door must be used as a slave door. · glass thickness toughened glass 10, 12 mm · size 53 x 40 mm

Curve Shape Lock



i incl. profile cylinder with thumb turn, 4 keys, Stricker Plate for Single door and Keep for Double door or to fixed sidelight, Nickel plated brass latch bolt, single throw, 19 mm bolt projection, glass thickness toughened glass 10-12mm

FINISH	ART. NO.
brushed	SA 5206810
Material	cast steel base with stainless steel covers
Finish	brushed

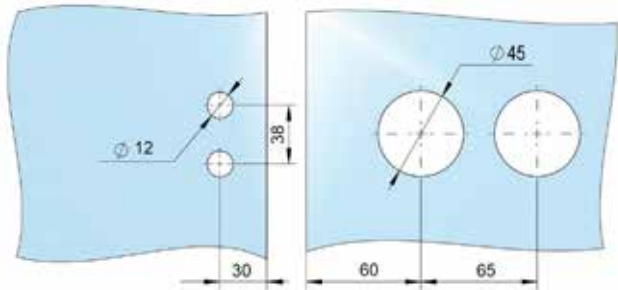

Square Shape Lock



i incl. profile cylinder with thumb turn, 4 keys and Stricker Plate for Single doors, single throw, 19 mm bolt projection, glass thickness toughened glass 10-12mm

FINISH	ART. NO.
brushed	SA 5206836
Material	cast steel base with stainless steel covers
Finish	brushed

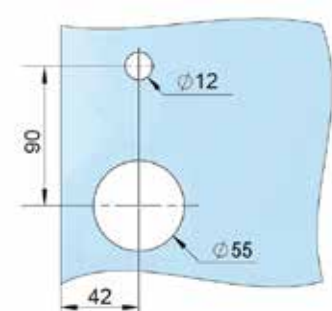

Square Shape Lock



i incl. profile cylinder with thumb turn, 4 keys and Keep for Double doors, single throw, 19 mm bolt projection, glass thickness toughened glass 10-12mm

FINISH	ART. NO.
brushed	SA 5206838
Material	cast steel base with stainless steel covers
Finish	brushed

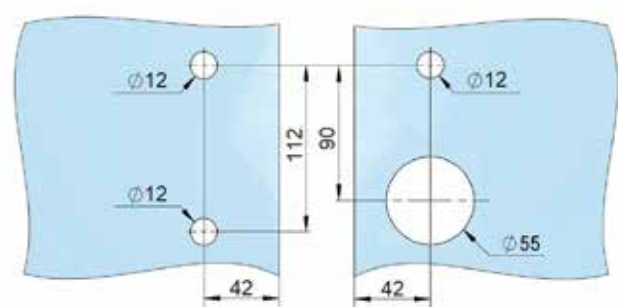

Hook Lock with Keep and Hook Bolt



i When used as a centre lock on double doors, one door must be used as a slave door. · no glass cutouts or drill holes required, clamp-on function · glass thickness toughened glass 10, 12 mm

FINISH	ART. NO.
brushed	SA 5214285
Material	stainless steel

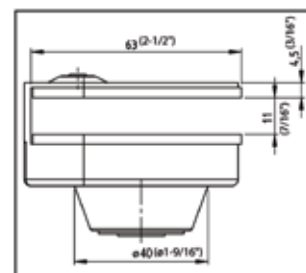
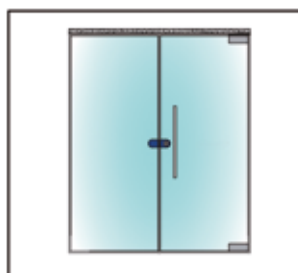

Hook Lock with Keep and Hook Bolt



i When used as a centre lock on double doors, one door must be used as a slave door. · no glass cutouts or drill holes required, clamp-on function · glass thickness toughened glass 10, 12 mm

FINISH	ART. NO.
brushed	SA 5214286
Material	stainless steel

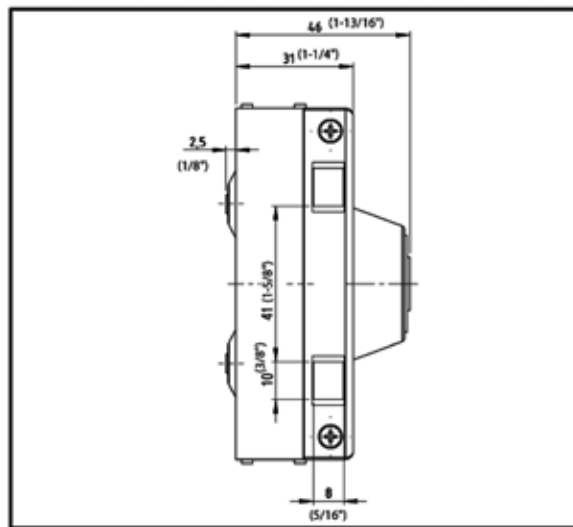
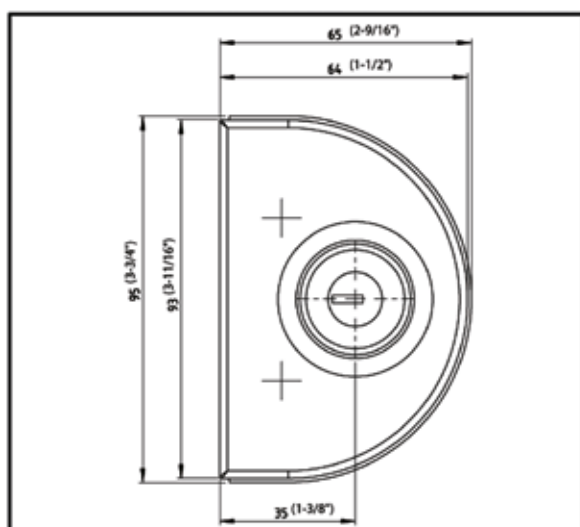
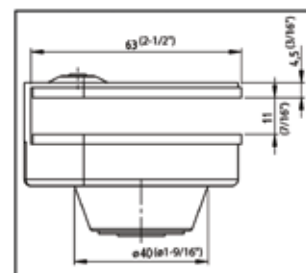

Glass Door Hinges

Self Centering Hinge glass/glass 180°



i Glass thickness toughened 8 - 12 mm, Hold open position 90°, Not suitable for one side opening, Door type - Swinging, Mounting - glass/glass 180°, max. door height - 2200 mm

FINISH	ART. NO.
brushed	SA 5210380
Max. door width	900 mm
Max. door weight	50 kg/pair
Material	stainless steel

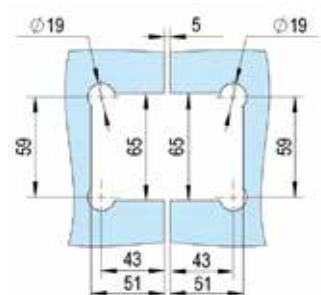

Self Centering Hinge glass/wall 90°



i Glass thickness toughened 8 - 12 mm, Hold open position 90°, Not suitable for one side opening, Door type - Swinging, Mounting - glass/glass 180°, max. door height - 2200 mm

FINISH	ART. NO.
brushed	SA 5210381
Max. door width	900 mm
Max. door weight	50 kg/pair
Material	stainless steel

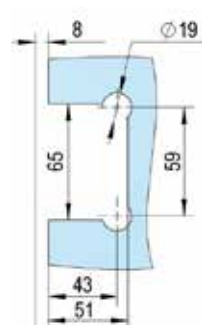

Glass Door Handles



Handle type ø 19 mm

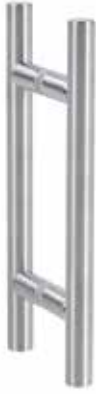

① Drill hole in glass ø12 mm · Glass processing Yes

LENGTH (L) · C-C · FINISH	ART. NO.
300 mm · 200 mm · brushed	SA 5213749
Width (ø)	19 mm
Depth (H)	52 mm
Material	stainless steel
Glass thickness	10 - 15 mm

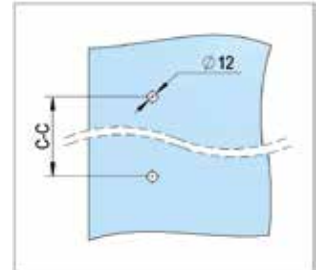
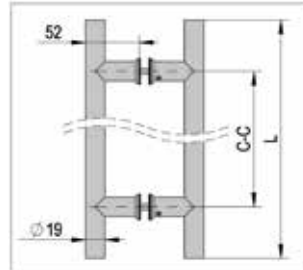

Handle type ø 25 mm



① Drill hole in glass ø14 mm · Glass processing Yes

LENGTH (L) · C-C · FINISH	ART. NO.
400 mm · 300 mm · brushed	SA 5113701
500 mm · 400 mm · brushed	SA 5113702
600 mm · 400 mm · brushed	SA 5113703
Width (ø)	25 mm
Depth (H)	65 mm
Material	stainless steel
Glass thickness	10 - 15 mm

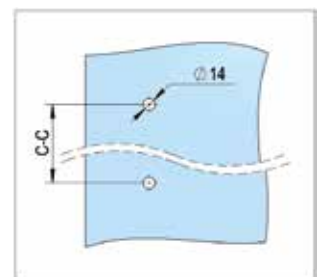
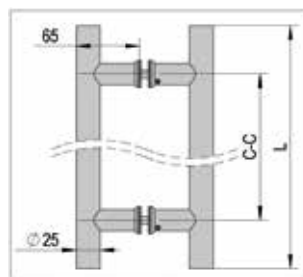

Handle type ø 38 mm



① Drill hole in glass ø14 mm hole · Glass processing Yes

LENGTH (L) · C-C · FINISH	ART. NO.
600 mm · 400 mm · brushed	SA 5113714
800 mm · 500 mm · brushed	SA 5113715

Width (ø)	38 mm
Depth (H)	72 mm
Material	stainless steel
Glass thickness	10 - 15 mm

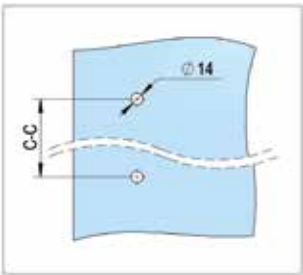
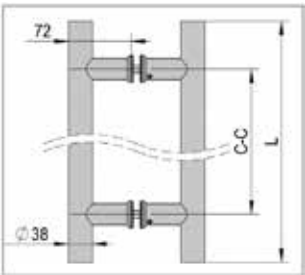

Handle Type Square



① Drill hole in glass ø14 mm · Glass processing Yes

LENGTH (L) · C-C · FINISH · SIZE	ART. NO.
600 mm · 450 mm · brushed · 15 x 30 mm	SA 5213820
600 mm · 400 mm · brushed · 25 x 38 mm	SA 5213821
800 mm · 600 mm · brushed · 25 x 38 mm	SA 5213822

Depth (H)	65 mm
Material	stainless steel
Glass thickness	10 - 15 mm

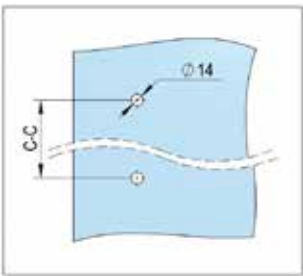
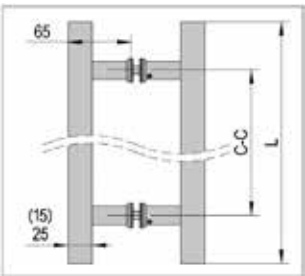

Handle for All-Glass Doors



LENGTH (L) · C-C · FINISH	ART. NO.
600 mm · 400 mm · brushed	SA 5213829
Width (ø)	32 mm
Depth (H)	72 mm
Material	stainless steel
Glass thickness	10 - 15 mm

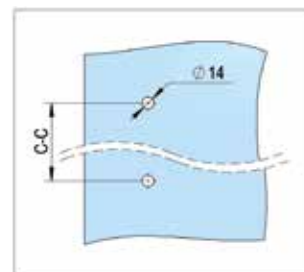
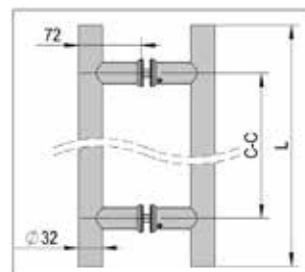

❗ Drill hole in glass ø14 mm · Glass processing Yes

Handle type ø 32 mm



LENGTH (L) · C-C · FINISH	ART. NO.
600 mm · 400 mm · brushed	SA 5213790
Width (ø)	32 mm
Depth (H)	90 mm
Material	stainless steel
Glass thickness	10 - 15 mm

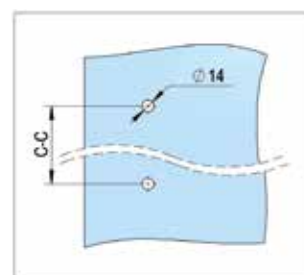
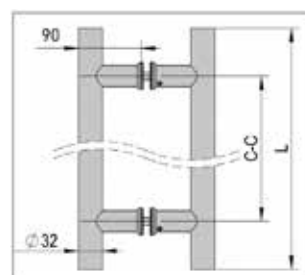

❗ Handle is offset · Drill hole in glass ø14 mm · Glass processing Yes

Lockable Rod Handle



LENGTH (L) · SIZE · C-C · FINISH	ART. NO.
1500 mm · 28 x 38 · 1125 mm · brushed	SA 5213350
1500 mm · Ø 38 · 1125 mm · brushed	SA 5213351

Depth (H)	83 mm
Material	stainless steel
Glass thickness	10 - 15 mm

i Incl. 30/160 mm Cylinder lock with thumb turn and dust socket · Glass processing Yes

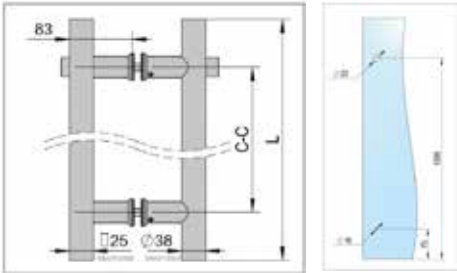

Flush Handles



Flush Handle round open



MATERIAL · FINISH · GLASS THICKNESS	ART. NO.
stainless steel · brushed · 8 - 12 mm	SA 5214216N
Width (ø)	65 mm
Depth (H)	7 mm

1 Drill hole in glass ø52 mm

Flush Handle round closed



MATERIAL · FINISH · GLASS THICKNESS	ART. NO.
stainless steel · brushed · 8 - 12 mm	SA 5214217N
Width (ø)	65 mm
Depth (H)	7 mm

1 Drill hole in glass ø60 mm

Flush Handle round closed self-adhesive



MATERIAL · FINISH	ART. NO.
stainless steel · brushed	BO 5205105
Width	64 mm
Depth (H)	8 mm

1 Sold in pair

Wall Connecting Profiles



Clamp-on Frame Profile two-piece

Our top-selling clamp-on profile for wall connection ensures quick and cost-efficient mounting. The glass pane is held safely in place with high quality sealing strips; additional sealing with silicone is not necessary. The profiles come pre-drilled. Thanks to a two-part construction with different ratchet positions and sealing strips, glass panes ranging from 8 to 21.52 mm can be installed. The relevant cover caps provide a neat finish. The clamp-on profile for wall connection is available with aluminium coloured, stainless steel look anodised and mill finished aluminium finishes.

Clamp-on Frame Profile two-piece



i No glass processing required · easy mounting · three ratchet positions for fixing glass 8 up to 21.52 mm. · the profiles are pre-drilled. · the profile width varies according to the ratchet position (ratchet position 1: glass thickness 8 - 10.76 mm, width 24 mm; ratchet position 2: glass thickness 12 - 13.52 mm, width 28 mm; ratchet position 3: glass thickness 16.76 - 21.52 mm, width 33 mm) · note: You will find gaskets to suit the respective glass thickness in the mounting instructions. · glass thickness 8 - 21.52 mm

FINISH · LENGTH	ART. NO.
aluminium-coloured anodised E6/EV1 · 5000 mm	BO 5201752

Material	aluminium
----------	-----------

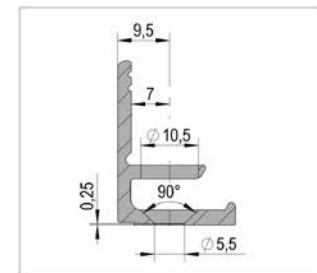
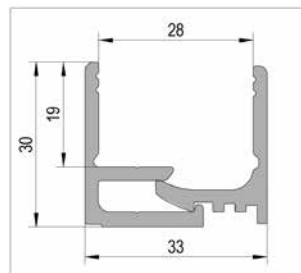
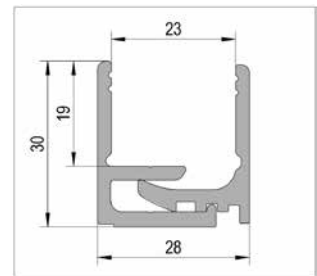
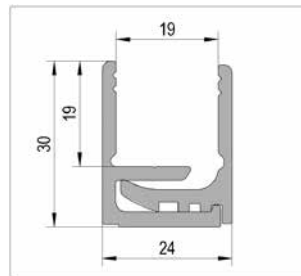

U-Channels for two-piece clamp-on profile



FINISH · GLASS THICKNESS	ART. NO.
aluminium-coloured anodised E6/C0 · 8 - 10,76 mm	BO 5201640
aluminium-coloured anodised E6/C0 · 12 - 13,52 mm	BO 5201642

Size	30 x 23 x 2,5 mm
Material	aluminium
Length	5000 mm

Gasket for Clamp-on Frame Profile two-piece transparent



SIZE	ART. NO.
3 mm	BO 5201713N
4 mm	BO 5201714N
5 mm	BO 5201715N
Material	PVC
Length	10000 mm

i The high quality sealing strips enable the safe clamping of glass panes in the two-part clamp-on profile for wall connection · suitable for two-piece clamp on frame profiles BO 5201750-54

Glass Connection Profiles

The connection profiles are the perfect solution for clean and unobtrusive sealing of the joints in glass partition walls. They ensure a professional finish for each project.

Glass Connection Profiles 180°



- Significant time and cost saving as compared to sealing with silicone
- high-quality connection product for a design-friendly and clear design
- interior application, e.g. for glass partition walls and shower cubicles
- suitable for ESG 10 mm and 12 mm, as well as for VSG 10.76 mm and 12.76 mm
- balancing and elastic properties
- permanently high final strength
- self-adhesive
- notes: the glass should have a flat, polished edge and a 45° mitre in order to create ideal conditions for application.

GLASS THICKNESS	ART. NO.
toughened glass 10 mm, laminated glass 10.76 mm	BO 5201720
toughened glass 12 mm, laminated glass 12.76 mm	BO 5201726
Length	3000 mm
Finish	transparent
Material	PETG

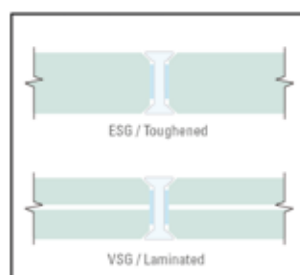

Glass Connection Profiles 3-Way



- Significant time and cost saving as compared to sealing with silicone
- high-quality connection product for a design-friendly and clear design
- interior application, e.g. for glass partition walls and shower cubicles
- suitable for ESG 10 mm and 12 mm, as well as for VSG 10.76 mm and 12.76 mm
- balancing and elastic properties
- permanently high final strength
- self-adhesive
- notes: the glass should have a flat, polished edge and a 45° mitre in order to create ideal conditions for application.

GLASS THICKNESS	ART. NO.
toughened glass 10 mm, laminated glass 10.76 mm	BO 5201721
Length	3000 mm
Finish	transparent
Material	PETG

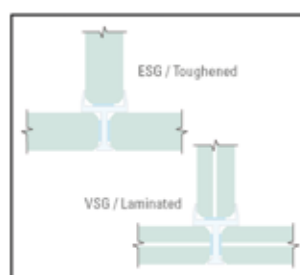

Glass Connection Profiles H-Bar



i Significant time and cost saving as compared to sealing with silicone
· high-quality connection product for a design-friendly and clear design
· interior application, e.g. for glass partition walls and shower cubicles
· suitable for ESG 10 mm and 12 mm, as well as for VSG 10.76 mm and 12.76 mm
· balancing and elastic properties
· permanently high final strength
· self-adhesive
· notes: the glass should have a flat, polished edge and a 45° mitre in order to create ideal conditions for application.

GLASS THICKNESS	ART. NO.
toughened glass 10 mm, laminated glass 10.76 mm	BO 5201725
toughened glass 12 mm, laminated glass 12.76 mm	BO 5201731
Length	3000 mm
Finish	transparent
Material	PETG

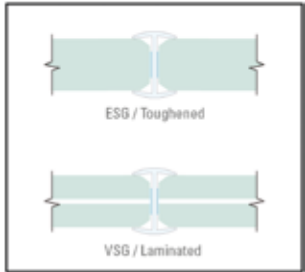

Duplocoll®

Bohle Duplocoll® double sided adhesive tape

Duplocoll® is the ideal adhesive tape for sealing glass joints when transparency is especially important, e.g. for all-glass partition walls, in furniture construction or for shower cubicles. The bonds are almost invisible due to the fact that the light refraction index of the tape is similar to that of glass.



i Significant time and cost saving as compared to sealing with silicone
· by sealing the edges of the adhesive tape, Duplocoll® becomes dry after adhesion and resistant to external influences · antimicrobial effect - inhibits growth of microorganisms · resistant to chemicals and softeners
· very good initial tack, lasting ultimate bonding strength · resistant to ageing and UV radiation, economic, high quality and does not affect the external appearance of the construction · clean and very easy application process, especially with optional applicator (BO 5207939N) · for different materials, such as wood, aluminium, plastic, ceramic or glass · versatile application possibilities - Duplocoll® not only bonds, but also seals, damps, isolates and protects. · optimum compensation of tolerances and tensions
· joints are closed in a way that a sealed system is created. · also suitable for rough surfaces: The viscoelastic adhesive film distributes evenly across rough surfaces. · noise-tested adhesive tape - Duplocoll® closes the glue joint between the glass pane so tightly that sound insulation is preserved verifiably. · thickness 3 mm · max. allowable continuous temperature -40°C - +100°C

GLASS THICKNESS · WIDTH	ART. NO.
toughened glass 8 mm, laminated glass 8.76 mm · 5 mm	BO 5207936
toughened glass 10 mm, laminated glass 10.76 mm · 7 mm	BO 5207938
toughened glass 12 mm, laminated glass 12.76 mm · 9 mm	BO 5207935

Length	12 m
Finish	transparent



Note

We recommend seaming tool BO 650.30A as auxiliary tools for joining the glass panes



Bohle Duplocoll® Applicator



GLASS THICKNESS	ART. NO.
toughened glass 8 -10 mm	BO 5207939
toughened glass 12 mm, laminated glass 10.76 - 12.76 mm	BO 5207946

i Please use the corresponding applicator to ensure simple and precise application on the glass edge. · for 10 and 12 mm glass, please use the suitable inlay BO 5207948 together with the applicator BO 5207939N. · for 8, 8.76 and 10 mm glass, please use the suitable inlay BO 5207947 together with the applicator BO 5207946N. · for 17.52 mm glass, please use the suitable inlay BO 5207949 together with the applicator BO 5207946N.

NOTE:

Images, technical drawings and specifications in this catalogue are for reference only and might differ from the product supplied.



Bohle Glass Equipment (Pty) Ltd

Unit 3, Graphite Industrial Park
Fabriek Street, Strijdom Park 2125
Gauteng

T +27 11 792-6430 · F +27 11 793-5634

info@bohle.co.za · www.bohle.com

 Bohle